

NOTE
CONTRACTOR TO PROVIDE ALTERNATIVE PRICE WHICH EXCLUDES COMPACTION OF EXISTING SUB-GRADE BUT INCLUDES 2nd LAYER OF A393 BOTTOM MAT REINFORCEMENT TO R.C. SLAB.

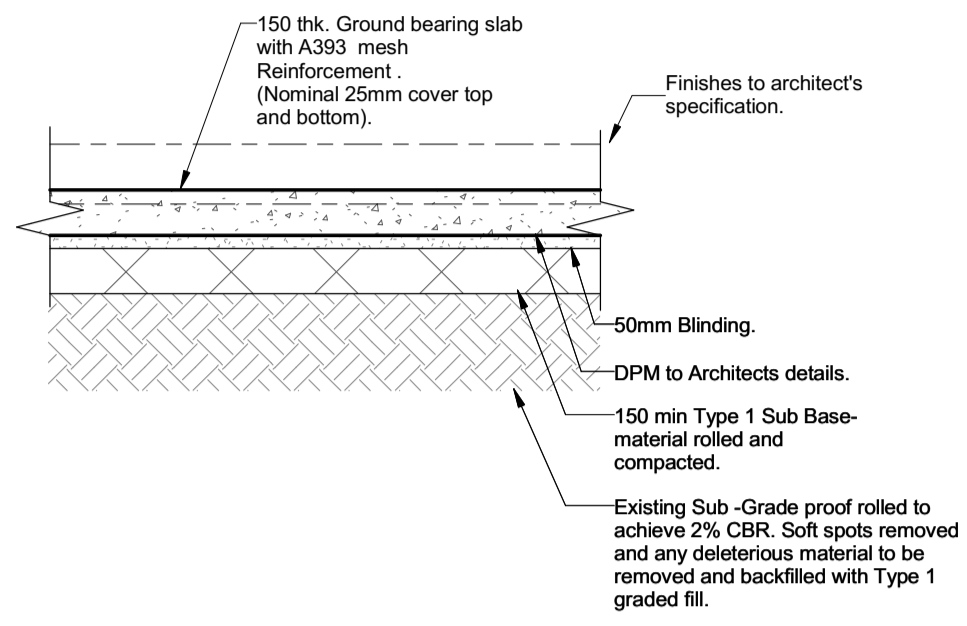

Detail 1 Typical Internal Ground Bearing Slab

scale 1:25

NOTE
CONTRACTOR TO PROVIDE ALTERNATIVE PRICE WHICH EXCLUDES COMPACTION OF EXISTING SUB-GRADE BUT INCLUDES 2nd LAYER OF A393 BOTTOM MAT REINFORCEMENT TO R.C. SLAB.

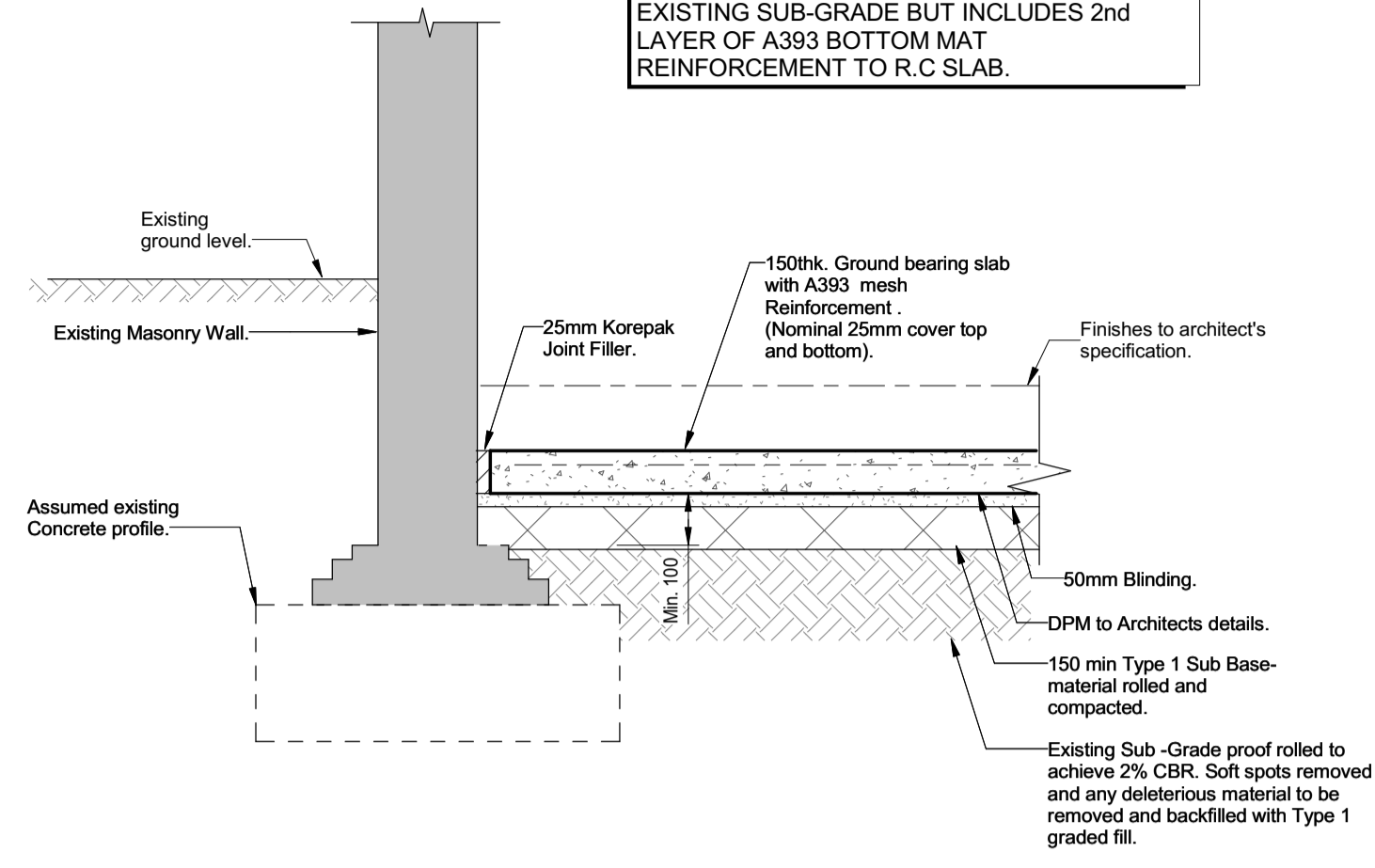

Detail 2 Typical Ground Bearing edge Detail

scale 1:25

NOTE
CONTRACTOR TO PROVIDE ALTERNATIVE PRICE WHICH EXCLUDES COMPACTION OF EXISTING SUB-GRADE BUT INCLUDES 2nd LAYER OF A393 BOTTOM MAT REINFORCEMENT TO R.C. SLAB.

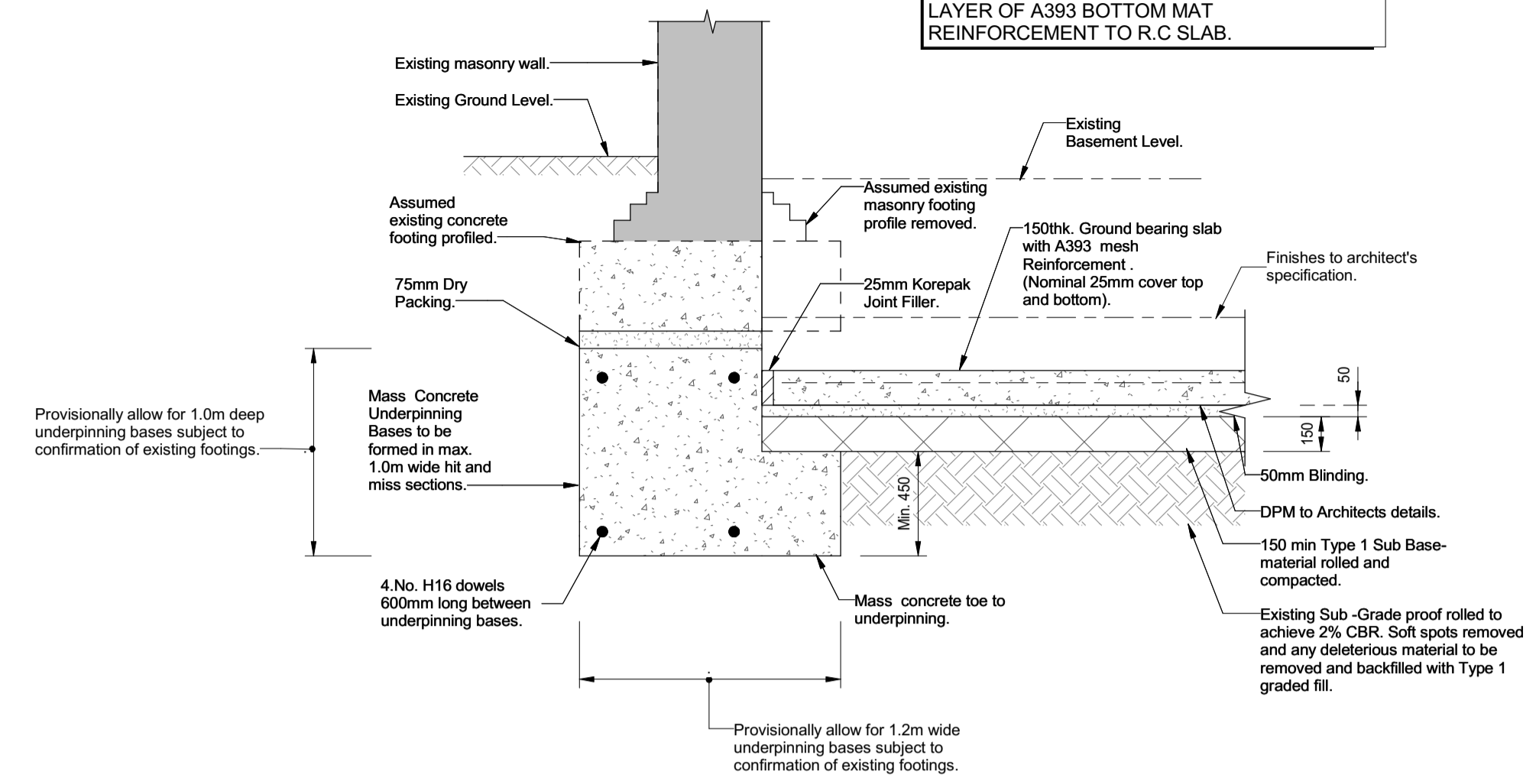

Detail 3 Typical Underpinning Detail

scale 1:25

General Notes

- Drawings shall be referred to for structural work only unless otherwise stated and read in conjunction with Architect's, Service Engineer's and Sub-Contractor's drawings.
- The Contractor shall check all levels and dimensions, any errors or omissions are to be reported at once to the Engineer.

NOTE
S.S.L.'s (STRUCTURAL SLAB LEVEL) ARE INDICATIVE. T.B.C. BY ARCHITECT.

NOTE
WATERPROOFING STRATEGY TO BE CONFIRMED BY OTHERS.

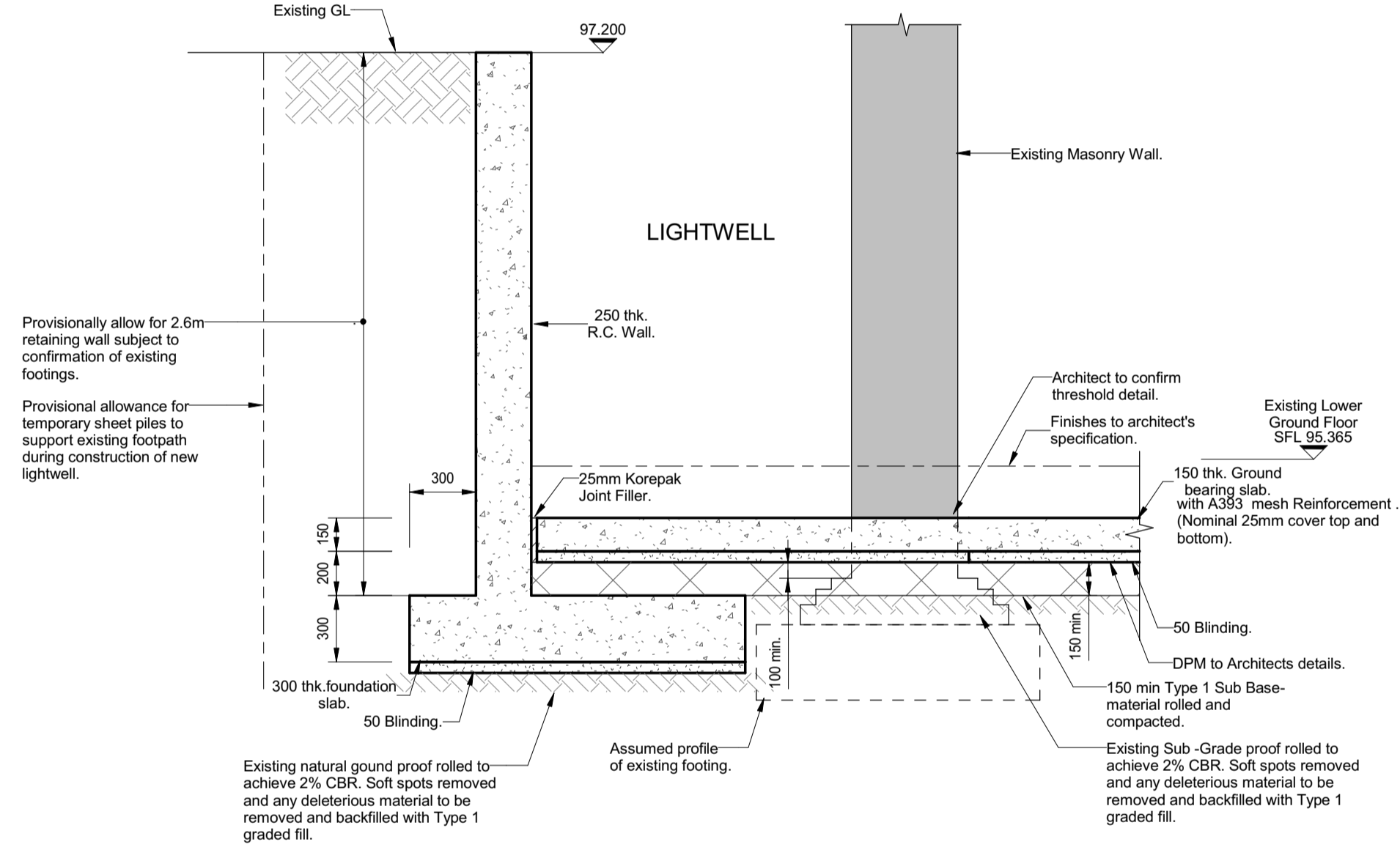

Section 1-1

scale 1:25

REV DATE DESCRIPTION BY CHKD

PRELIMINARY



TITLE:
**Typical Foundation Details
Bay House**

PROJECT:
**Project No. 11581
Kidderpore Avenue**

SCALE: A1@ 1:25 DATE: March '16 DRAWN: DA CHKD: TP

DRG NO. 9100-DRG-00BH-LG001 REV.

Tully De'Ath
consultants

Engineering at its Best

T: 01342 828 000
E: info@tullydeath.com
W: www.tullydeath.com