

General Notes

1. Drawings shall be referred to for structural work only unless otherwise stated and read in conjunction with Architect's, Service Engineer's and Sub-Contractor's drawings.
2. The Contractor shall check all levels and dimensions, any errors or omissions are to be reported at once to the Engineer.
3. Existing layouts and levels based upon Murphy's surveys information received to date (February 2016)
4. For Key and Member Schedules refer to drawing no. 9100-DRG-99YY-GN01.
5. For General Notes refer to drawing no. 9100-DRG-99YY-GN02.

NOTE
FOR BUILDERSWORK HOLES ASSOCIATED WITH NEW SERVICES REFER TO M & E DRAWINGS.

NOTE
ALL SERVICES SIZES AND POSITIONS ARE TO BE CONFIRMED BY THE ARCHITECT/M&E CONSULTANT PRIOR TO CONSTRUCTION.

NOTE
REFER TO DRG No. 9100-DRG-00YY-DE007 FOR GROUND BEARING SLAB REINFORCEMENT PRINCIPLES.

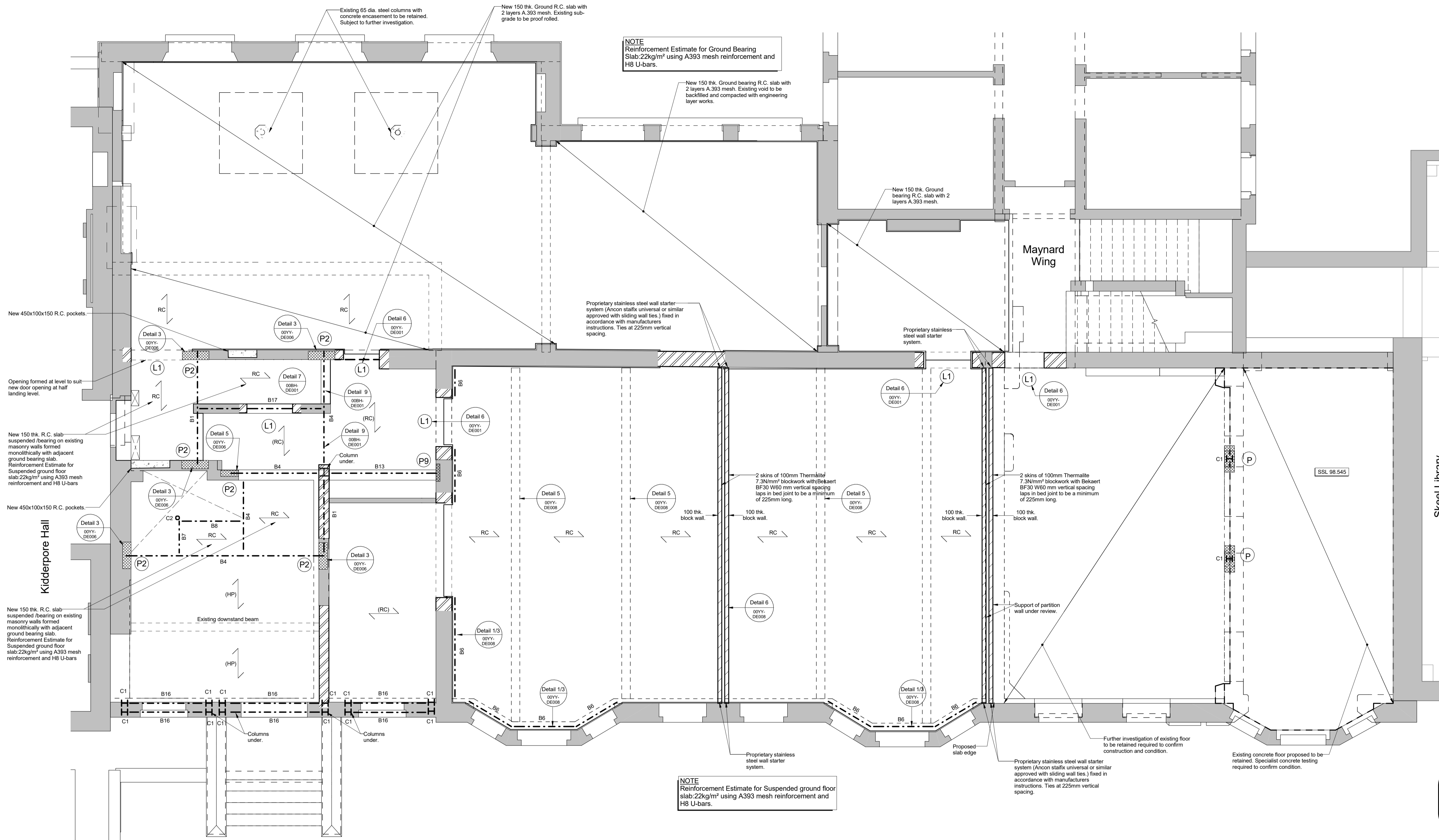

Skeel Library

REV	DATE	DESCRIPTION	BY	CHKD
B	11.08.16	Issued For Tender. Steel Columns below mezzanine level omitted. Steelwork generally revised. Detail references added.	DA	AT
A	15.06.16	Key and Intel schedules removed. General notes revised. Mezzanine Steelwork revised.	DA	TP
-	25.05.16	First Issue.	DA	TP

FOR TENDER



TITLE:
**Bay House
Level UG Proposed Floor Plan**

PROJECT:
**Project No. 11581
Kidderpore Avenue**

SCALE: A1@ 1:50 DATE: May '16 DRAWN: DA CHKD: TP

DRG NO. REV.
9100-DRG-03BH-UG001 B

Tully De'Ath
consultants

Engineering at its Best

T: 01342 828 000
E: info@tullydeath.com
W: www.tullydeath.com