

- LEGEND
- EXISTING MAIN DWELLINGHOUSE
 - PROPOSED BASEMENT STRUCTURE
 - DEMOLISH & REBUILD BASED ON ORIGINAL MATERIALS & DESIGN
 - PROPOSED 'TUNNEL' SECTION OF BASEMENT
 - AREA FALLS WITHIN RPAs - PROPOSED TRADITIONAL CONSTRUCTION METHOD
 - PROPOSED FINISHED FLOOR LEVEL
 - PROPOSED 'TUNNEL' CONSTRUCTION - ROOF & WALL FORMED BY PIPE-JACKING

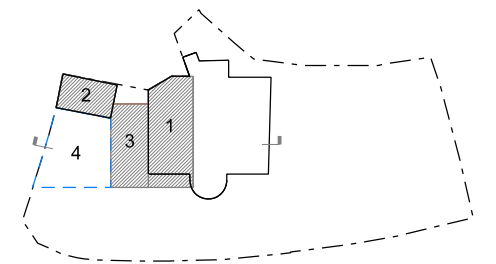

1 PROPOSED SECTION

REVISION		
-	04.03.2016	ISSUED FOR PRE-PLANNING APPLICATION ADVICE (2016)
A	15.10.2016	DRAFT - ISSUED FOR COMMENT
B	24.10.2016	ISSUED FOR LISTED BUILDING CONSENT & PLANNING APPLICATION

NOTES:
- THIS IS A "SCHEME LEVEL DRAWING" AND IS INTENDED TO ILLUSTRATE THE GENERAL ARRANGEMENT OF THE PROJECT PROPOSALS FOR THE PURPOSE OF PLANNING APPLICATION
- THIS DRAWING MUST NOT BE USED FOR CONSTRUCTION
- DO NOT SCALE FROM THIS DRAWING
- ALL DIMENSIONS MUST BE VERIFIED FROM SITE

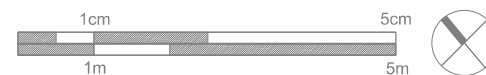

CLIENT MR RON PASCALOVICI
PROJECT 26 CHRISTCHURCH HILL LONDON NW3 1LG
TITLE PROPOSED BASEMENT SECTION WITH SITE CONSTRAINTS
DWG No 0036.P.00.006_B

1:50 @ A1
SCALE 1:100 @ A3

ERICA JONG ARCHITECTS
ARCHITECTURE DESIGN MANAGEMENT

48 Fairhazel Gardens London NW6 3SJ
T 0207 372 5768
E info@ericajongarchitects.com
www.ericajongarchitects.com