

LEGEND

- EXISTING HARD LANDSCAPING
- EXISTING FOOTPRINT OF THE MAIN DWELLINGHOUSE
- PROPOSED BASEMENT FOOTPRINT
- PROPOSED 'TUNNEL' SECTION OF THE BASEMENT FOOTPRINT
- 104.37
+
EXISTING SPOT LEVEL
- * FFL 100.98
PROPOSED FINISHED FLOOR LEVEL
- PROPOSED LINE OF CONTIGUOUS PILING
- DENOTES TYPICAL TREE PROTECTION AREA

TREE SURVEY INFORMATION (SEE ADDENDUM 3)

- T1 = CULINARY APPLE
T2 = COMMON LIME
T3 = COMMON LIME
T4 = SWEET CHESTNUT
T5 = MORIBUND SWEET CHESTNUT (TPO)
T6 = COMMON LIME
T7 = OLIVE (GROWING IN RAISED BED)
T8 = SWEET GUM (STREET TREE)

1. CEZ = CONSTRUCTION EXCLUSION ZONE
2. FACILITATION PRUNING AS REQUIRED BY REPORT TO PREVENT UNNECESSARY DAMAGE TO TREE CROWNS

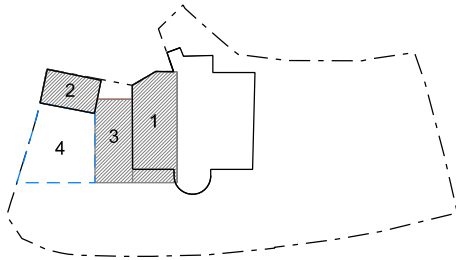

1 PROPOSED BASEMENT FLOOR PLAN

REVISION

-	04.03.2016	ISSUED FOR PRE-PLANNING APPLICATION ADVICE (2016)
A	15.10.2016	DRAFT - ISSUED FOR INFORMATION
B	24.10.2016	ISSUED FOR LISTED BUILDING CONSENT & PLANNING APPLICATION

NOTES:
- THIS IS A 'SCHEME LEVEL DRAWING' AND IS INTENDED TO ILLUSTRATE THE GENERAL ARRANGEMENT OF THE PROJECT PROPOSALS FOR THE PURPOSE OF PLANNING APPLICATION
- THIS DRAWING MUST NOT BE USED FOR CONSTRUCTION
- DO NOT SCALE FROM THIS DRAWING
- ALL DIMENSIONS MUST BE VERIFIED FROM SITE



CLIENT MR RON PASCALOVICI

PROJECT 26 CHRISTCHURCH HILL
LONDON NW3 1LG

TITLE PROPOSED BASEMENT FOOTPRINT
WITH SITE CONSTRAINTS

DWG No 0036.P.00.004_B

1:50 @ A1
SCALE 1:100 @ A3

ERICA JONG ARCHITECTS
ARCHITECTURE DESIGN MANAGEMENT

48 Fairhazel Gardens London NW6 3SJ
T 0207 372 5768
E info@ericajongarchitects.com
www.ericajongarchitects.com