

NOTE:
GRIDLINES ARE SET OUT ON EXISITING BUILDING
STRUCTURE LINES

EXISTING FIFTH FLOOR
1,005.2 ft² B1 OFFICE G/A

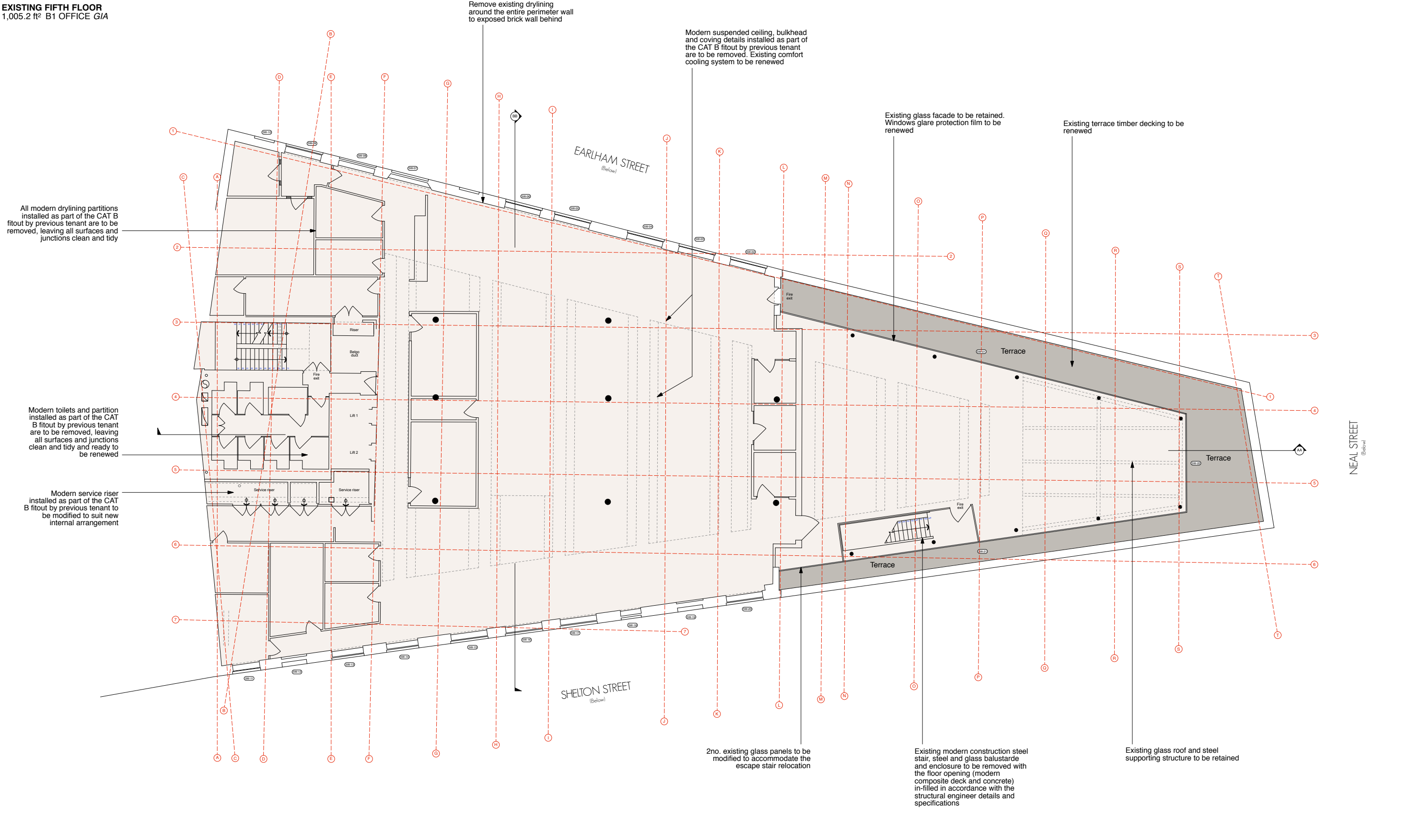

EXISTING FIFTH FLOOR PLAN

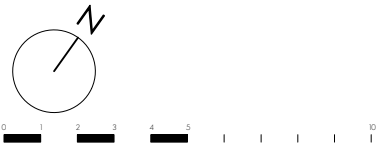

PLANNING

			PROJECT SEVEN DIALS WAREHOUSE LONDON WC2						DRAWING TITLE EXISTING FIFTH FLOOR PLAN		
			CLIENT PEC NEALE LTD						<div>gpad</div> architecture & interior design T: 020 7549 2133 F: 020 7549 2144 E: info@gpadlondonltd.com W: www.gpadlondonltd.com <div>Unit 1 9a Dollington Street Clerkenwell London EC1V 0BQ</div>		
rev.	date	notes	SCALE	1:100 @ A1	DATE	Oct 16	DWG BY	SF / DS			
<div>This drawing is the copyright of gpad london ltd. Not to be reproduced, retained or disclosed to any unauthorized person either wholly or in part without written permission. Do not scale off this drawing. All indicated dimensions to be checked and verified on site by the contractor before commencement of any fabrication drawings or work whatsoever on site. Report any discrepancies to the Architect immediately. Drawings to be read in conjunction with relevant drawings and specification.</div>			CHCKD.	DWG NO.	527-EX.08						
			© gpad london ltd.								