

KEY PLAN

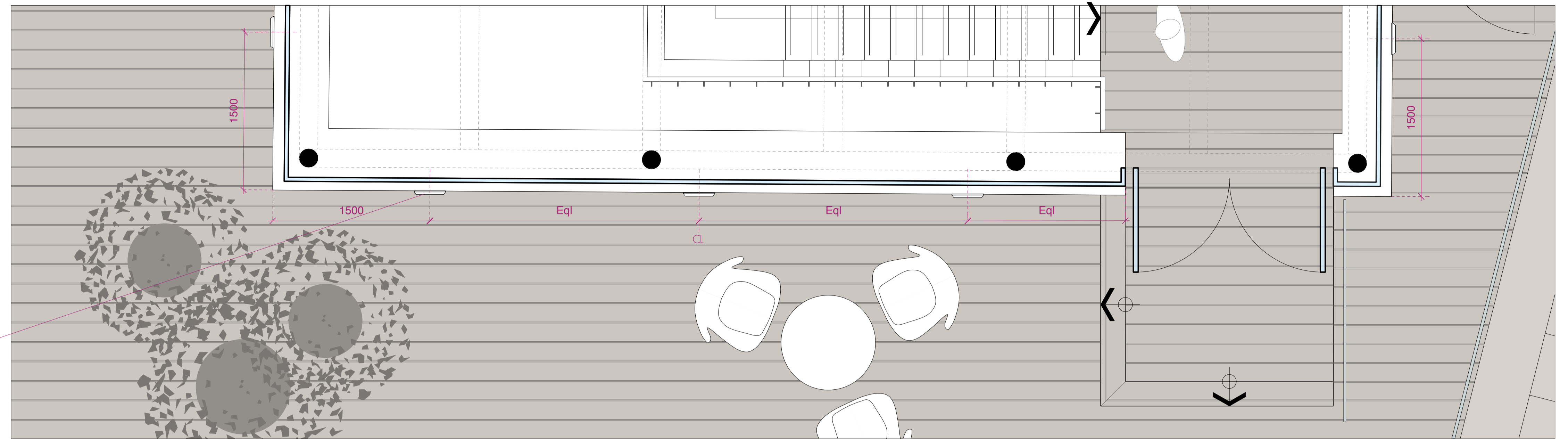

Scale 1:25

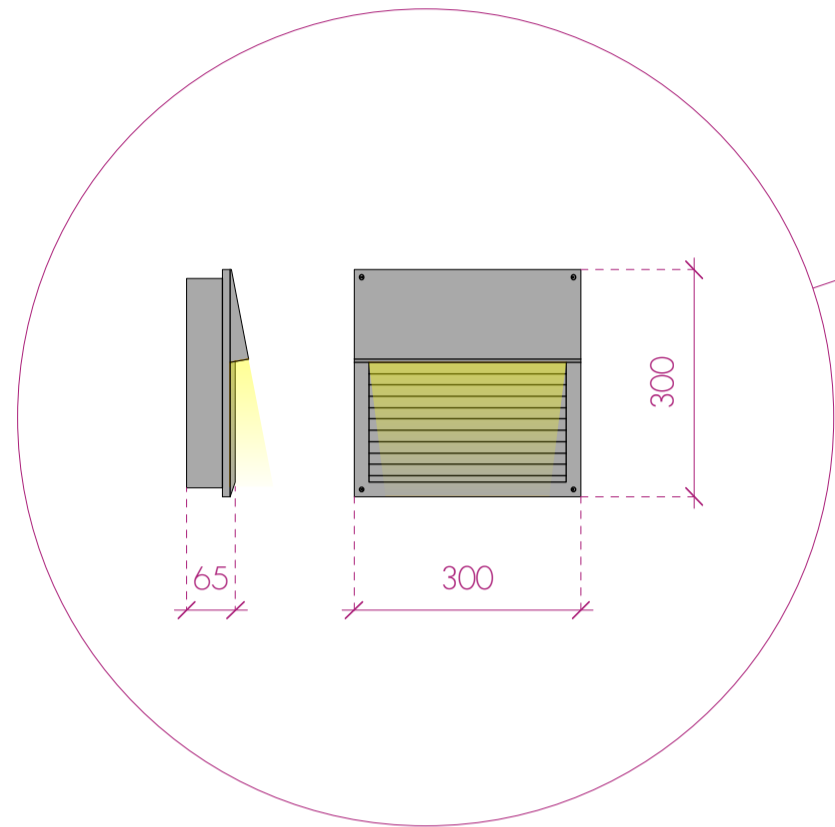

DETAIL iGuzzini 'Comfort' square luminaire  
Ref: B581 15 (Scale 1:10)

Terrace lighting feature made up from a combination of 13 'Comfort' iGuzzini luminaire arranged according to layout within 2 stainless steel support bases to be mounted beneath the composite deck boards.

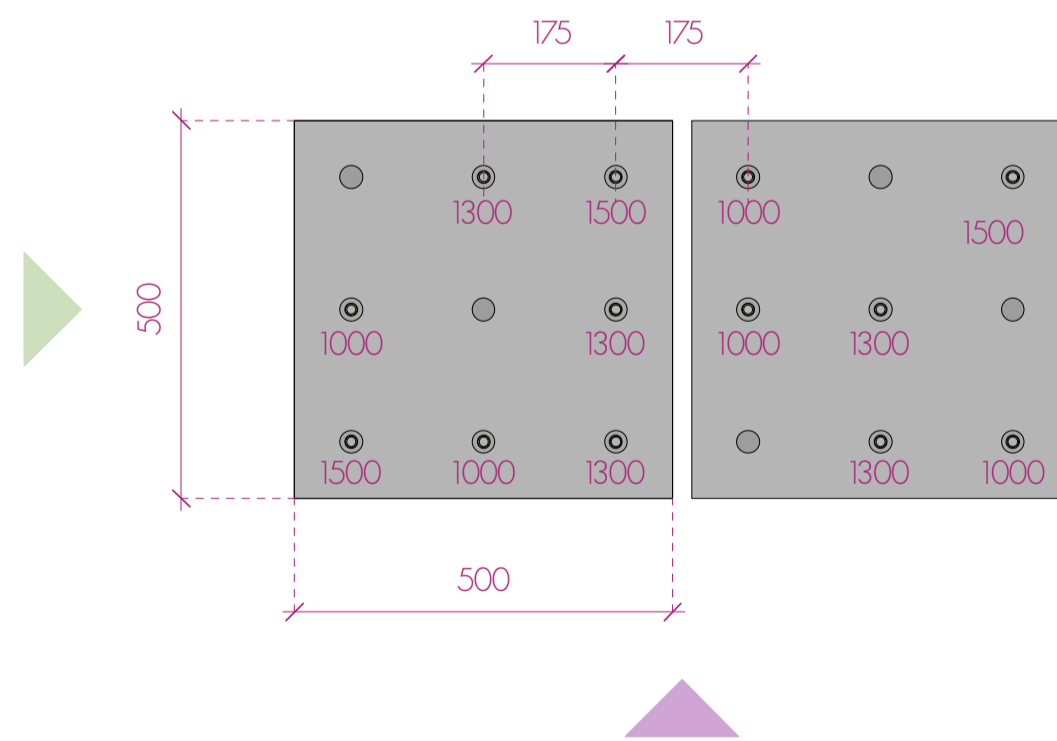

DETAIL iGuzzini 'Typha' 13 Feature Luminaires  
Combination of Ref: T415 13, ADT3 13, ADT4 13 & ADT5 13  
(Scale 1:10)

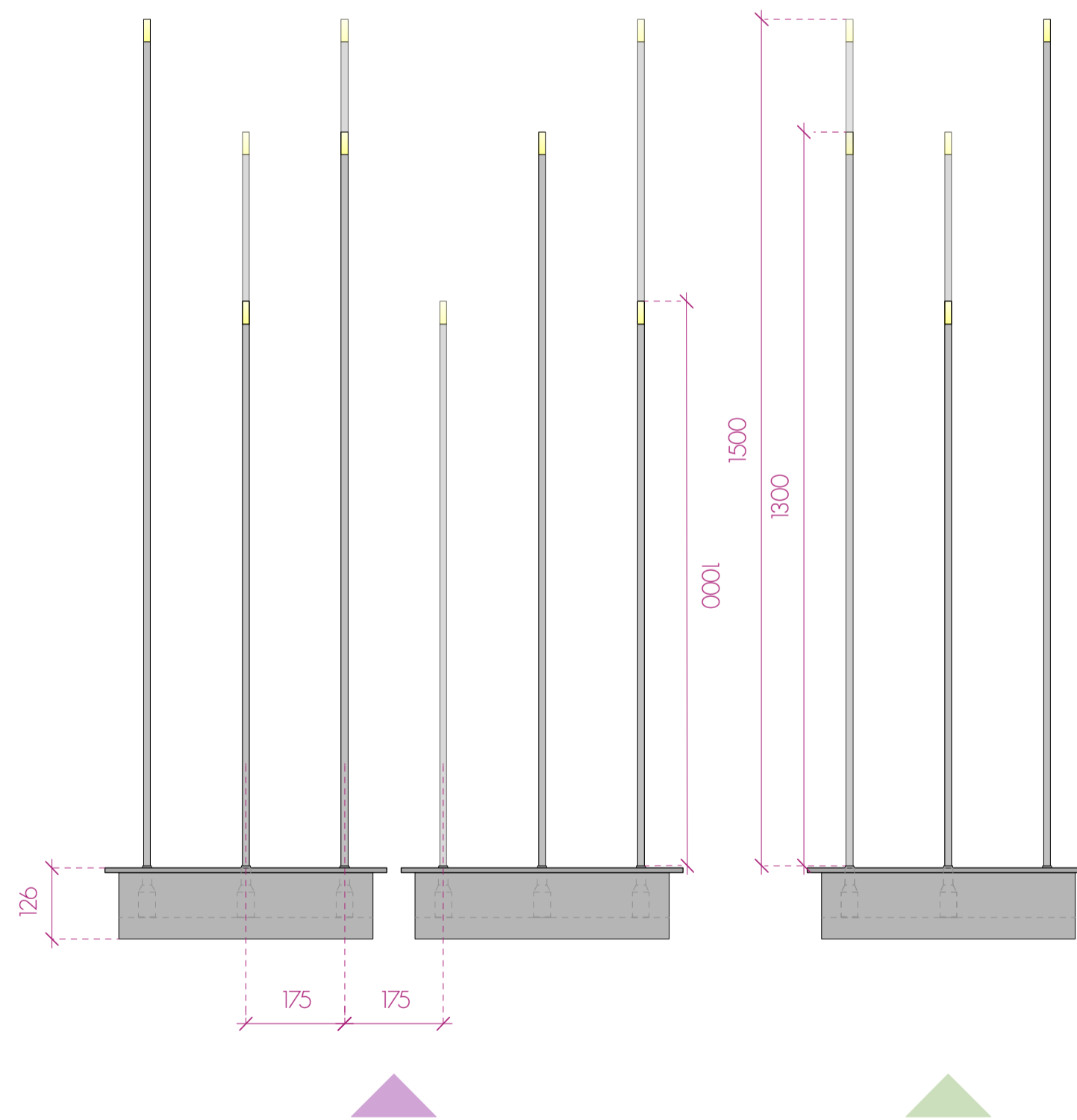

DETAIL iGuzzini 'Pencil' circular luminaire  
Ref: BN37 15 (Scale 1:10)

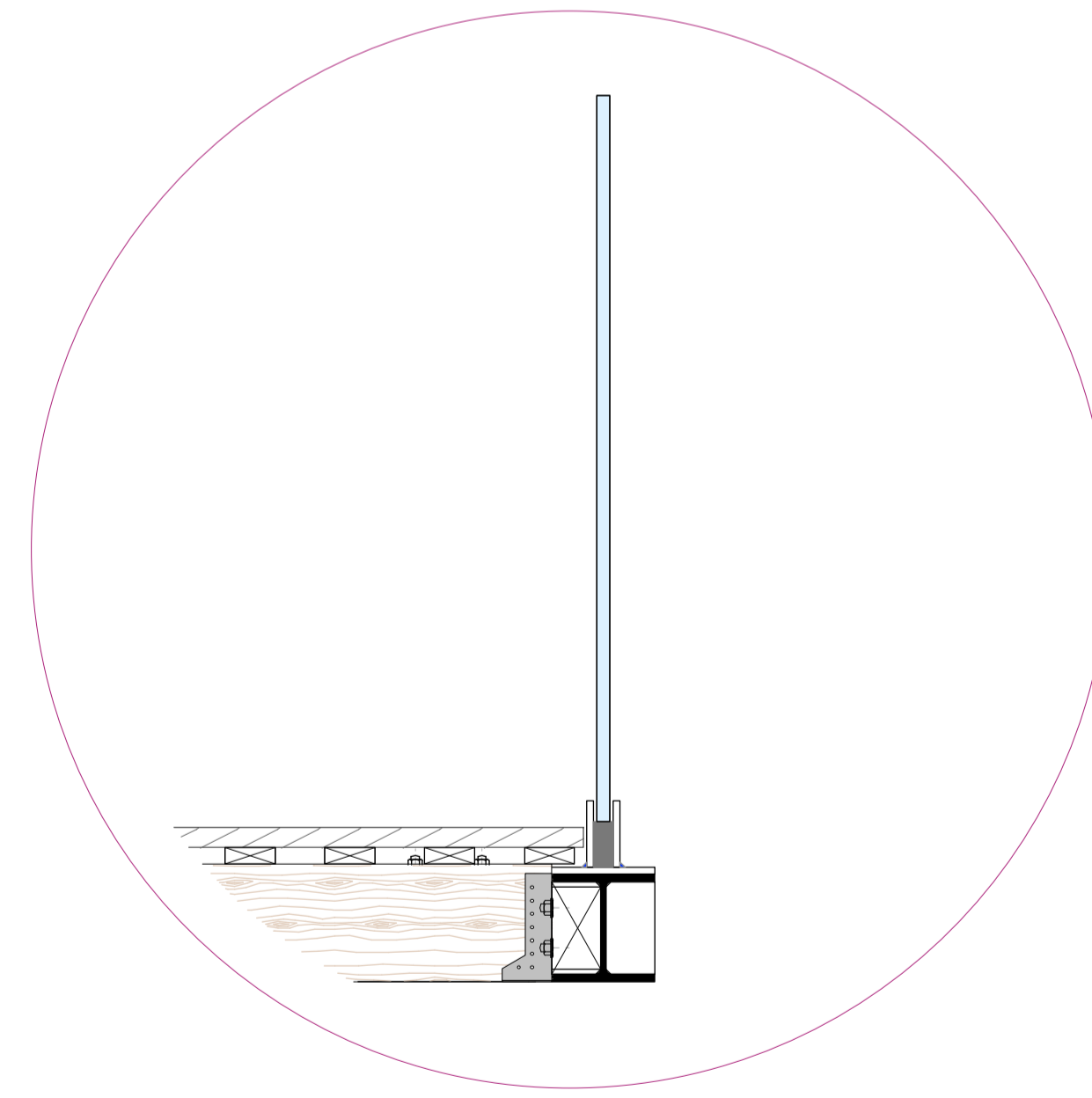
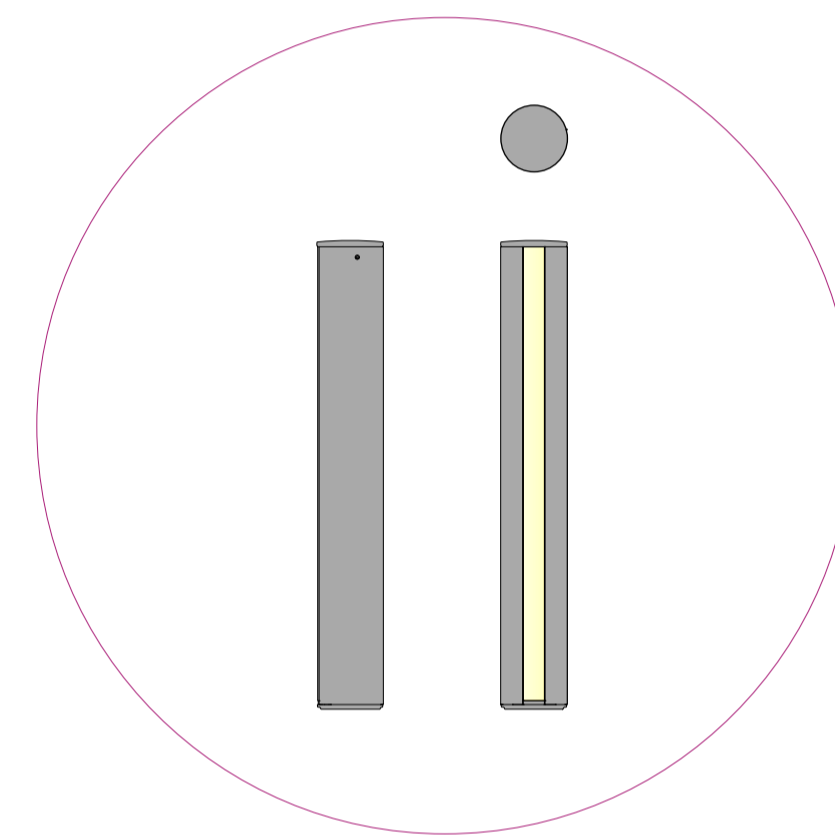

DETAIL Perimeter terrace balustrade  
Scale 1:10

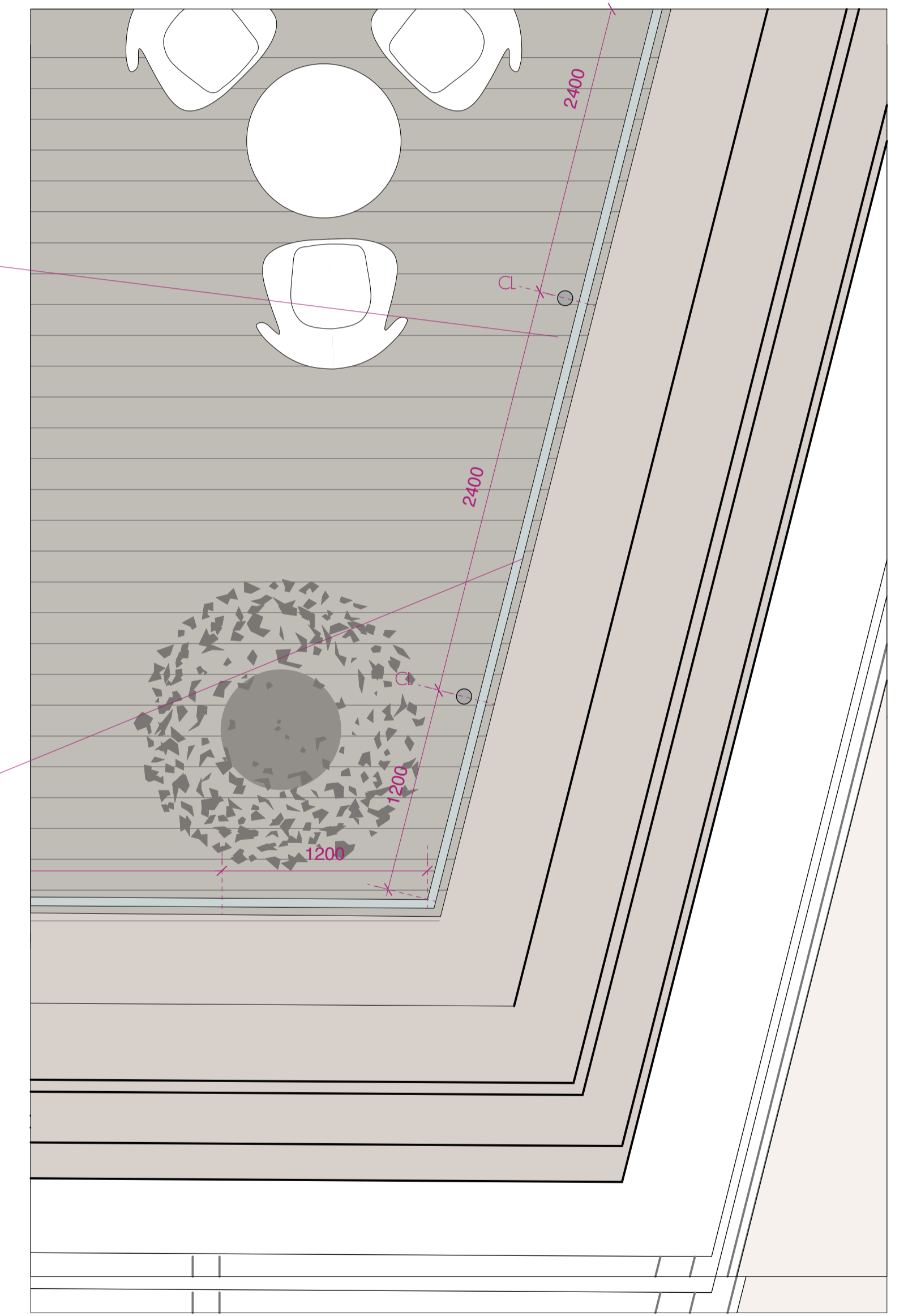

Scale 1:25

All finishes and surface materials to be applied and or laid in accordance with the manufacturer's specifications and appropriate BS standards.

PLANNING

rev.	date	notes

This drawing is the copyright of gpad london ltd. Not to be reproduced, retained or disclosed to any unauthorised person either wholly or in part without written permission. Do not scale or use drawings. All indicated dimensions to be checked and verified on site by the contractor before commencement of any fabrication drawings or work whatever on site. Report any discrepancies to the architect immediately. Drawings to be read in conjunction with relevant drawings and specification. © gpad London ltd.

PROJECT	SEVEN DIALS WAREHOUSE LONDON WC2		
CLIENT	PEC NEAL LTD, C/O CBRE GI		
SCALE	AS SHOWN @A1	DATE	OCT 2016
CHCKD.	DS	DWG NO.	527-AS.34
DWG BY	SF	REV.	

DRAWING TITLE	PROPOSED TERRACE DETAILS		
			
T: 020 7549 2133	Unit 1		
F: 020 7549 2144	9a Dallington Street		
E: info@gpadlondonltd.com	Clerkenwell		
W: www.gpadlondonltd.com	London EC1V 0BQ		