

KEY PLAN

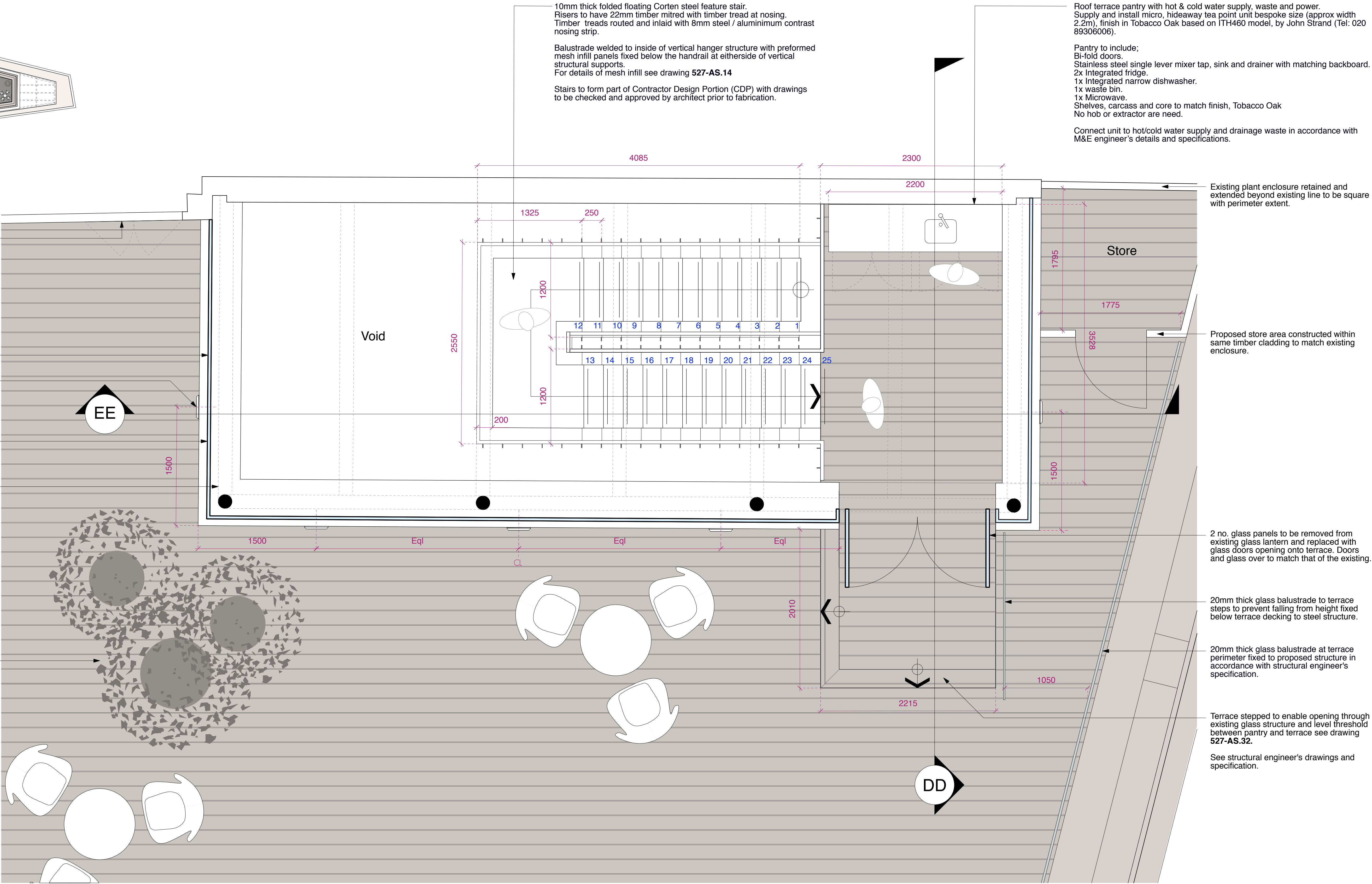

PROPOSED TERRACE ACCOMODATION STAIR PLAN

All finishes and surface materials to be applied and or laid in accordance with the manufacturer's specifications and appropriate BS standards.

PLANNING

rev.	date	notes
This drawing is the copyright of gpad london ltd. Not to be reproduced, retained or disclosed to any unauthorised person either wholly or in part without written permission. Do not scale or this drawing. All indicated dimensions to be checked and verified on site by the contractor before commencement of any fabrication drawings or work whatever on site. Report any discrepancies to the Architect immediately. Drawings to be read in conjunction with relevant drawings and specification. © gpad London Ltd.		

PROJECT			
SEVEN DIALS WAREHOUSE LONDON WC2			
CLIENT			
PEC NEAL LTD, C/O CBRE GI			
SCALE	1:25 @ A1	DATE	OCT 2016
DWG BY	SF	REV.	
CHKD.	DS	DWG NO.	527-AS.31

DRAWING TITLE	
PROPOSED TERRACE ACCOMODATION STAIR PLAN	
<div>gpad</div> architecture & interior design	
T: 020 7549 2133 F: 020 7549 2144 E: info@gpadlondonltd.com W: www.gpadlondonltd.com	
Unit 1 9a Dallington Street Clerkenwell London EC1V 0BQ	