

**KEY:**

Line indicate floor structure below

Line indicate elements to be removed

Line indicate BMS wire ways below FFL

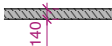

**EXISTING BLOCKWORK WALL**  
Unknown type and density



**PARTITION A - 60MIN**  
1 layer of 15mm FireLine board fixed to either face of 70mm Gypframe 'C' studs @ 600mm c/s  
50mm Isowool APR 1200 in the cavity  
Finish to aymes jointing system

3600mm maximum partition height  
60 minute fire resistance  
44RwdB sound resistance  
British Gypsum system ref:**A206141**



**PARTITION B - 30MIN**  
1 layer of 12.5mm WallBoard board fixed to either face of 70mm Gypframe 'C' studs @ 600mm c/s  
25mm Isowool APR 1200 in the cavity  
Finish to aymes jointing system

3600mm maximum partition height  
30 minute fire resistance  
42RwdB sound resistance  
British Gypsum system ref:**A206045**

Reception Room Details

**527-AS.10-11**

Reception Desk Details

**527-AS.09**

Platform Lift Details

**527-AS.12**

Form new timber steps on suitable frame and support and line with 22mm plywood. Secure the plywood to the subfloor deck screws placed along the edges. Set all screw heads slightly below the surface and infill heads and joints with patching compound. Smooth it in place and allow it to dry. Allow 10mm gap along the walls and between the joints for expansion. Apply silicon joint to edges. Finish to match with floor finish colour.

Install antislip antiwear cast metal stair nosing Ref: AATITM type SN9/55® - HDLTTM with silicon carbide granules cast into the metal matrix of the wearing surface. Finish: Gunmetal

No handrail is required.



**RESIN FLOORING**  
Apply PURR liquid resin floor finish to stair treads, landings and lobbies. Colour reference sample to be agreed before application. Substrate to be prepared in accordance with supplier's recommended method

Resin floor build up 6mm +/-

Remove all existing floor finishes throughout including any associated frames and fixings. Substrate type and condition to be confirmed following the soft strip out of CAT B finishes. Leave floor clear from any debris, residus, clean and tidy. Allow provisional sum for new substrate and or self leveling to bring new finish floor up to existing FFL level.



**CONTRACT BARRIER CARPET**  
Supply and install heavy duty barrier carpet tiles Ref: 0810 Main Road, Front Line Range by Duraflor (Tel: 01592 630 030). Matt installed in accordance with supplier recommendation. Carpet depth: 7.2mm. Install formable floor trim to edge Ref: TTA9, Matt aluminium finish by CAT (Tel: 01582 561500)

**PROJECT**  
**SEVEN DIALS WAREHOUSE**  
**LONDON WC2**

**CLIENT**  
**PEC NEALE LTD**

**SCALE** 1:50 @ A1  
**DATE** Oct 2016  
**DWG BY** PG  
**REV.**  
**CHKD.** DS  
**DWG NO.** 527-AS.01

**DRAWING TITLE**  
**PROPOSED GROUND FLOOR PLAN**

**gpad** architecture & interior design

**T:** 020 7549 2133  
**F:** 020 7549 2144  
**E:** info@gpadlondonltd.com  
**W:** www.gpadlondonltd.com  
Unit 1  
9a Dallowington Street  
Clerkenwell  
London EC1V 0BQ