

NOTE:
GRIDLINES ARE SET OUT ON EXISTING BUILDING
STRUCTURE LINES

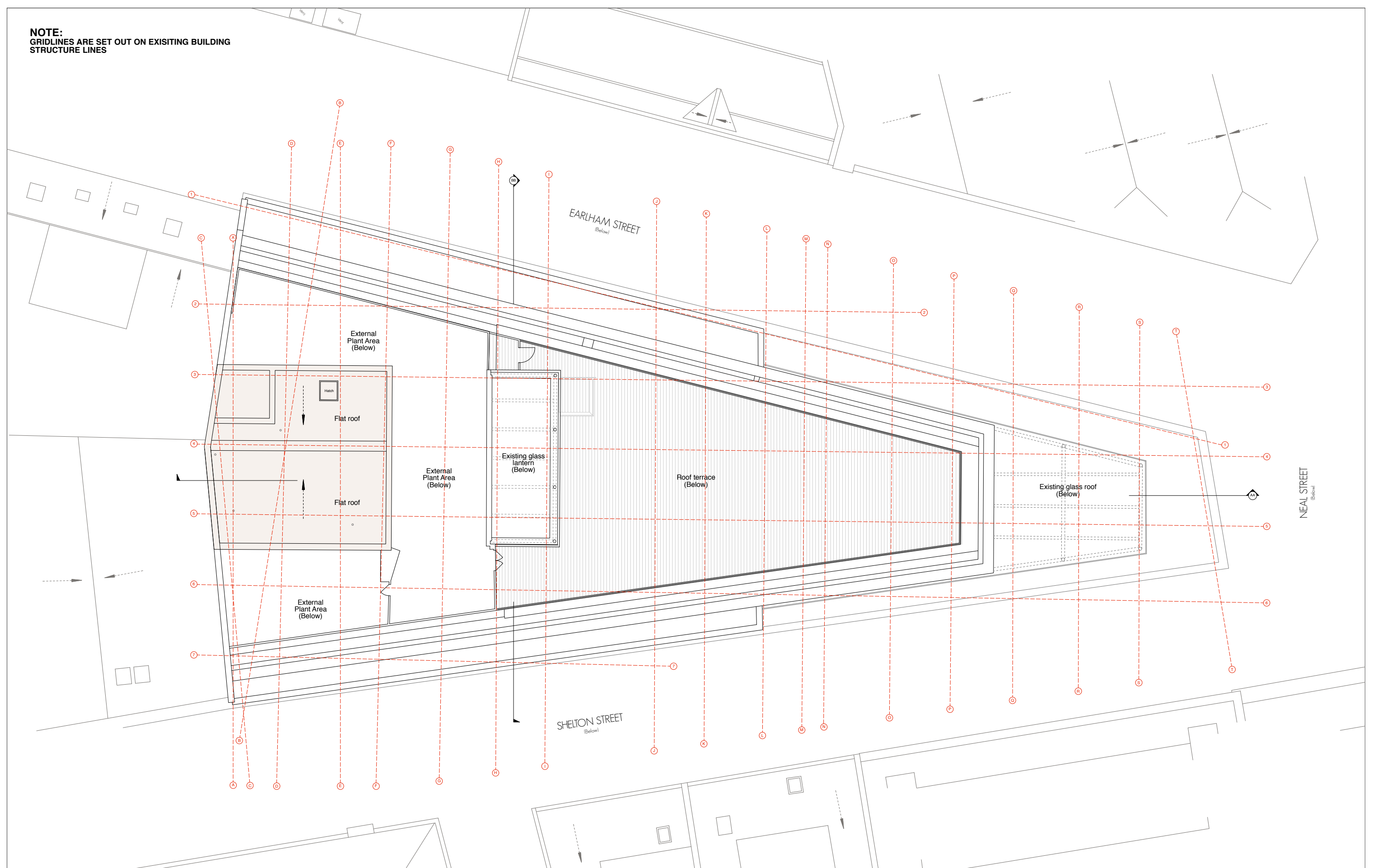

PROPOSED ROOF OVERRUN PLAN

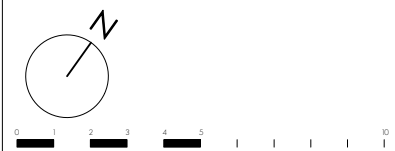

NOTE:

- The proposed extension area is subject to;
- Statutory approval by local authorities;
 - Assessment of impact on rights of light;
 - Assessment of impact on daylight and sunlight;
 - Assessment of impact on fire strategy;
 - Assessment of existing structural loading capacity;
 - Assessment of building services;

PLANNING

rev.	date	notes

This drawing is the copyright of gpad london ltd. Not to be reproduced, retained or disclosed to any unauthorised person either wholly or in part without written permission. On no account shall the drawing, all indicated dimensions to be checked and verified on site by the contractor before commencement of any fabrication drawings or work whatsoever on site. Report any discrepancies to the Architect immediately. Drawings to be read in conjunction with relevant drawings and specification.

PROJECT		SEVEN DIALS WAREHOUSE LONDON WC2	
CLIENT		PEC NEALE LTD	
SCALE	DATE	DWG BY	REV.
1:100 @ A1	Oct 16	SF / DS	
CHKD.	DWG NO.	527-GA.07	

DRAWING TITLE		PROPOSED ROOF OVERRUN PLAN	
gpad		architecture & interior design	
T: 020 7549 2133		Unit 1	
F: 020 7549 2144		9a Dollington Street	
E: info@gpadlondonltd.com		Clerkenwell	
W: www.gpadlondonltd.com		London EC1V 0BQ	