

**NOTE:**  
**GRIDLINES ARE SET OUT ON EXISTING BUILDING**  
**STRUCTURE LINES**

**PROPOSED FIFTH FLOOR**  
 1,005.2 ft<sup>2</sup> B1 OFFICE *G/A*

893.5 ft<sup>2</sup> B1 OFFICE *N/A*

**RAISED FLOOR**  
 Existing accessible raised floor panels and pedestals to be retained. Install new panels and pedestals to match to suit new internal arrangement. Allow for new black neoprene foam strip.

Throughout: Remove any loose dirt by dry vacuum cleaning. Remove any adhering dirt with a single-disc cleaning machine or polishing vacuum cleaner (e.g. TASKI Omnisystem) and then work it in with a Red cleaner pad. If the pad starts to smudge, turn it or replace it by a new one. Having cleaned the surface, re-polishing, if required, is possible using a single-disc cleaning machine or polishing vacuum cleaner and polishing pad (White or Yellow).

Existing brick wall finish to be exposed by removing the soft partitioning & drylining around the entire perimeter wall. Exact condition of the brick and type of treatment to be identified and agreed following the soft strip works

Existing trench heater in floor channel to be maintained

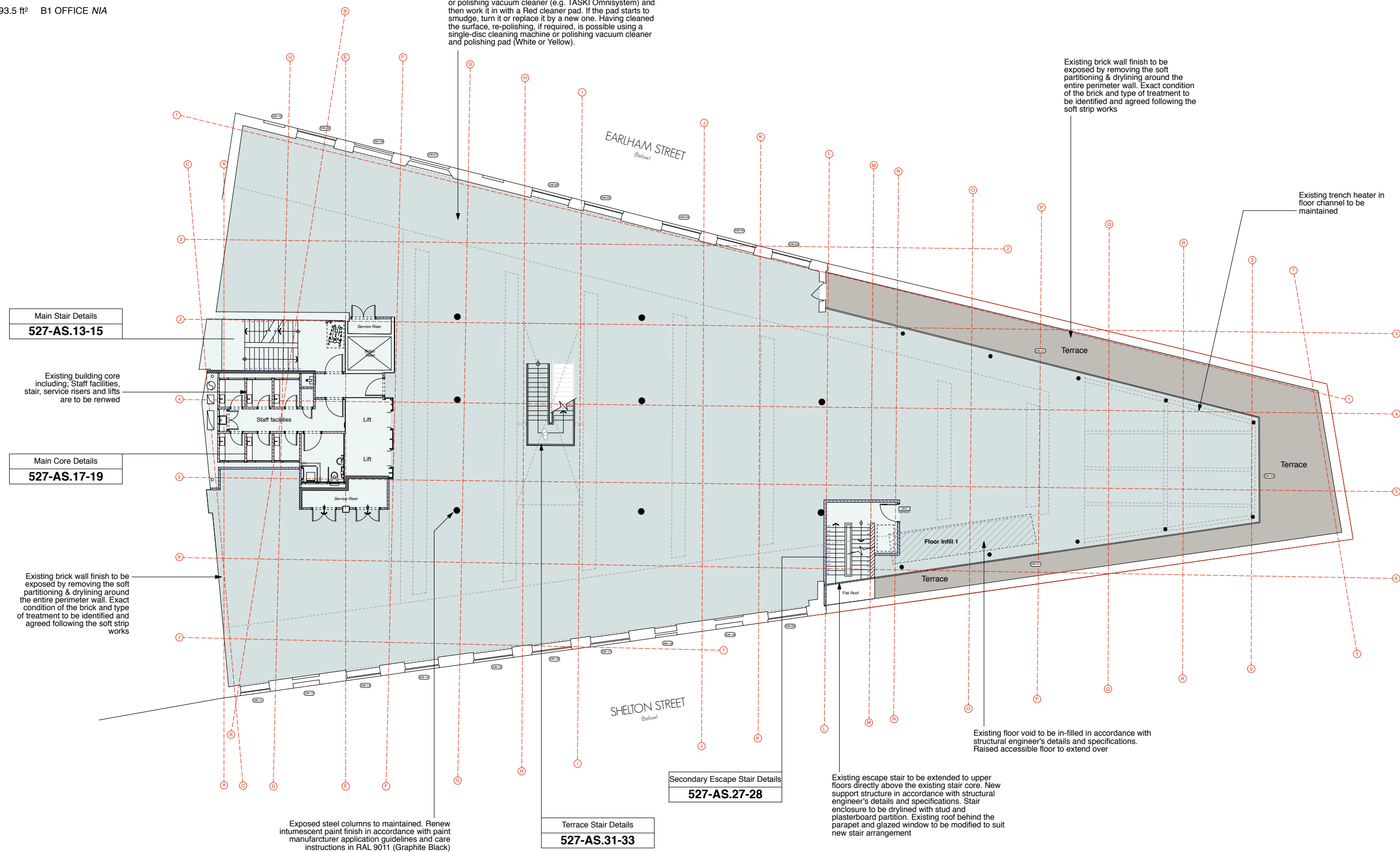

Main Stair Details  
**527-AS.13-15**

Existing building core including: Staff facilities, stair, service risers and lifts are to be renewed

Main Core Details  
**527-AS.17-19**

Existing brick wall finish to be exposed by removing the soft partitioning & drylining around the entire perimeter wall. Exact condition of the brick and type of treatment to be identified and agreed following the soft strip works

Exposed steel columns to be maintained. Renew intumescent paint finish in accordance with paint manufacturer application guidelines and care instructions in RAL 9011 (Graphite Black)

Secondary Escape Stair Details  
**527-AS.27-28**

Terrace Stair Details  
**527-AS.31-33**

Existing floor void to be in-filled in accordance with structural engineer's details and specifications. Raised accessible floor to extend over

Existing escape stair to be extended to upper floors directly above the existing stair core. New support structure in accordance with structural engineer's details and specifications. Stair enclosure to be drylined with stud and plasterboard partition. Existing roof behind the parapet and glazed window to be modified to suit new stair arrangement

**PROPOSED FIFTH FLOOR PLAN**

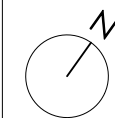

**NOTE:**

- The proposed extension area is subject to;
- Statutory approval by local authorities;
- Assessment of impact on rights of light;
- Assessment of impact on daylight and sunlight;
- Assessment of impact on fire strategy;
- Assessment of existing structural loading capacity;
- Assessment of building services;

**PLANNING**

PROJECT <b>SEVEN DIALS WAREHOUSE          LONDON WC2</b>			DRAWING TITLE <b>PROPOSED FIFTH FLOOR PLAN</b>		
CLIENT <b>PEC NEALE LTD</b>					
SCALE	DATE	DWG BY	REV.	T: 020 7549 2133 F: 020 7549 2144 E: info@gpadlondonltd.com W: www.gpadlondonltd.com	
1:100 @ A1	Oct 16	SF / DS		Unit 1 9a Dallington Street Clerkenwell London EC1V 0BQ	
CHKD.	DWG NO.	<b>527-GA.05</b>			
© gpad london ltd.					