

NOTE:
GRIDLINES ARE SET OUT ON EXISTING BUILDING
STRUCTURE LINES

PROPOSED MEZZANINE FLOOR
516 ft² TOTAL G/A
296.5 ft² STUDIO B1 OFFICE G/A

**TO BE READ IN CONJUNCTION WITH DRAWING
NO. 527-AS.03**

Mezzanine Floor 1:50
527-AS.03

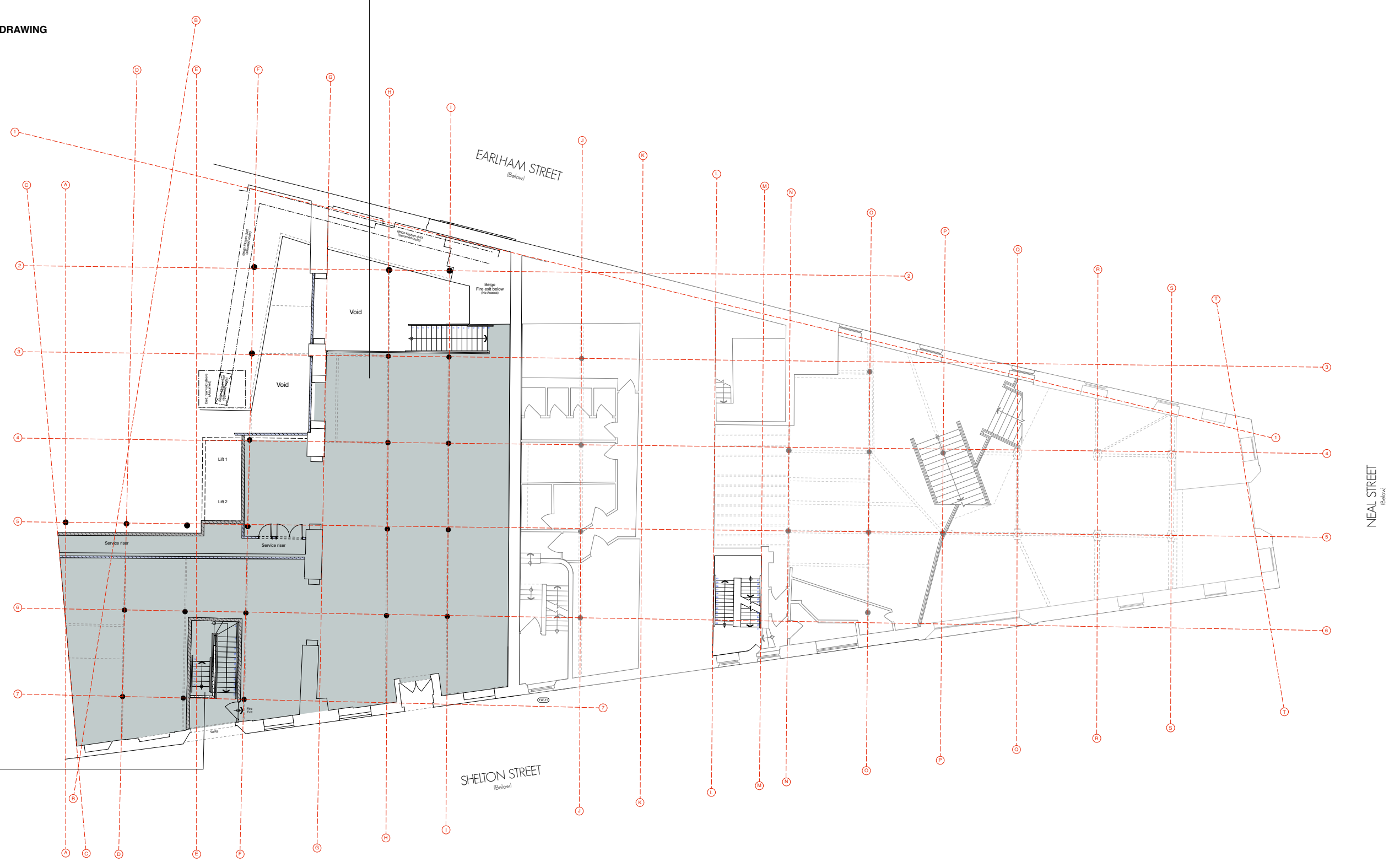

Cycle Store Stair Details
527-AS.22

PROPOSED MEZZANINE FLOOR PLAN

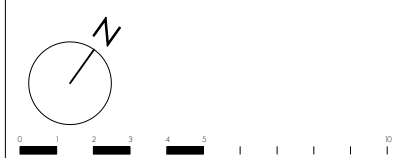

NOTE:

- The proposed extension area is subject to;
- Statutory approval by local authorities;
 - Assessment of impact on rights of light;
 - Assessment of impact on daylight and sunlight;
 - Assessment of impact on fire strategy;
 - Assessment of existing structural loading capacity;
 - Assessment of building services;

PLANNING

rev.	date	notes

This drawing is the copyright of gpad london ltd. Not to be reproduced, retained or disclosed to any unauthorised person either wholly or in part without written permission. Do not scale off this drawing. All indicated dimensions to be checked and verified on site by the contractor before commencement of any fabrication drawings or work whatsoever on site. Report any discrepancies to the Architect immediately. Drawings to be read in conjunction with relevant drawings and specification.

PROJECT SEVEN DIALS WAREHOUSE LONDON WC2		DRAWING TITLE PROPOSED MEZZANINE FLOOR PLAN	
CLIENT PEC NEALE LTD		SCALE 1:100 @ A1	
DATE Oct 16	DWG BY SF / DS	REV.	
CHKD.	DWG NO. 527-GA.02	© gpad london ltd.	

gpad architecture & interior design

T: 020 7549 2133
F: 020 7549 2144
E: info@gpadlondonltd.com
W: www.gpadlondonltd.com

Unit 1
9a Dallington Street
Clerkenwell
London EC1V 0BQ