

Please note that information used to produce these drawings is based on measured survey supplied by others; Heritage Architecture can not be held responsible for any inaccuracies that may exist. Please do not scale drawings. All dimensions should be verified on site.

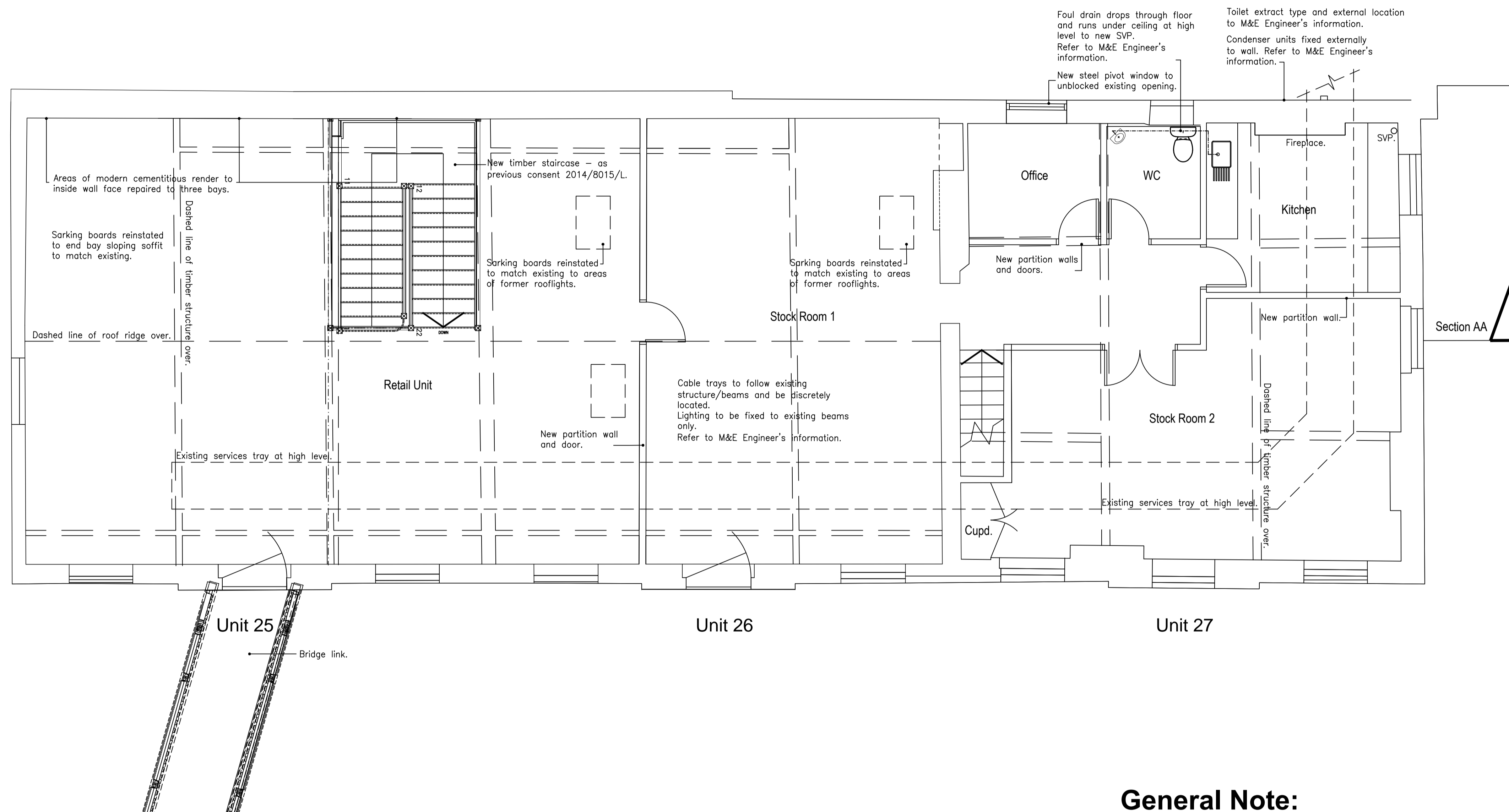

Proposed First Floor Plan
Scale 1:50

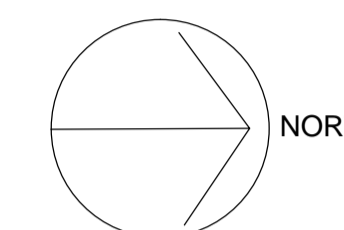
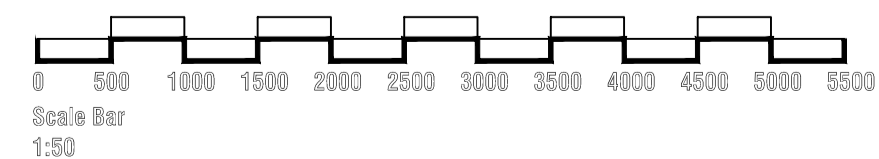

General Note:

-M&E proposal represents the continuation of the environmental building services programme of work previously consented (2013/8060/L) providing heating & cooling to facilitate tenant occupation.

-Interior shop fitting wall linings and associated retail signage NOT to cover more than two thirds of an existing walls surface area.

-Shop fitting out and product display to retailer's design.

Camden Stables Market
London
NW1
United Kingdom

STANLEY SIDINGS LTD

Camden Stables Market
TACK ROOM (BLOCK D)

Drawing Title
Proposed tenant fitting out works
Proposed First Floor Plan

Scale 1:50 @ A1

Drawing Status
For Planning & Listed Building Consent

October 2016 Drawing No
D-PP-05

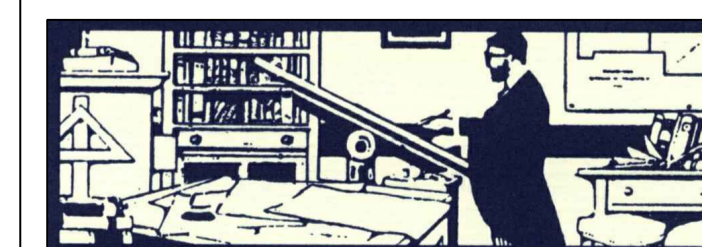

STEPHEN LEVRANT HERITAGE ARCHITECTURE
62 British Grove, London, W4 2NL
E-mail: info@heritagemail.co.uk