

NOTE!

Eldred Geotechnics Ltd received this drawing from its author David A Berle Consulting Engineers who disclaim any knowledge whatsoever of the construction of the works to which it refers and/or the extent that construction resembles the provisions of this drawing. The author's disclaimer passes with the drawing

drawings are to be read in conjunction with architects drawings & details contractor to provide all necessary shoring & temporary support as found to be necessary during demolition & installation of new structure new joists to be as shown, noggins @ one third span points for all floors, double joists connected with 12dia bolts @ 600ccs provide double joists or noggins between joists @ stud partitions provide 30x5 straps x 900 long @ 1.4m ccs all round perimeter to requirements of Building Inspector double joists as trimmers for openings etc steel to be grade S275, thoroughly hand cleaned & given 2 coats of micaceous iron oxide padstones to be 150 deep & set in dry pack within ex bw'k min bearings to be 100 for beams uno, 150 for lintels connections to consist of 12 fully welded end plate, 2x2/20dia bolts (grade 8.8), flanges shaped to suit

refer also to drawing 01

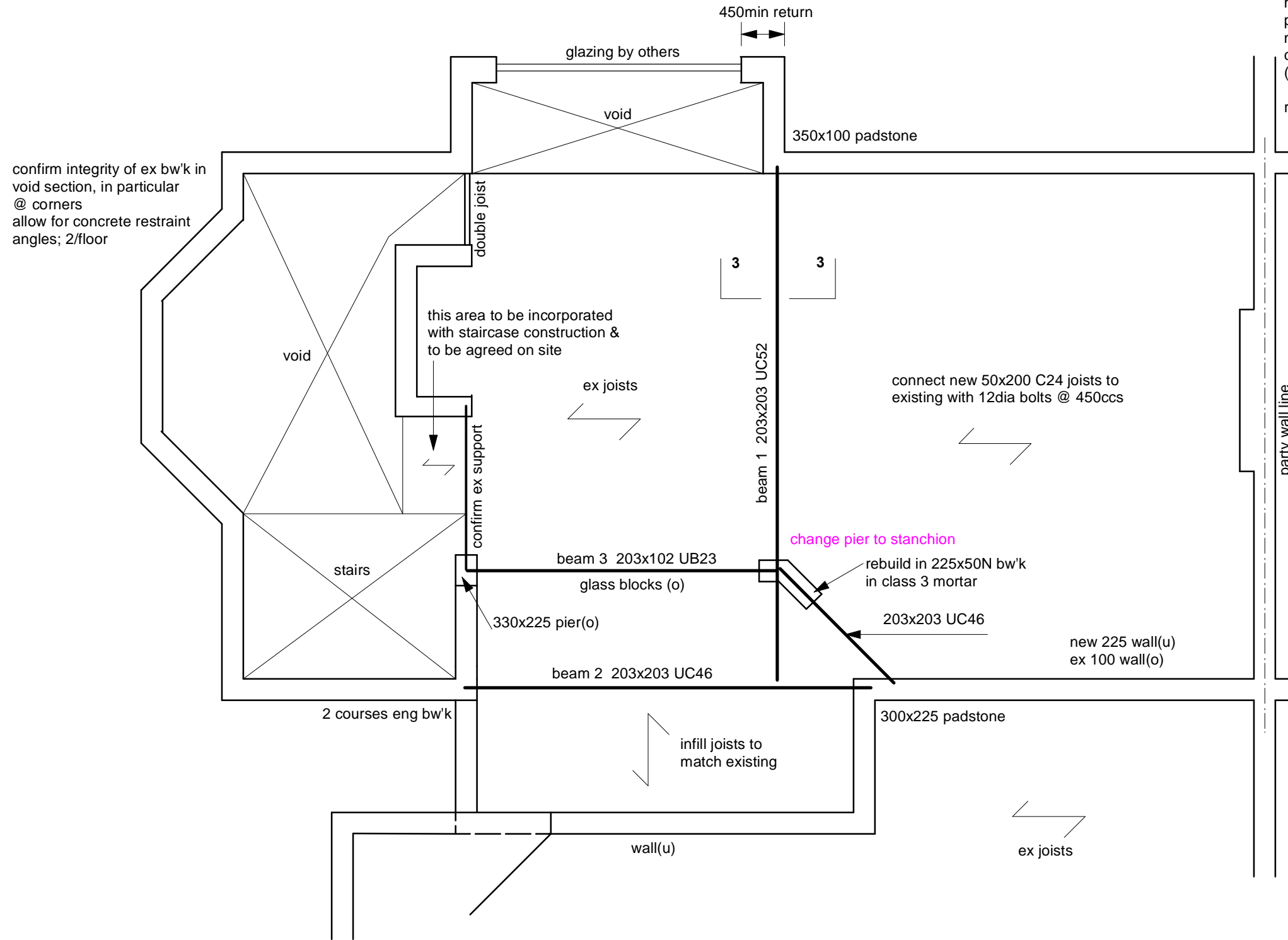

GROUND FLOOR PLAN

rev	amendment	date

06194-02

12 Clorane Gardens

1:50

London NW3 7PR

July 2006