

NOTE!
 Eldred Geotechnics Ltd received this drawing from its author David A Berle Consulting Engineers who disclaim any knowledge whatsoever of the construction of the works to which it refers and/or the extent that construction resembles the provisions of this drawing. The author's disclaimer passes with the drawing

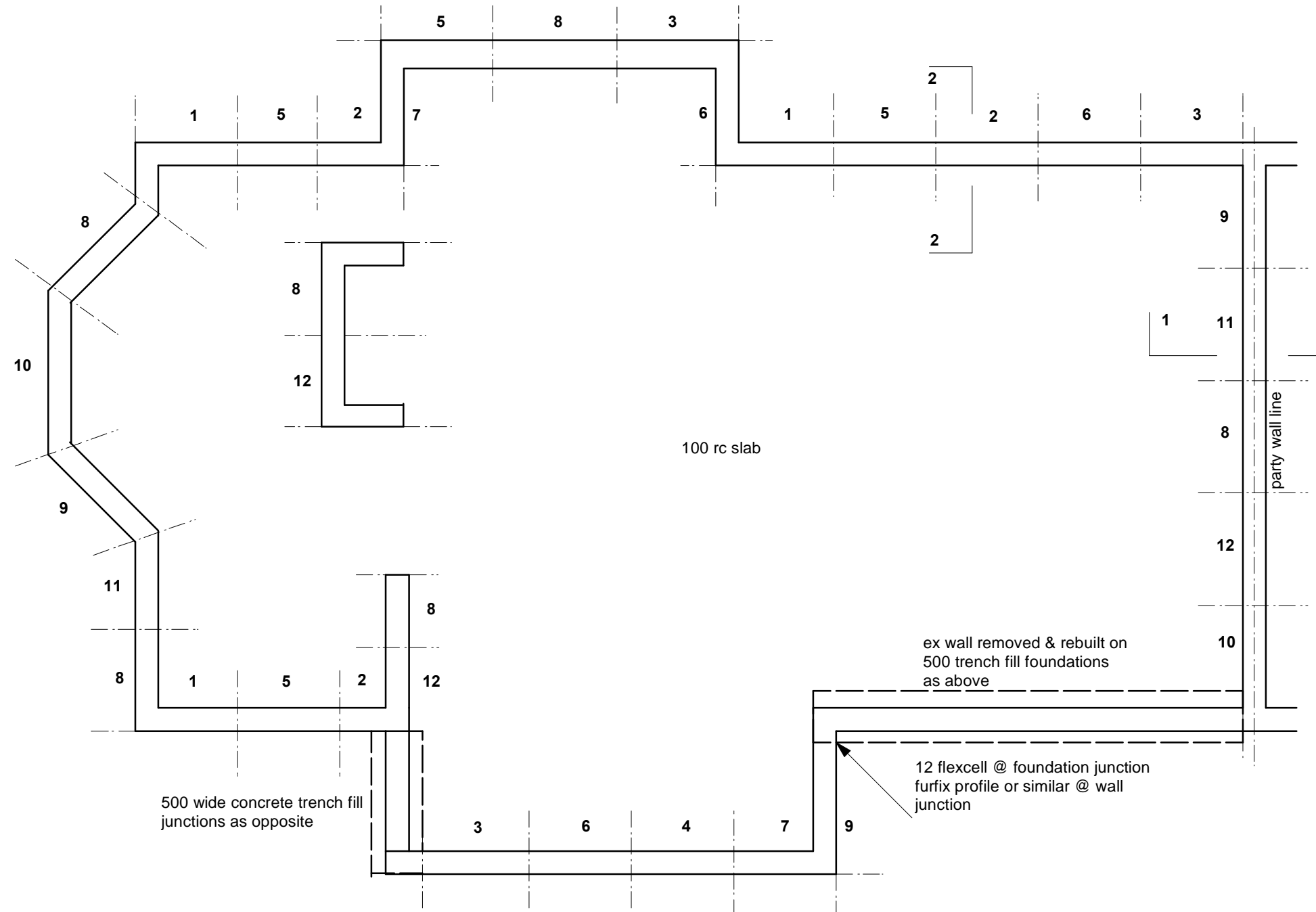

underpinning sequence as shown
 also refer to specification
 minimum depth of trench fill to be 1000
 & to DS requirements
 party wall matters are to be noted

FOUNDATIONS/LOWER GROUND FLOOR PLAN

rev	amendment	date