

----- = Extent of access driveway

THE HEXAGON
[access driveway]

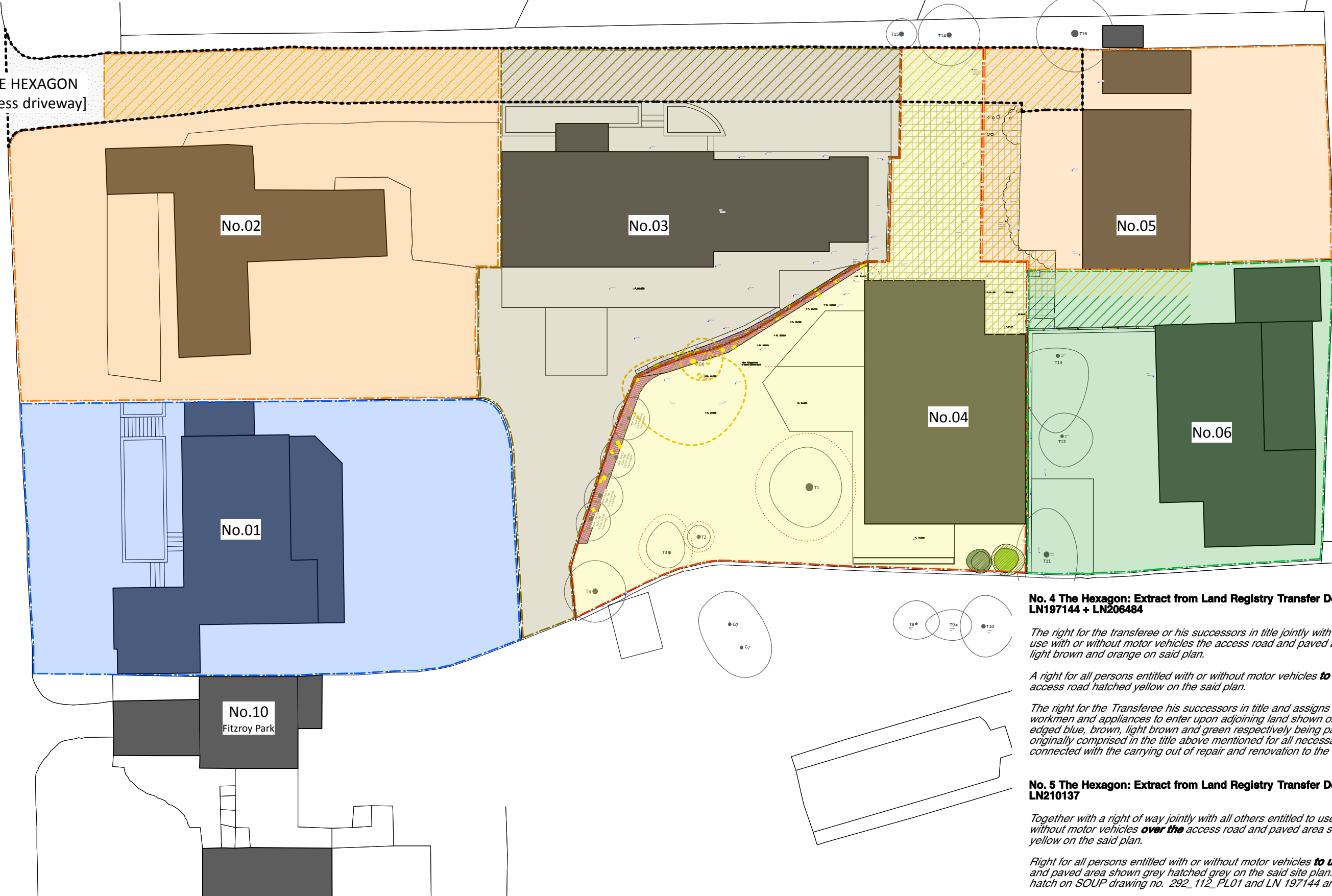

No. 4 The Hexagon: Extract from Land Registry Transfer Deeds ref No's. LN197144 + LN206484

The right for the transferee or his successors in title jointly with all others entitled to use with or without motor vehicles the access road and paved area hatched green, light brown and orange on said plan.

*A right for all persons entitled with or without motor vehicles **to use** that part of the access road hatched yellow on the said plan.*

The right for the Transferee his successors in title and assigns with or without workmen and appliances to enter upon adjoining land shown on the said plan and edged blue, brown, light brown and green respectively being parts of the land now originally comprised in the title above mentioned for all necessary purposes connected with the carrying out of repair and renovation to the said land.

No. 5 The Hexagon: Extract from Land Registry Transfer Deeds ref No's. LN210137

*Together with a right of way jointly with all others entitled to use the same with or without motor vehicles **over the** access road and paved area shown as hatched yellow on the said plan.*

*Right for all persons entitled with or without motor vehicles **to use** the access road and paved area shown grey hatched grey on the said site plan. [indicated as orange hatch on SOUP drawing no. 292_112_PL01 and LN 197144 and LN206484]*