

judd. architecture ltd.



(D)



(A)



(A)



(B)

PHOTO SHEET 1



(D)



(C)



(E)



(F)



(D)



(C)



(G)

Director: **Simon Judd** BSc(Hons), Dip Arch, RIBA

Registered in England No. 5411108
✉: 10 Tonbridge Road, Barming, Maidstone, Kent ME16 9NH
☎: 01622 726 729 e-mail: simon@jas-ltd.com
www.jas-ltd.com

judd. architecture ltd.

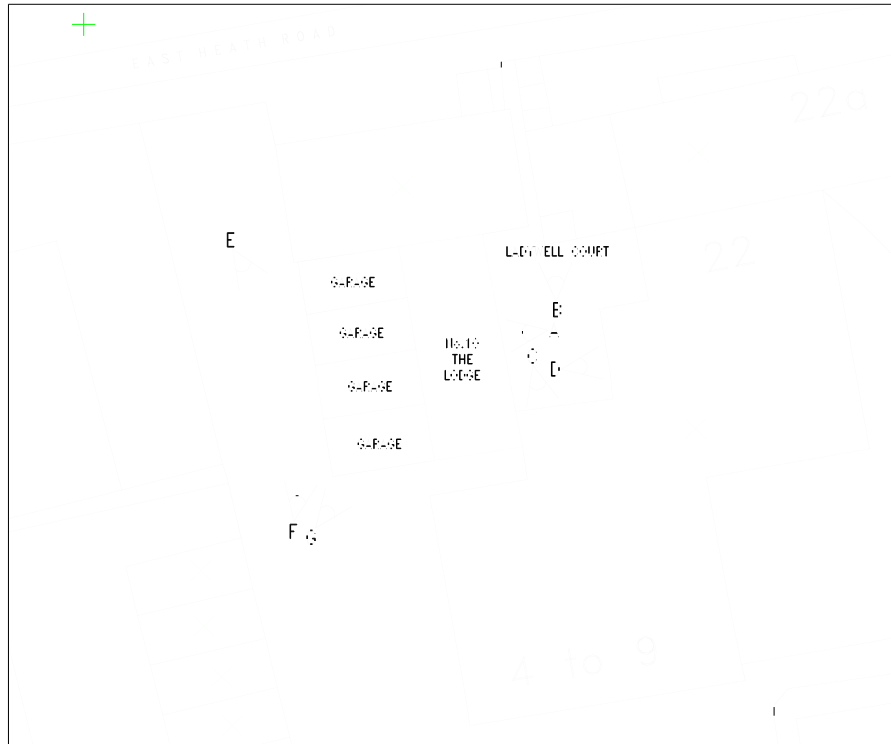

KEY

Director: **Simon Judd** BSc(Hons), Dip Arch, RIBA

Registered in England No. 5411108

✉: 10 Tonbridge Road, Barming, Maidstone, Kent ME16 9NH

☎: 01622 726 729 e-mail: simon@jas-ltd.com

www.jas-ltd.com

PHOTO SHEET 2



Rear view of Ladywell Court showing garage block and high-rise apartment buildings nearby.

Director: **Simon Judd** BSc(Hons), Dip Arch, RIBA

Registered in England No. 5411108

✉: 10 Tonbridge Road, Barming, Maidstone, Kent ME16 9NH

☎: 01622 726 729 e-mail: simon@jas-ltd.com

www.jas-ltd.com

judd. architecture Ltd.

PHOTO SHEET 3



Rear view of Ladywell Court.

Director: **Simon Judd** BSc(Hons), Dip Arch, RIBA

Registered in England No. 5411108

✉: 10 Tonbridge Road, Barming, Maidstone, Kent ME16 9NH

☎: 01622 726 729 e-mail: simon@jas-ltd.com

www.jas-ltd.com

judd. architecture Ltd.

PHOTO SHEET 4



Front View of 10 Ladywell Court.

Director: **Simon Judd** BSc(Hons), Dip Arch, RIBA

Registered in England No. 5411108

✉: 10 Tonbridge Road, Barming, Maidstone, Kent ME16 9NH

☎: 01622 726 729 e-mail: simon@jas-ltd.com

www.jas-ltd.com

judd. architecture Ltd.

PHOTO SHEET 5



View of 10 Ladywell Court and adjoining apartment.

Director: **Simon Judd** BSc(Hons), Dip Arch, RIBA

Registered in England No. 5411108

✉: 10 Tonbridge Road, Barming, Maidstone, Kent ME16 9NH

☎: 01622 726 729 e-mail: simon@jas-ltd.com

www.jas-ltd.com

judd. architecture Ltd.

PHOTO SHEET 6



View of property opposite & 10ft. wall.

Director: **Simon Judd** BSc(Hons), Dip Arch, RIBA

Registered in England No. 5411108

✉: 10 Tonbridge Road, Barming, Maidstone, Kent ME16 9NH

☎: 01622 726 729 e-mail: simon@jas-ltd.com

www.jas-ltd.com