

**SECOND FLOOR REMEDIAL WORKS**  
SCALE 1:50@A3

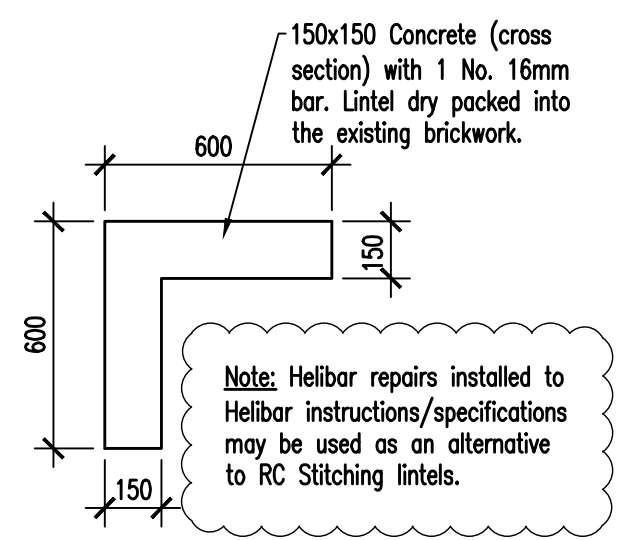

**RC STITCHING LINTEL**  
**DETAIL**  
SCALE 1:20@A3

**NOTES:**

1. All dimensions are in millimetres(mm) & levels in metres(m) unless noted otherwise.
2. Work to indicated dimensions only. Do not scale this drawing.
3. This drawing to be read in conjunction with all relevant Architects, Engineers and Specialists drawings and the specification.
4. All work to comply with the relevant British Standards, Codes of Practice and the Building Regulations.
5. This drawing is to be carefully checked by main contractor against site conditions and any discrepancy reported to KASHEC before construction commences.

**LEGEND:**

- Underpinning Perimeter
- Concrete
- - - Demolition
- ▨ Proposed wall/infill
- Load-bearing

**FOR APPROVAL**

04	30-09-16	Revised as clouded.	AA	PS
03	11-08-16	Revised as per C.W. comments	AA	PS
02	04-08-16	Revised as per A.P. comments	AA	PS
01	29-07-16	Revised as per C.W. comments	LD	VG
00	11-07-16	Issued for Approval	LD	VG
REV	DATE	AMENDMENT	BY	CHK APPR

COPYRIGHT © KASHEC 2004

**KASHEC** MARKET HILL, ROYSTON HERTFORDSHIRE SG8 9JN UK  
TEL: +44 (0) 01763 247131 FAX: +44 (0) 01763 247029

PROJECT  
11 PRINCE ALBERT ROAD

CLIENT  
HARRISON VARMA

TITLE  
SECOND FLOOR REMEDIAL WORKS

DRAWN LD	CHECKED VG	APPROVED PS	DATE 06-07-16	SCALE 1:50
-------------	---------------	----------------	------------------	---------------

DRG. NO. K1914/12 REVISION 04