

s a n d r o

31 Higt Street HAMPSTEAD, NW3 LONDON

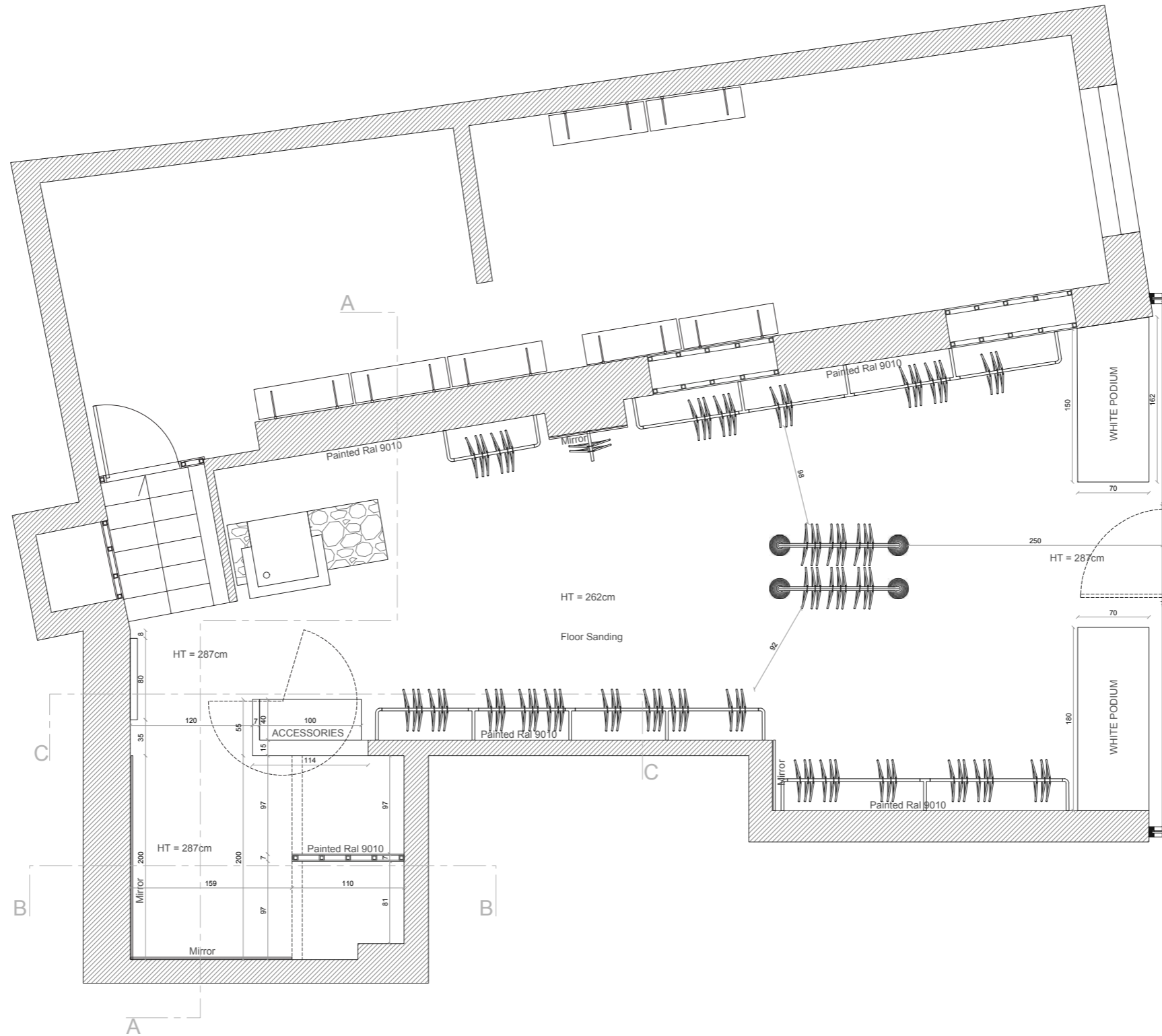

The existing facade is retained.  
 The existing structure of the windows and door in black repainted (RAL ref. black brown n°8022).  
 The frontage repainted in Farrow & Ball ref. 2003.

# PROJECT PLAN

The coasts are given as indicative. Company executants work will check on site.

0 500 1000 2000  
millimeters

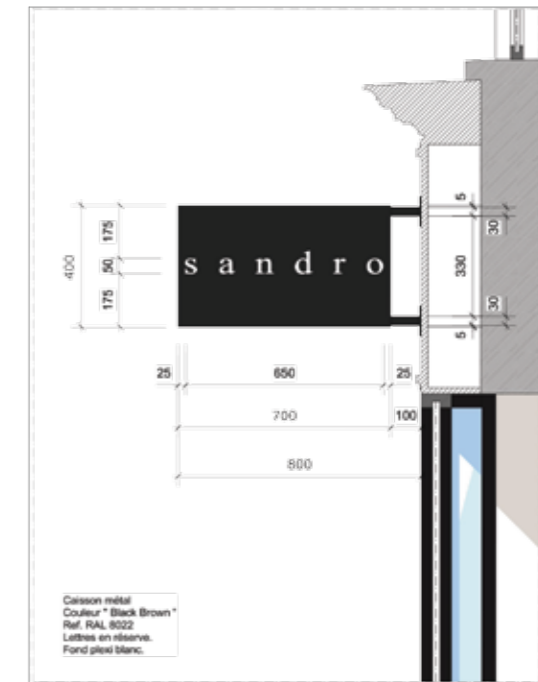

EXISTING FRONT ELEVATION

s a n d r o

49, rue Etienne Marcel  
75001 PARIS  
00 (33) 1 55 80 51 00  
00 (33) 7 52 60 20 48  
Email : pearl.minos@smcp.com

Project : SANDRO - 31, High Street Hampstead, NW LONDON

Create on : August 25, 2016

Modifié le :

Surface : 101.00m<sup>2</sup>

Sales area : 41m<sup>2</sup>

Scale : 1/25

Linear : 11,00 ml

The coasts are given as indicative. Company executants work will check on site.

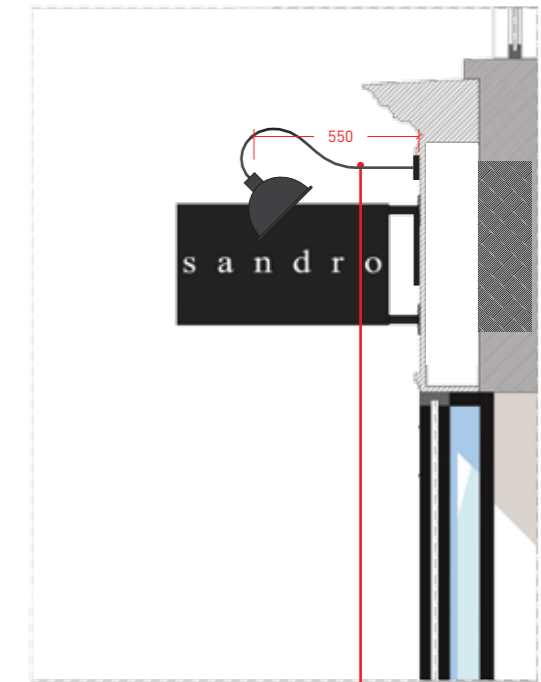

LED spotlights  
to lit the fascia signs  
installed on 550 mm brackets  
color: black  
light power: 250 cd/m

## FITTING-OUT FRONT ELEVATION

s a n d r o

49, rue Etienne Marcel  
75001 PARIS  
00 (33) 1 55 80 51 00  
00 (33) 7 52 60 20 48  
Email : pearl.minos@smcp.com

Project : SANDRO - 31, High Street Hampstead, NW LONDON

Create on : October 18, 2016

Modifié le :

Surface : 101.00m<sup>2</sup>

Sales area : 41m<sup>2</sup>

Scale : 1/25

Linear : 11,00 ml

The coasts are given as indicative. Company executants work will check on site.



EXISTING STORE FRONT



FITTING-OUT STORE FRONT PROJECTION

s a n d r o

49, rue Etienne Marcel  
75001 PARIS  
00 (33) 1 55 80 51 00  
00 (33) 7 52 60 20 48  
Email : pearl.minos@smcp.com

Project : SANDRO - 31, High Street Hampstead, NW LONDON

Create on : October 18, 2016

Modifié le :

Surface : 101.00m<sup>2</sup>

Sales area : 41m<sup>2</sup>

Scale : 1/50

Linear : 11,00 ml

The coasts are given as indicative. Company executants work will check on site.