

1 BASEMENT LEVEL
SCALE - 1:100 @ A3

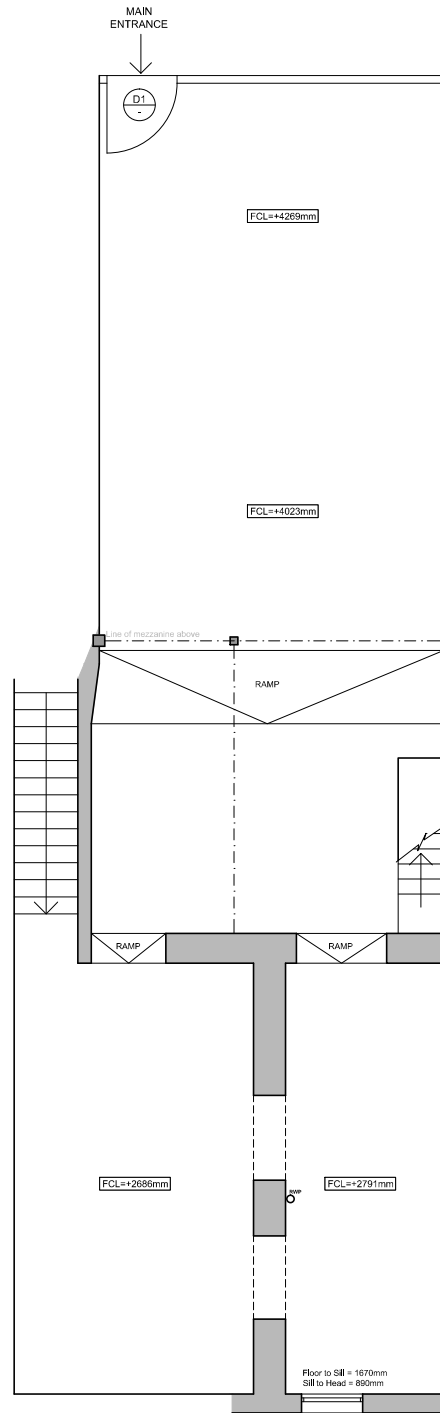

2 GROUND LEVEL
SCALE - 1:100 @ A3

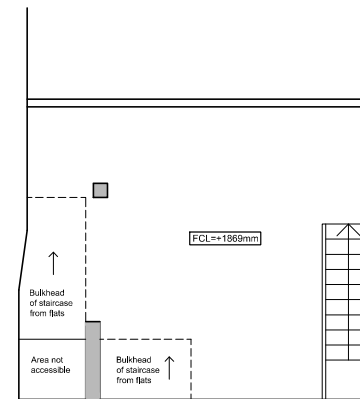

3 MEZZANINE LEVEL
SCALE - 1:100 @ A3



GENERAL NOTES

- THIS DRAWING IS THE PROPERTY OF LXA, PO BOX NO: 283639, DUBAI. IT IS FORBIDDEN TO PRODUCE ITS CONTENTS IN ANY FORM, EXCEPT FOR THE INTENDED PURPOSE
- THIS DRAWING IS NOT TO BE SCALED. THE DIMENSIONS ARE IN MILLIMETERS UNLESS OTHERWISE SPECIFIED
- ANY DISCREPANCIES ARE TO BE BROUGHT TO THE ATTN OF LXA AND RESOLVED BEFORE THE COMMENCEMENT OF ANY WORK
- THIS DRAWING IS TO BE READ IN CONJUNCTION WITH RELEVANT DETAIL DRAWINGS AS MENTIONED IN THE DRAWING
- CONTRACTOR TO CONSTRUCT A MOCKUP FOR APPROVAL OF FINISHES & DETAILS, AND GET A SIGN OFF FROM CLIENTS & ARCHITECTS
- THIS DRAWING TO BE READ IN TANDEM WITH THE DETAILS/SCHEDULES/SPECIFICATIONS AS REQUIRED

KEYPLAN

REVISIONS

No.	Date	By	Issue/Revision Details
A	22/08/2016	MJS	Updated following site strip-out



LXA London
Hatfield House
52-54 Stamford Street
London, SE1 9LX
T. +44 (0)20 7645 3340
F. +44 (0)20 7645 3341
E. info@WeAreLXA.com
W. www.WeAreLXA.com

DRAWING TITLE :
EXISTING PLAN

PROJECT :
**FINE ARTS COLLEGE
NW3 4YD**

CLIENT :
FINE ARTS COLLEGE

Rev No: **A** Date: **23.03.16**

Drawn: **MJS** Checked: **DR** Approved: **DR**

Scale: **1:100@A3** Drawing No. **LXA-1228-FAC-010**