

notes
 Do not scale from drawing
 Drawing indicates design intent only
 Any subsequent approvals do not release the trade obligations under the trade contract
 The trade contractor is responsible for taking and checking site dimensions
 Report all conflicts of information to the Architect
 If in doubt ask

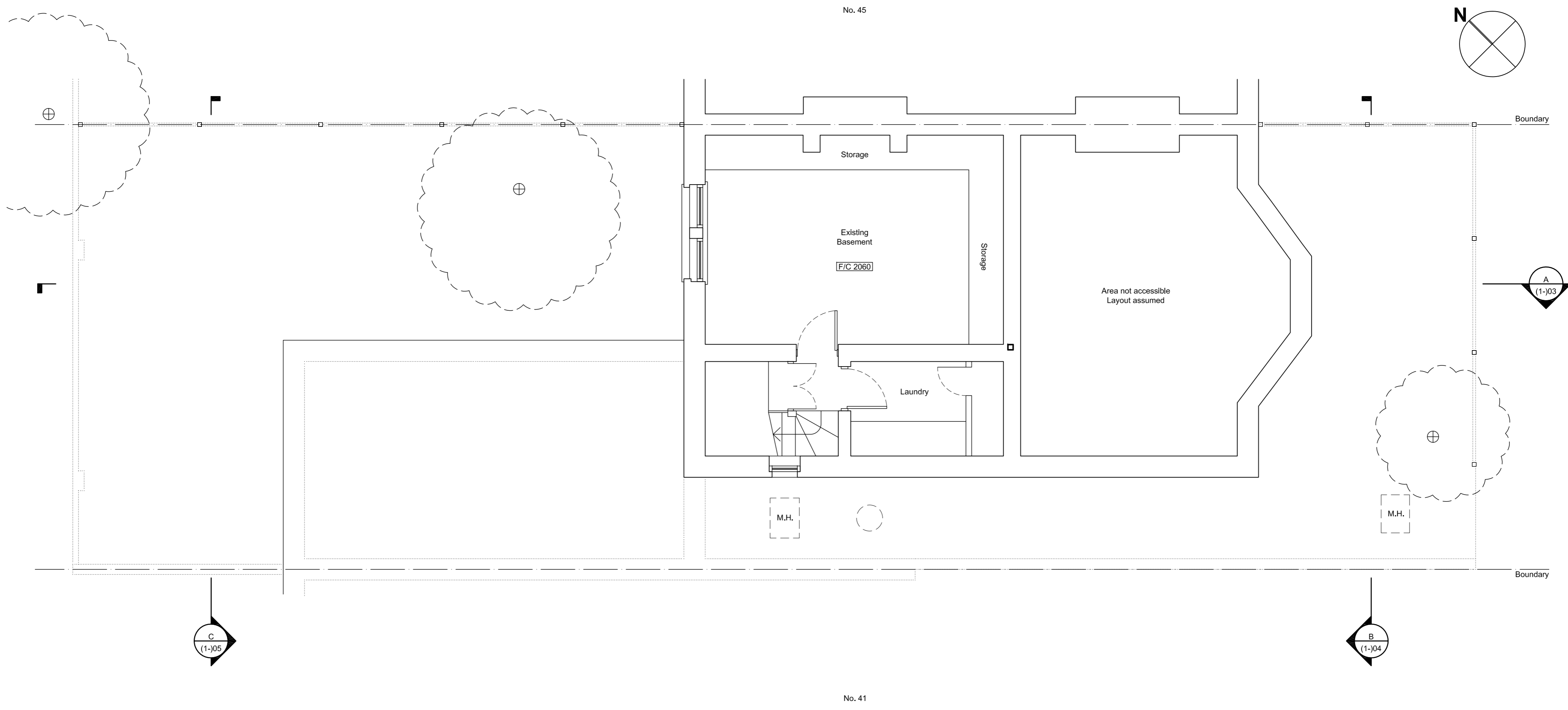

FOR PLANNING APPLICATION ONLY

| rev: | description: | date: |
|------|--------------|-------|
| | | |

client

43 CROFTDOWN ROAD
 LONDON
 NW5 1EL

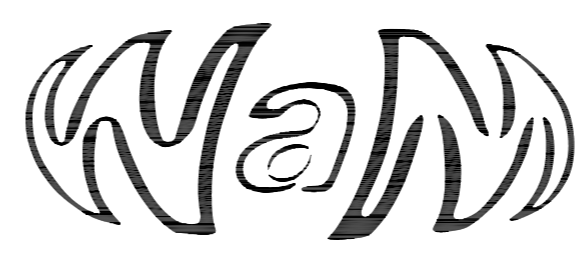

walker + martin
 architecture + interior design
 morelands building, 9-15 old st.
 london ec1v 9hl
 t 0207 253 8624 f 0207 253 8625
 www.walkerandmartin.co.uk

| title | | | |
|---|------------|-----------------|----------|
| EXISTING BASEMENT PLAN | | | |
| dwg status | date | job no | |
| <input checked="" type="checkbox"/> information | 26.11.2015 | 21525 | |
| <input type="checkbox"/> tender | scale | drawing no | revision |
| <input type="checkbox"/> construction | 1: 50@A2 | pl(1-01) | |
| <input type="checkbox"/> as built | | | |