

1 Ground Floor Plan

1 : 50

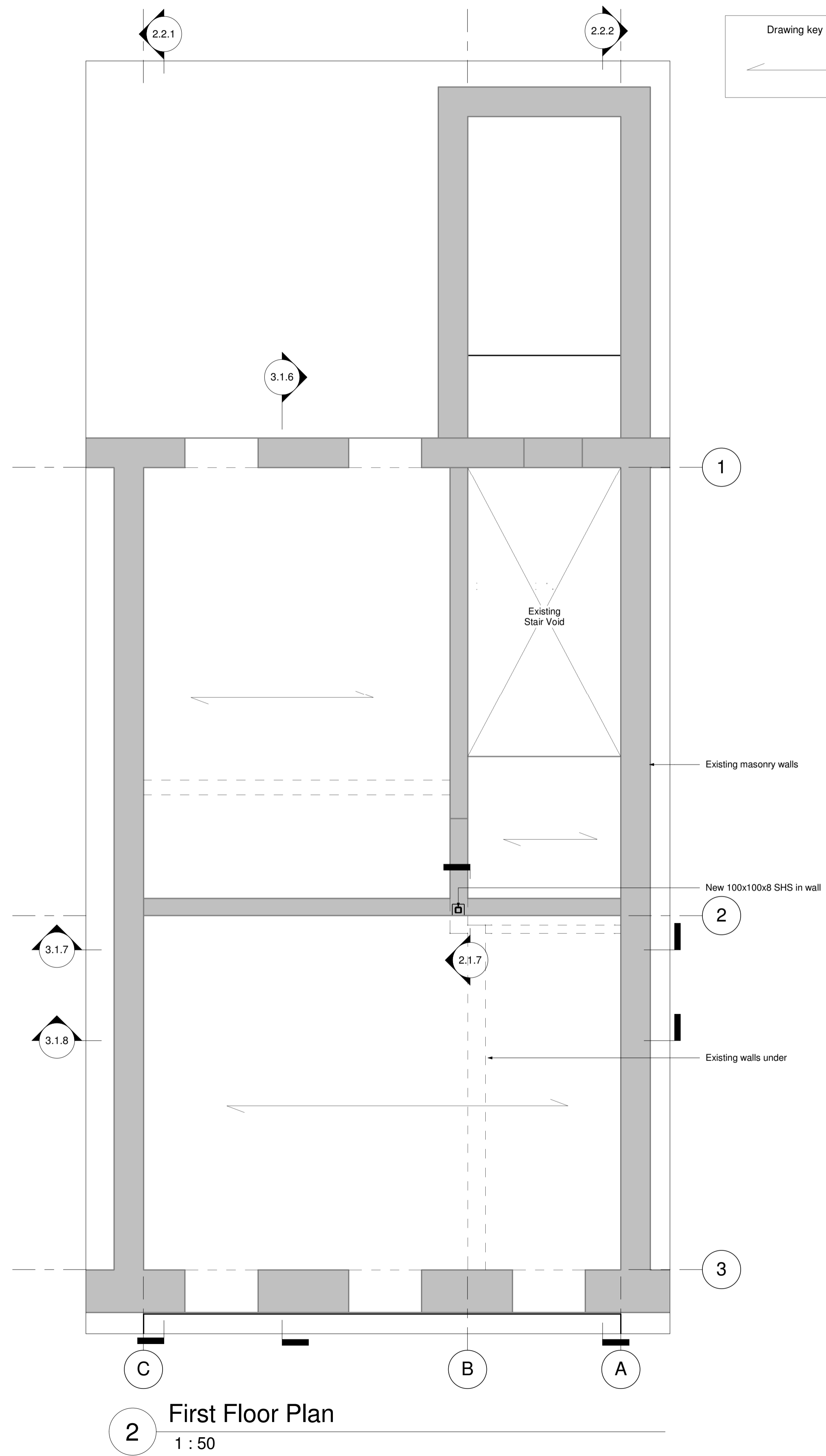

2 First Floor Plan

1 : 50

General Notes

- G.1 This drawing is to be read in conjunction with all relevant Engineer's drawings and specifications.
- G.2 Do not scale from a paper or digital version of this drawing. Use written or stated dimensions only.
- G.3 All floors are designed in accordance with the loadings as follows :-  
 - General Imposed = 2.5kN/m<sup>2</sup> OR 2.7 kN Concentrated load  
 - Non-Structural Partitions = 0.6kN/m<sup>2</sup>.
- G.4 All grout to be sand / cement with Cebex 100 additive by Fosroc Ltd. Alternatively, Conbextra GP ready-mixed grout by Fosroc can be used.
- G.5 All dry pack mortar is to comprise a 1:3 cement:sand mix, with only enough water to form a hand moldable paste. Dry pack mortar to be rammed into the void between the steel or precast concrete beams/needles/lintels and existing masonry wall, and is to fill the entire zone.

Steelwork Notes

- S.1 All steelwork is to be Grade S275 and all bolts are to be Grade 8.8 unless noted otherwise.
- S.2 All bolts are to be hot dip galvanized to BS7371 part 6 unless noted otherwise.
- S.3 All other steelwork is to be painted off site as follows :-  
 - Blast clean to Sa 2 1/2  
 - Paint with 75 µm dft two pack epoxy zinc phosphate primer.  
 - Decorative coat to Architects specification if required.
- All paints / finishes to be by W & J Leigh & Co or similar approved. Product references are noted thus (L653).
- S.4 Where steelwork and associated plates are specified on the drawings as galvanized these are to be Hot Dip Galvanized to BS EN ISO 1461.
- S.5 All steel bearing onto padstones to have 75mm minimum bearing.
- S.6 The Contractors attention is drawn to clause 4.1.10.3 of the Specification for Steelwork regarding the placement of rolling marks on exposed steelwork.
- S.7 Fabrication drawings for all steelwork are to be prepared by the Contractor, in accordance with the Specification for steelwork, unless otherwise agreed.
- S.8 All steel beams may be spliced if required for installation. The Contractor design must be submitted for approval by the contract administrator. All bolts to be H.S.F.G. with load indicating washers & splice designed for ultimate resistance of beam section.

Timber Notes

- T.1 All timber is to be Grade C24 to BS 5268, and is to have a maximum moisture content of 18% at the time of erection. After erection it is to be protected to maintain this moisture content.
- T.2 All steel fixings used in association with structural timber are to be hot dip galvanized to BS729.
- T.3 All joists to have continuous blocking each end and at mid-span.
- T.4 All Studwork (new and existing) to have noggins at 900 vertical c/c.

Notes

- G.1 This drawing is to be read in conjunction with all relevant Architects and Engineers drawings and specifications. Do not scale from a paper or digital version of this drawing. Use written or stated dimension only.
  - G.2 Do not scale from a paper or digital version of this drawing. Use written or stated dimension only.
  - G.3 For general notes refer to drawing 15/137/1.2
- This drawing is the copyright of Barton Engineers & may not be copied, altered or reproduced in any way or passed to a third party without their written authority.

**Preliminary**  
**Not for Construction or**  
**Tendering**

Issues / Revisions  
 P1 Issued for Coordination 140916 WK

**Barton Engineers**

Unit 303 Westbourne Studios, 242 Aclam Road, London W10 5JJ  
 telephone +44(0)20 7631 0348  
 mail@bartonengineers.co.uk  
 http://www.bartonengineers.co.uk

Project  
**27 Russell Square**

Title  
**Ground And First Floor Plan**

Scales 1:50

Designed by  
**Rosie Stevenson**  
 Drawn by  
**Waldemar Kurpias**  
 Drawing number  
**15/137/1.4**

Checked by  
**Bob Barton**  
 Rev  
**P1**