

Right of Light Consulting

Burley House
15-17 High Street
Rayleigh
Essex
SS6 7EW

TEL 0800 197 4836

E-MAIL enquiries@right-of-light.co.uk

WEBSITE www.right-of-light.co.uk

By Email

Ben Shaw
John Rowan and Partners
Craven House
40 Uxbridge Road
London
W5 2BS

28 September 2016

Dear Mr Shaw

BRE Daylight and Sunlight Study – Redevelopment at West End Lane, London NW6 1SD

Our letter of 4 August 2016 included overshadowing images for 6pm and 8pm on 21 June to illustrate the shadowing that the proposed development would create on the adjacent MUGA to the east of the site as well as the Crowne Close Open Space. Following this letter, we have now been asked by the Local Authority to produce the same images for the 21 March & 21 September. The images are enclosed.

You will note that the images for 6pm and 8pm on the 21 March and 8pm on the 21 September are completely black. This is because the sun is at or below the horizon during these times. The sun sets at around 6pm on 21 March and 7pm on the 21 September taking into account daylight savings.

I hope the above is useful and please do not hesitate to come back to me if you have any queries.

Yours sincerely,



Matthew Jones MGeol (Hons)
Right of Light Surveyor

Enc. Existing/Proposed Overshadowing Images (6pm & 8pm on 21 March & 21 September).

Shadow Analysis

156 West End Lane Shadow Analysis 6pm & 8pm on 21 September

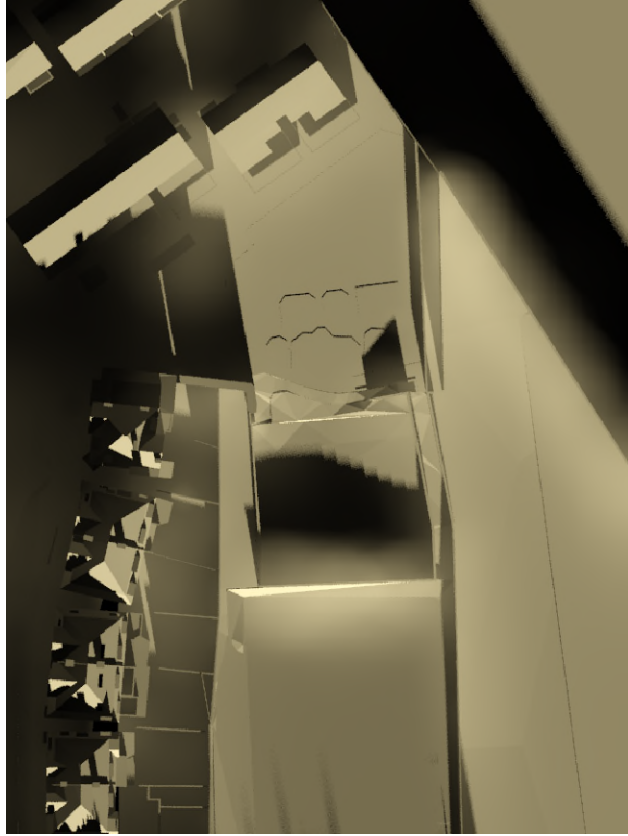

21st September 6pm Existing

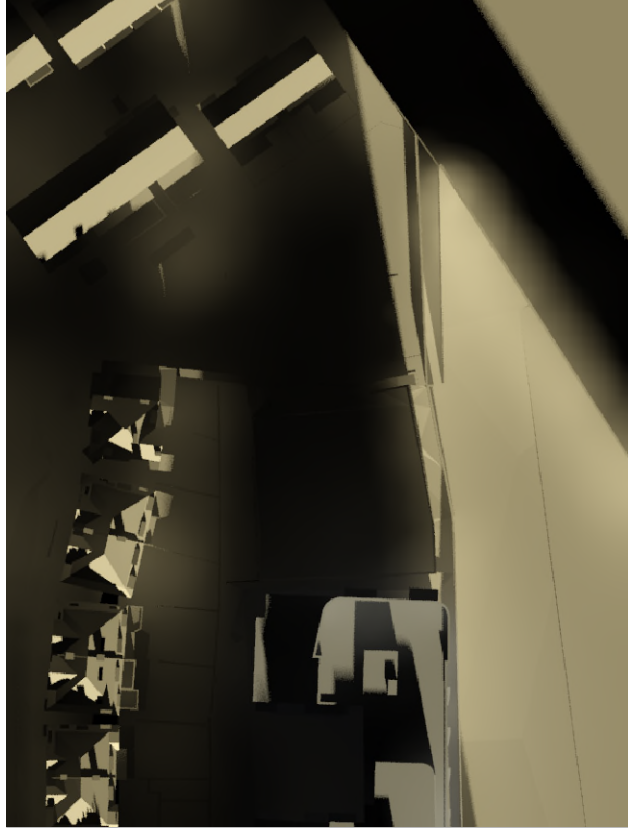

21st September 6pm Proposed

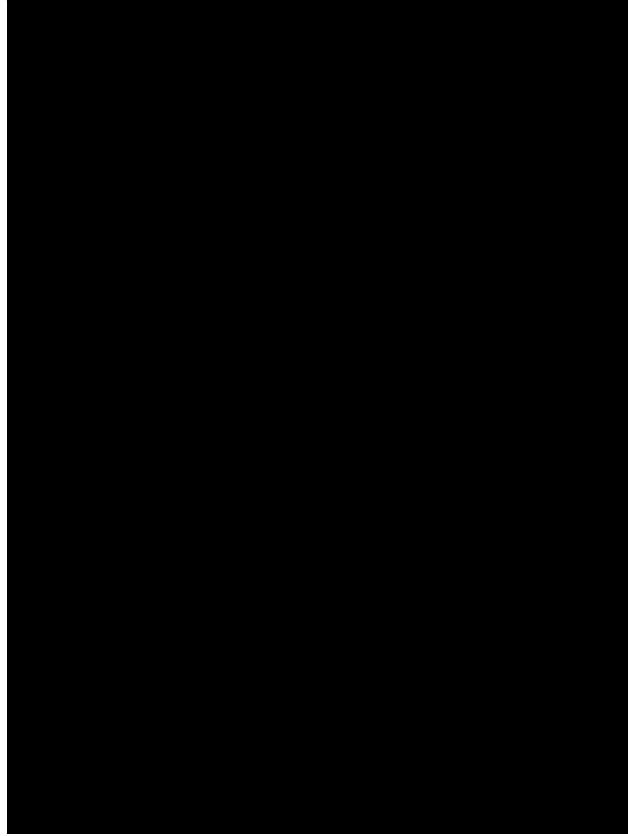

21st September 8pm Existing



21st September 8pm Proposed

Notes:

Project Name: 156 West End Lane

Drawing Title: Shadows at 6pm & 8pm on 21st September

Scale: Do not scale

Drawing No: 1001

Rev: -



Right of Light Consulting
Burley House
15-17 High Street
Rayleigh
Essex SS6 7EW

Tel: 0800 137 4836

enquiries@right-of-light.co.uk
www.right-of-light-consulting.com

Shadow Analysis

156 West End Lane
Shadow analysis 6pm & 8pm on 21 March

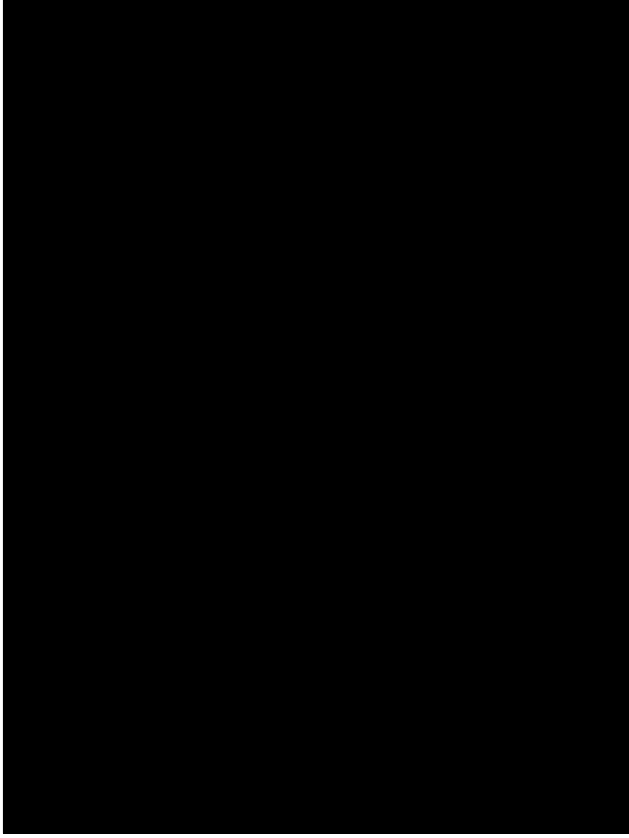

21st March 6pm Existing

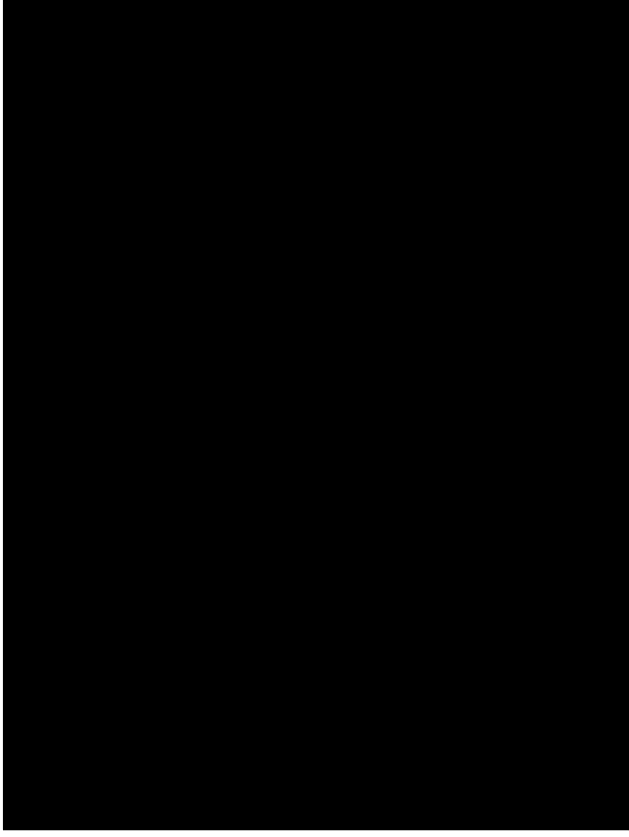

21st March 6pm Proposed

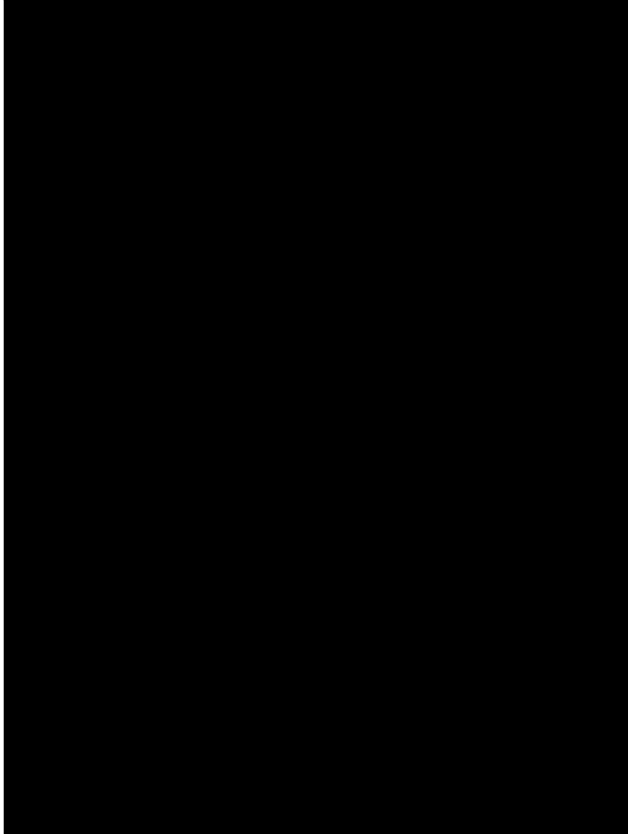

21st March 8pm Existing



21st March 8pm Proposed

Notes:

Project Name: 156 West End Lane

Drawing Title: Shadows at 6pm & 8pm on 21st March

Scale: Do not scale

Drawing No: 1001

Rev: -



RIGHT OF LIGHT
CONSULTING
Chartered Surveyors

Right of Light Consulting
Burley House
15-17 High Street
Rayleigh
Essex SS6 7EW

Tel: 0800 137 4836

enquiries@right-of-light.co.uk
www.right-of-light-consulting.com