

**7A** PROPOSED FIRST FLOOR PLAN

SCALE 1:100

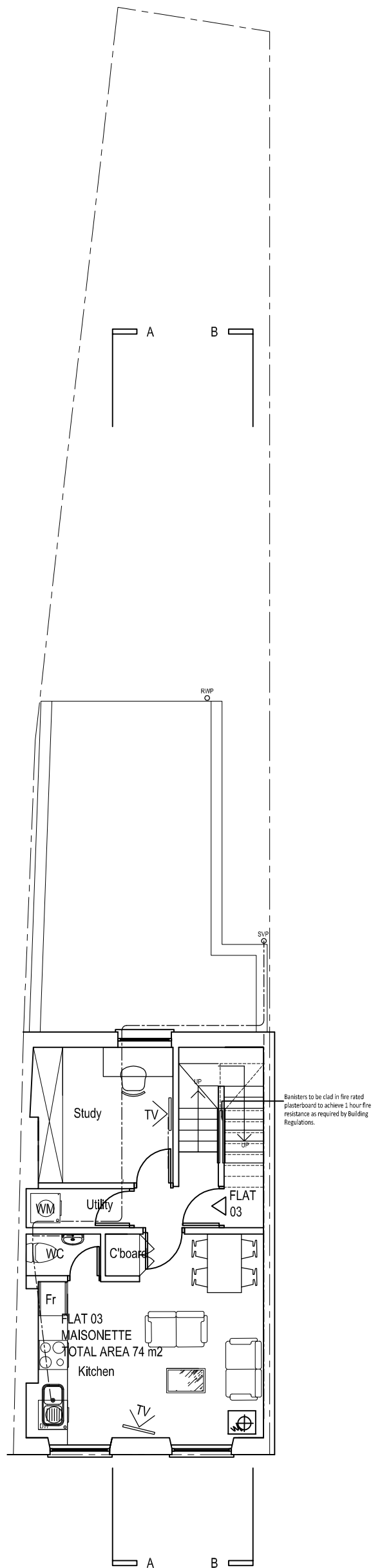
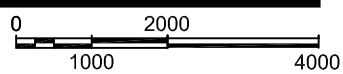

**7C** PROPOSED SECOND FLOOR PLAN

SCALE 1:100

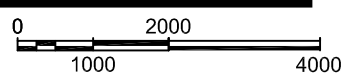

Benisters to be clad in fire rated plasterboard to achieve 2 hour fire resistance as required by Building Regulations.

Modern door removed, opening blocked but original architrave retained and replicated for all new door openings

**Koupparis Associates**  
0207 267 6909/6874

Drawing Title  
**Proposed First and Second Floor Plans**

Address  
**24 Camden Road, London, NW1 9DP**

Client  
**Christ-and-Yioula Limited**

Project Number	16-0175	Drawing Number	
Scale	1:100@(A3)	Sheet No.	16-175-03
Date	26/09/16	Rev.	-
Revised	-		

Status  
-