



01 BLOCK M/ ELEVATION- SOUTH WEST COMMUNAL GARDEN



02 BLOCK M/ ELEVATION- SOUTH EAST



03 BLOCK M / ELEVATION- NORTH EAST KIDDERPORE AVENUE



04 BLOCK M/ ELEVATION- NORTH WEST

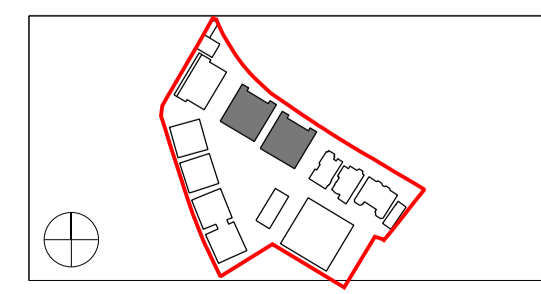

Do not scale from this drawing. Use figured dimensions only. Figured dimensions are in millimetres. All levels are in metres. All dimensions and levels shall be verified on site before proceeding with works. Detailed site survey to be carried out to verify positions and level relationships with site features and ordnance survey. Boundaries are indicative only and are to be verified by others. The architect must be notified of any discrepancy. Where building components are described in the specification as contractor designed, "construction" information relating to those components on this drawing represents design intent only.

REV	DATE	DESCRIPTION	CKD	REV	DATE	DESCRIPTION	CKD
P1	03.03.2015	ISSUED FOR COORDINATION	NR				
P2	24.07.2015	ISSUED FOR APPROVAL	NR				
T1	18.09.2015	ISSUED FOR TENDER	NR				
C1	10.03.2016	ISSUED FOR CONSTRUCTION	NR				
C2	12.05.2016	ISSUED FOR CONSTRUCTION	AS				

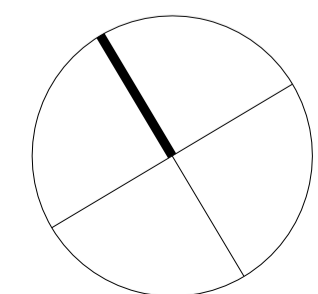

Allies and Morrison
 85 Southwark Street
 London SE1 0HX
 telephone 020 7921 0100
 facsimile 020 7921 0101
 email info@alliesandmorrison.co.uk
 A&M JOB NO: 809

KIDDERPORE AVENUE: BLOCK M
 ELEVATIONS
 GENERAL ARRANGEMENT
 809_07_06_210
 SCALE: 1:100 @A1 1:200 @A3

C2
 Revision