

- 1 ALL EXISTING FIREPLACES TO BE RETAINED AND SURROUNDS SPECIFIED AND INSTALLED AS PER CONSERVATION OFFICERS RECOMMENDATION
- 2 ALL SHUTTERS CURRENTLY BOXED IN PAINTED SHUT TO BE RESTORED TO WORKING ORDER AS PER CONSERVATION OFFICERS RECOMMENDATION
- 3 CEILING ROSE TO BE REPLACED TO MATCH ORIGINAL AS PER CONSERVATION OFFICERS RECOMMENDATION
- 4 SKIRTING AND CORNICING TO BE REINSTATED AS PER ORIGINAL FEATURES ACCORDING TO CONSERVATION OFFICERS RECOMMENDATION
- 5 NEW CONTEMPORARY FEATURE LIGHTING IN HALLWAY AND STAIRWELL
- 6 CONTEMPORARY AND UNOBTRUSIVE ACCESS SYSTEM AND MAIL BOXES FIXED TO WALLS WITHIN ENTRANCE PORCH

- 7 FLOOR JOISTS TO BE STRENGTHENED LOCALLY AND REPLACED WHERE REQUIRED TO RESTORE STRUCTURAL INTEGRITY AND TAKE NEW LOADS
- 8 NEW ACOUSTICALLY INSULATED WIDE PLANK ENGINEERED TIMBER FLOORING
- 9 ALL WALLS TO BE SKIMMED AND PAINTED IN HERITAGE APPROVED PAINT RANGE COLOUR TBC
- 10 ORIGINAL STONE STAIRCASE TO BE RESTORED IN ACCORDANCE WITH CONSERVATION OFFICERS RECOMMENDATION
- 11 CARPET ON STAIRCASE TO BE REPLACED WITH NEW ACOUSTICALLY INSULATED ENGINEERED TIMBER FLOORING
- 12 NEW BRICK CLOSET WING WITH SLATE ROOF TO MATCH EXISTING ADJOINING BUILDING

- 13 EXCAVATED ARCHES WITH LOWERED GROUND TO ACCOMMODATE BIN AND BIKE STORE
- 14 NEW LIMESTONE FLAGSTONES
- 15 TIMBER SEATING AND PLANTERS TO REAR COURTYARD WALL
- 16 NEW MOSAIC TILING PATTERN TBC IN ACCORDANCE WITH CONSERVATION OFFICERS RECOMMENDATION INKEEPING WITH ADJOINING BUILDING
- 17 EXISTING STONE STEPS AT ENTRANCE TO BE RESTORED
- 18 ALL ORIGINAL SASH WINDOWS AND TIMBER SHUTTERS TO BE MADE GOOD, REPAIRED AND WHERE REQUIRED REPLACED TO MATCH EXISTING AS PER CONSERVATION OFFICERS RECOMMENDATION

- 19 ROOF TO BE RECONSTRUCTED - ALL ORIGINAL SLATES TO BE REJULZED, TIMBER STRUCTURE REPLACED AND POOR QUALITY ROOFING FELT REPLACED WITH LEAD SHEETING
- 20 NEW TIMBER ENTRANCE DOORS TO REPLACE POOR QUALITY EXISTING SET PAINTED BLACK INKEEPING WITH THE REST OF THE TERRACE
- 21 FANLIGHTS ABOVE ENTRANCE DOORS TO BE RESTORED IN ACCORDANCE WITH CONSERVATION OFFICERS RECOMMENDATION
- 22 NEW CAST IRON RAINWATER PIPES INKEEPING WITH EXISTING
- 23 NEW WHITE PAINTED CASEMENT RECESSED DORMER WINDOWS WITH LEAD CHECKS IN KEEPING WITH THE CHARACTER OF THE TERRACE
- 24 NEW OPENING IN REAR FACADE AT LOWER GROUND LEVEL TO ACCOMMODATE NEW BLACK ALUMINIUM FRAME SLIDING DOORS

- 25 ALL RAILINGS AND BALUSTRADING TO LIGHTWELL AND EXTERNAL STAIRCASE TO BE REPAIRED AND PAINTED GLOSS BLACK TO MATCH ORIGINAL
- 26 ALL EXISTING BRICK TO BE CLEANED REPAIRED AND REPOINTED AS REQUIRED AND RESTORED TO ORIGINAL CONDITION
- 27 EXISTING CAST-IRON BALCONY TO BE REPAIRED AND RESTORED TO ORIGINAL CONDITION
- 28 NEW LONDON STOCK BRICKWORK, Laid IN FLEMISH BOND AND SOOTWASHED TO MATCH EXISTING
- 29 NEW DOUBLE GLAZED TIMBER SASH WINDOWS, PAINTED BLACK EXTERNAL FINISH TO MATCH EXISTING
- 30 NEW MASONRY WALL WITH WHITE RENDER FINISH

- 31 EXCAVATION OF LOWER GROUND FLOOR TO COMBAT DAMP AND PROVIDE ADEQUATE FLOOR BUILDUP
- 32 NEW FIRE-RATED ACOUSTICALLY INSULATED TIMBER CLAD ENCLOSURE CONTAINING KITCHEN AND BATHROOM ACCOMMODATION FLUSH FINISH WITH CONCEALED FIXINGS
- 33 NEW FIRE-RATED TIMBER DOOR SETS TO MATCH EXISTING, PANELLING AND IRONWORKERY AS PER CONSERVATION OFFICERS RECOMMENDATION
- 34 NEW FIRE-RATED ACOUSTICALLY INSULATED STUD PARTITION WALL
- 35 NEW FIRE-RATED FRAMELESS TIMBER DOOR SETS FLUSH WITH WALL
- 36 NEW CONTEMPORARY TIMBER STAIRCASE
- 37 RISER FOR ALL PLUMBING AND ELECTRIC SERVICES

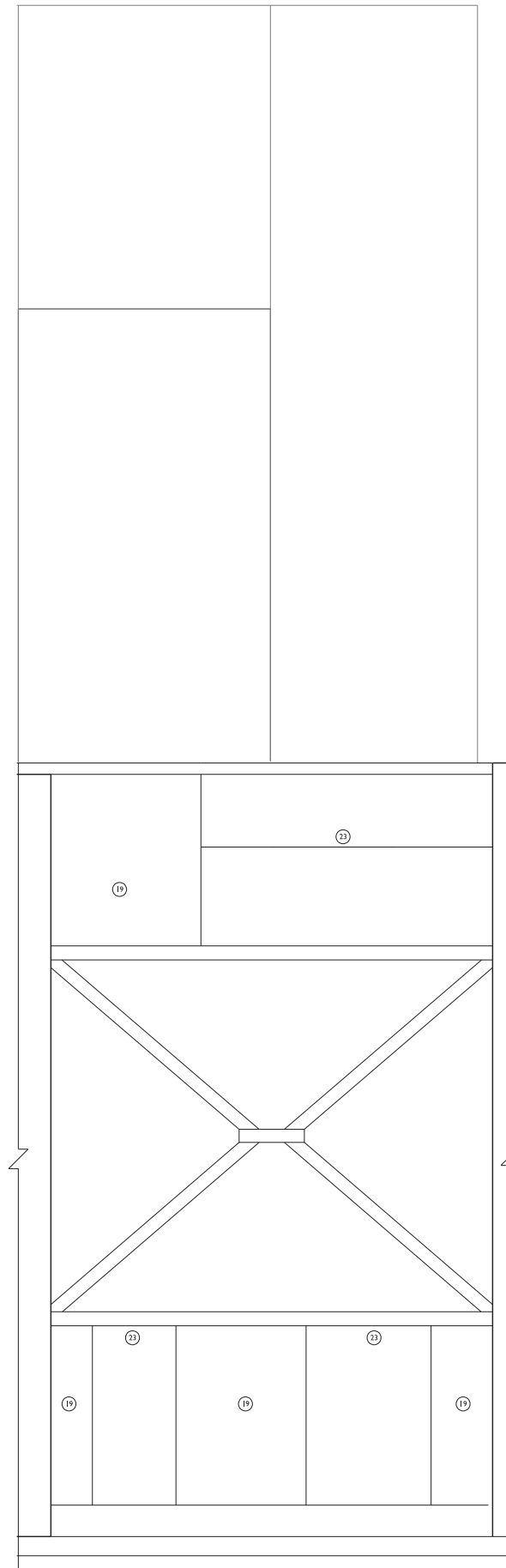

PROPOSED ROOF PLAN

**OOK ARCHITECTS**  
 35 Marylebone High St  
 London W1U 4QA  
 ORLA O'KANE ARB MR1A1  
 T +44 (0)7887 861 633  
 studio@ookarchitects.com  
 www.ookarchitects.com

REVISION / DESCRIPTION	DRAWN	CHECKED	DATE
INITIALS - RH	OOK	OOK	21.08.13

0 0.5 1 2 3 4 5m.  
SCALE

**NOTES**

KEY

ORLA O'KANE SHALL HAVE NO RESPONSIBILITY FOR ANY USE MADE OF THIS DOCUMENT OTHER THAN FOR THAT WHICH IT WAS PREPARED AND ISSUED. ALL DIMENSIONS SHOULD BE CHECKED ON SITE. DO NOT SCALE FROM THIS DRAWING. ANY DRAWING ERRORS OR DIVERGENCES SHOULD BE BROUGHT TO THE ATTENTION OF ORLA O'KANE.

PROJECT TITLE		67 GUILFORD STREET	
DRAWING TITLE	SCALE	1:100 @ A3	
STATUS	DATE	15.02.13	
PROJECT NUMBER	DRAWING No.	519	519-PL-113
REVISION	P01		