

London 16 Lambton Place Notting Hill  
 London W11 2SH T +44 (0)20 7229 3125  
 Oxford Chandos Yard 83 Bicester Road  
 Long Crendon HP18 9EE T +44 (0)1844 203310  
 W www.wolffarchitects.co.uk E info@wolffarchitects.co.uk  
 This drawing is protected under Copyright and at no time should any  
 portion be reproduced or copied without the permission of the  
 Architect (Design Copyright Act 1968).  
 It must not be used for purposes other than that for which it is  
 provided. It is supplied without liability for any errors or omissions.  
 All dimensions to be checked on site.

Rev.	Description	Date	Rev.	Description	Date
0	First issue.	28.09.16			

Project Title  
**Avenue Road, 16**

Drawing Title  
**Proposed Basement Demolition Plan**

Status  
**Feasibility**

Scale  
 1:200 @ A3

Project No. 1611 - FE - 011 - 0

Work Stage FE

Dwg. No. 011

Rev. 0

Drawn by

Checked by



34-44 AVENUE CLOSE

Retain existing garden shed

Proposed Demolitions

14E & 14F AVENUE ROAD

Remove existing enclosure

20-33 AVENUE CLOSE

14C & 14D AVENUE ROAD



WOLFF ARCHITECTS

London 16 Lambton Place Notting Hill London W11 2SH T +44 (0)20 7229 3125

Oxford Chandos Yard 83 Bicester Road Long Crendon HP18 9EE T +44 (0)1844 203310

W www.wolffarchitects.co.uk E info@wolffarchitects.co.uk

This drawing is protected under Copyright and at no time should any portion be reproduced or copied without the permission of the Architect (Design Copyright Act 1968).

It must not be used for purposes other than that for which it is provided. It is supplied without liability for any errors or omissions. All dimensions to be checked on site.

Rev.	Description	Date	Rev.	Description	Date
0	First issue.	28.09.16			

Project Title  
Avenue Road, 16

Drawing Title  
Proposed Ground Fl. Demolition Plan

Status	Drawn by	Checked by
Feasibility		

Scale	Project No.	Work Stage	Dwg. No.	Rev.
1:200 @ A3	1611	FE	012	0



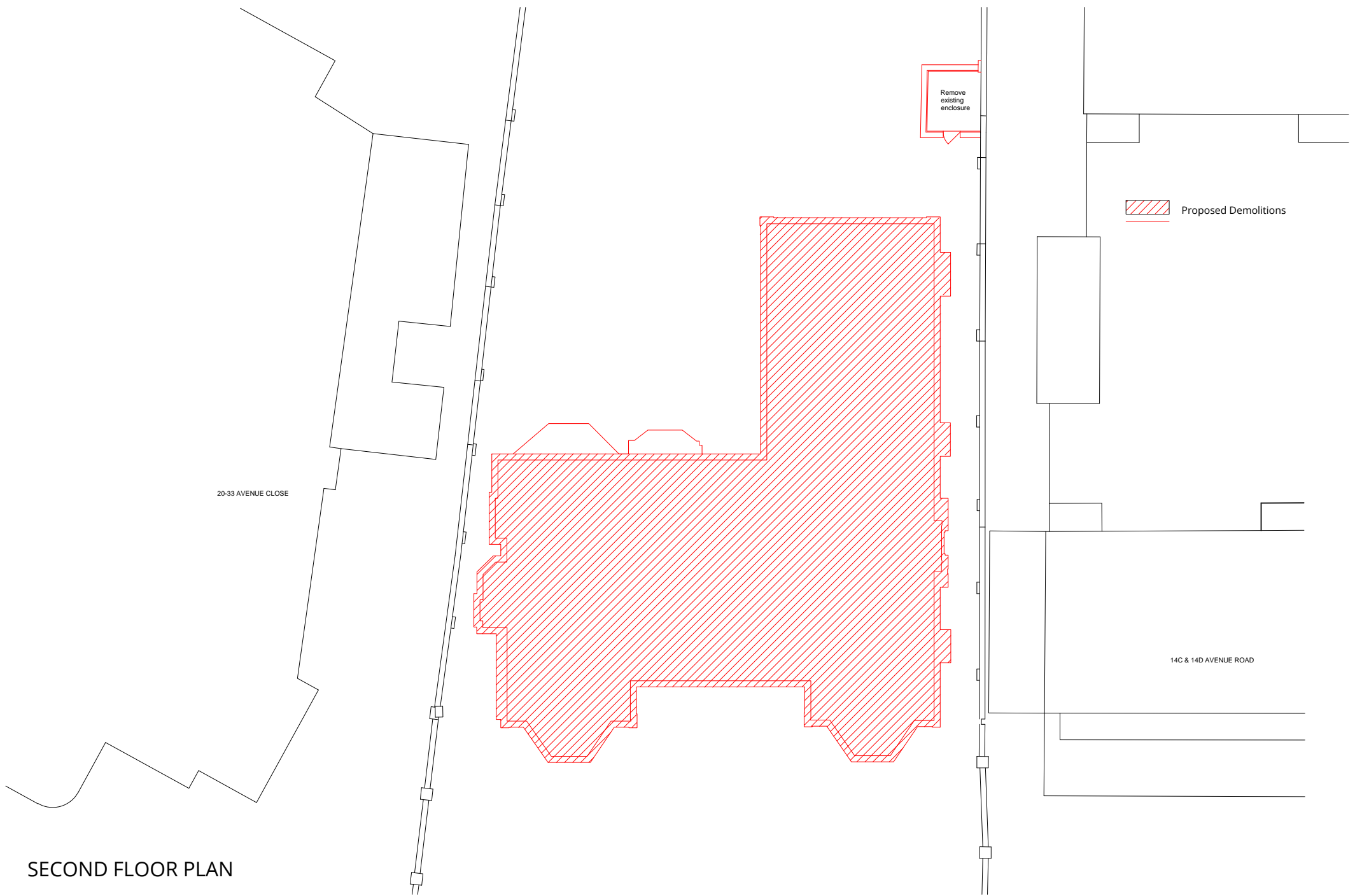

SECOND FLOOR PLAN

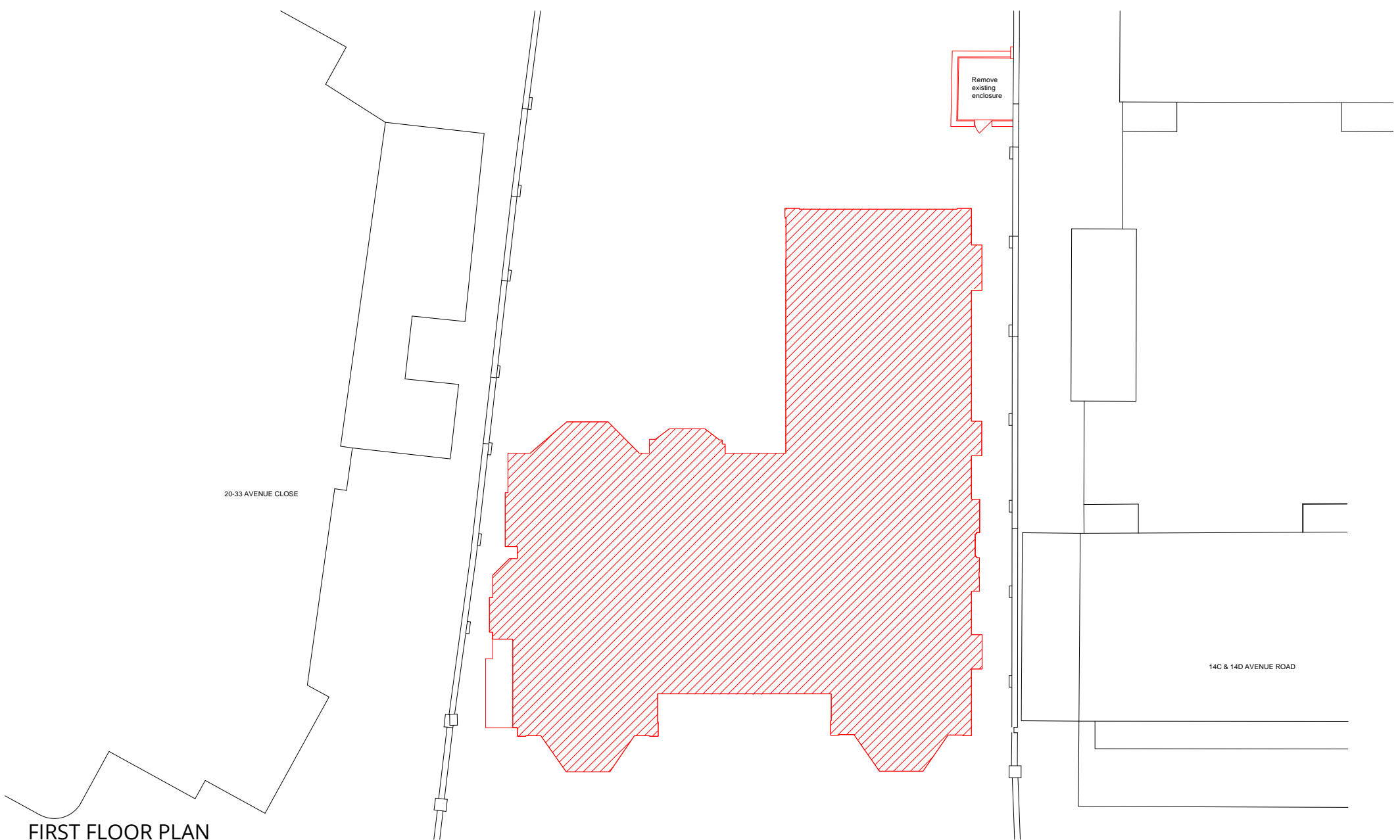

FIRST FLOOR PLAN



London 16 Lambton Place Notting Hill  
London W11 2SH T +44 (0)20 7229 3125

Oxford Chandos Yard 83 Bicester Road  
Long Crendon HP18 9EE T +44 (0)1844 203310

W www.wolffarchitects.co.uk E info@wolffarchitects.co.uk

This drawing is protected under Copyright and at no time should any portion be reproduced or copied without the permission of the Architect (Design Copyright Act 1968).

It must not be used for purposes other than that for which it is provided. It is supplied without liability for any errors or omissions. All dimensions to be checked on site.

Rev.	Description	Date	Rev.	Description	Date
0	First issue.	28.09.16			

Project Title				
Avenue Road, 16				
Drawing Title				
Proposed F&S Demolition Fl. Plans				
Status	Drawn by	Checked by		
Feasibility				
Scale	Project No.	Work Stage	Dwg. No.	Rev.
1:200 @ A3	1611	FE	013	0



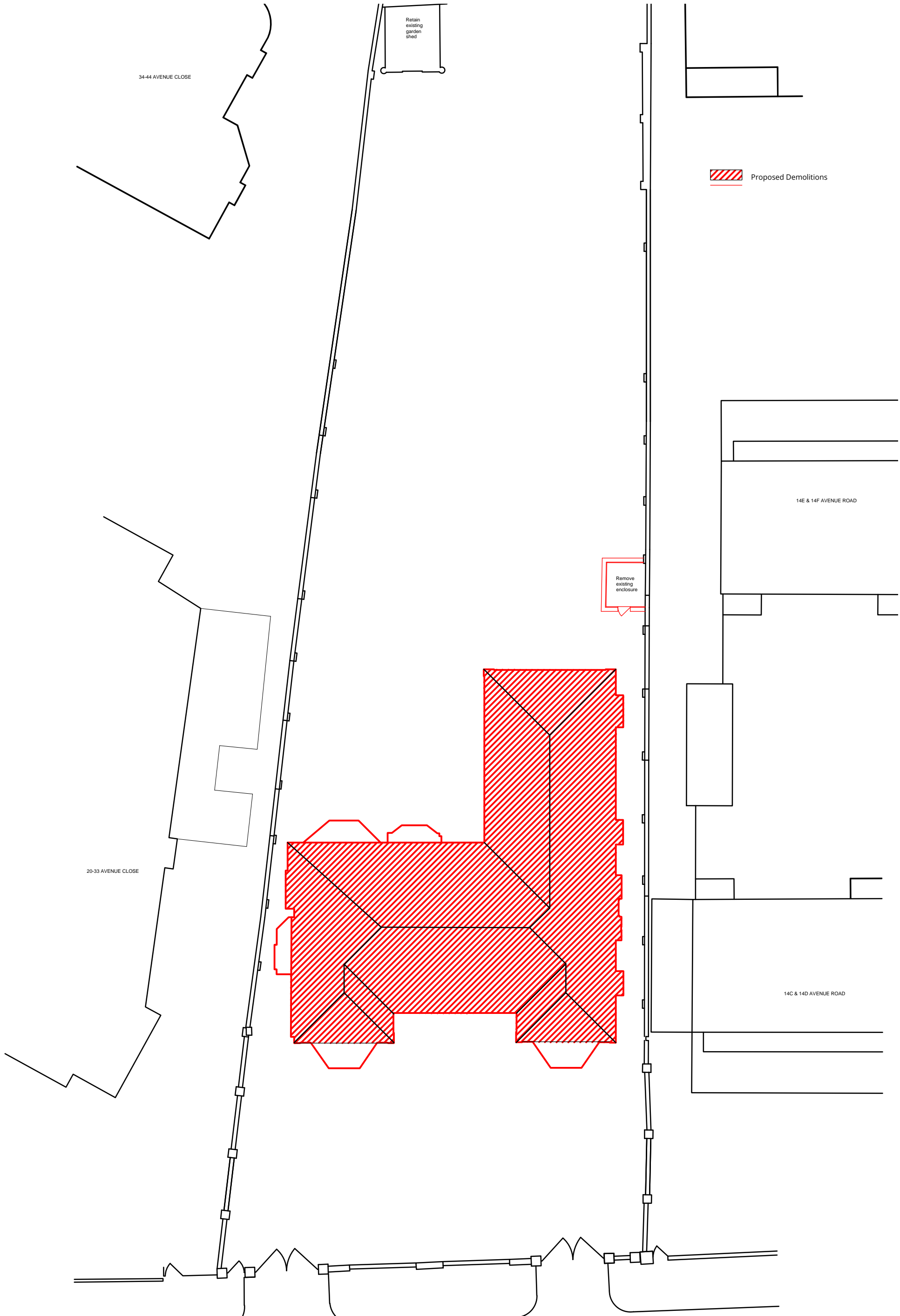

 Proposed Demolitions



London 16 Lambton Place Notting Hill  
London W11 2SH T +44 (0)20 7229 3125  
Oxford Chandos Yard 83 Bicester Road  
Long Crendon HP18 9EE T +44 (0)1844 203310  
W www.wolffarchitects.co.uk E info@wolffarchitects.co.uk  
This drawing is protected under Copyright and at no time should any portion be reproduced or copied without the permission of the Architect (Design Copyright Act 1968).  
It must not be used for purposes other than that for which it is provided. It is supplied without liability for any errors or omissions. All dimensions to be checked on site.

Rev.	Description	Date	Rev.	Description	Date
0	First issue.	28.09.16			

Project Title  
**Avenue Road, 16**

Drawing Title  
**Proposed Proposed Demolitions Roof**

Status  
**Feasibility**

Scale  
1:200 @ A3

Project No. 1611 - FE - 014 - 0

Work Stage

Dwg. No.

Rev.

Drawn by

Checked by

