

Proposed Basement Plan

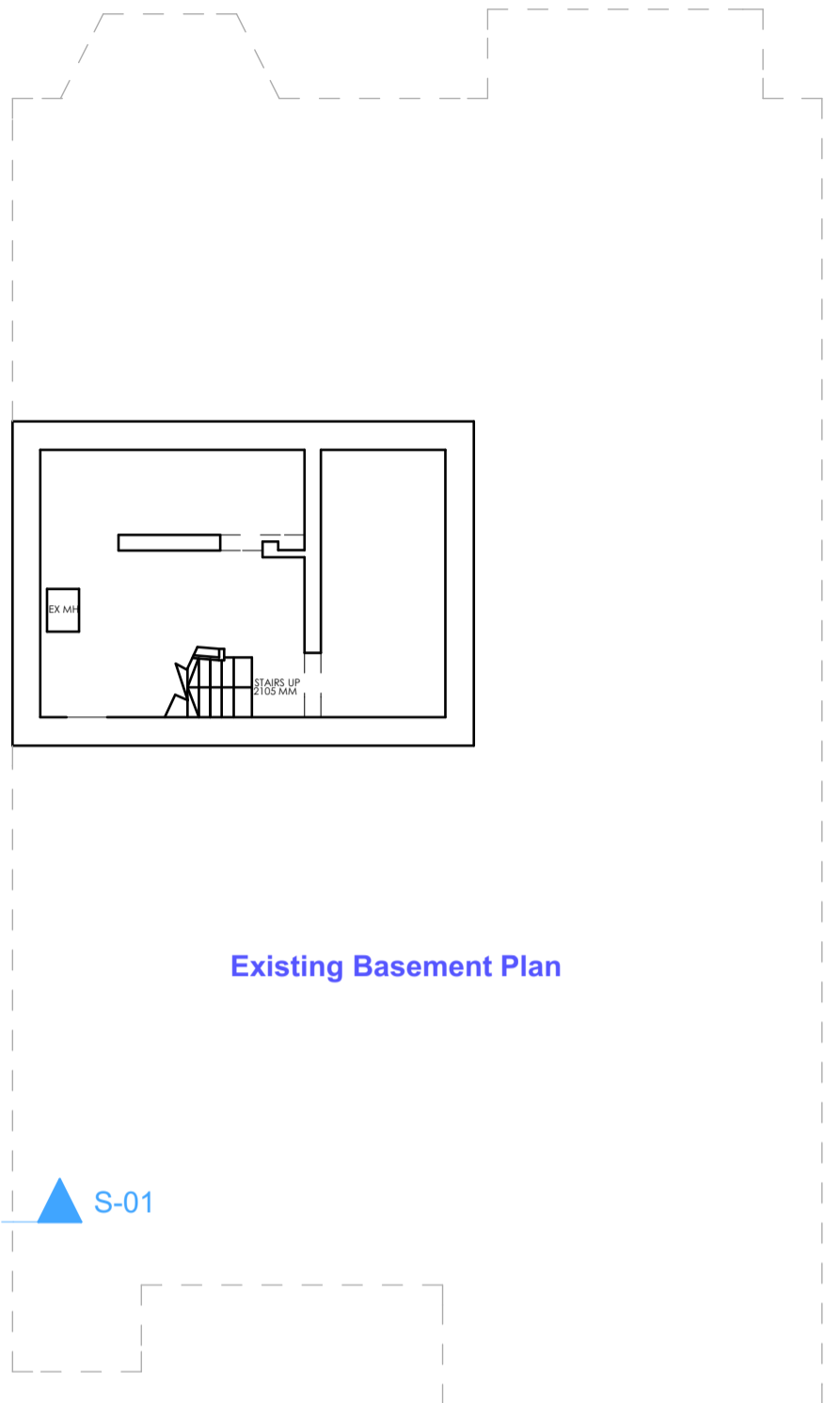

Existing Basement Plan



This drawing has been produced in support of a planning application and should not be used for any other purpose.

Copyright: No part of this drawing or any other drawings, details, calculations or schedules pertaining to this project as titled (including any notes therein) may be produced in any form either in part or whole without the prior permission in writing of Archian Ltd.

All dimensions are in millimeters, if in doubt ask. This drawing is not to be used for setting out, all sizes and dimensions to be checked on site prior to commencement and confirmed by the architect. This drawing is to be read in conjunction with all other relevant drawings and details. Materials and workmanship must be of standard conforming with the appropriate recognised authority. For example "National House Building Council", "British Standards Institution", "Department of the Environment (Building regulations 1991)" etc.

Party Walls: All relevant party wall agreements are to be entered into and agreed between owners prior to commencement of works. All cross over, build over agreements with utility companies to be agreed and approved prior to works on site.

Health and Safety: The contractor must at all times operate safe working practices, maintain the integrity of the existing structures, and conform to all the appropriate requirements Executive including the "Construction (Health, Safety and welfare) Regulations 1996". The working methods of any hazardous operations must first be discussed with the Planning Supervisor and the designer prior to commencement

Job Title
ARC-532
Address: 80 Greencroft Gardens, London, NW6 3JQ

Drawing Name
A-01 - BASEMENT FLOORPLANS

Drawing Status
PROPOSAL 1

Drawn by **S. L** Date: 28/06/2016

Checked by **T. P** Date: 28/06/2016

