

- Notes :-**
1. This drawing to be read in conjunction with all other relevant Architects and Engineers drawings and specifications.
 2. All setting out and dimensions to Architects drawings and details.
 3. Mass concrete to underpinning to be grade C20.
 4. New ground slab concrete to be grade C35.
 5. Steel lintels grade S355, hot dipped galvanised.

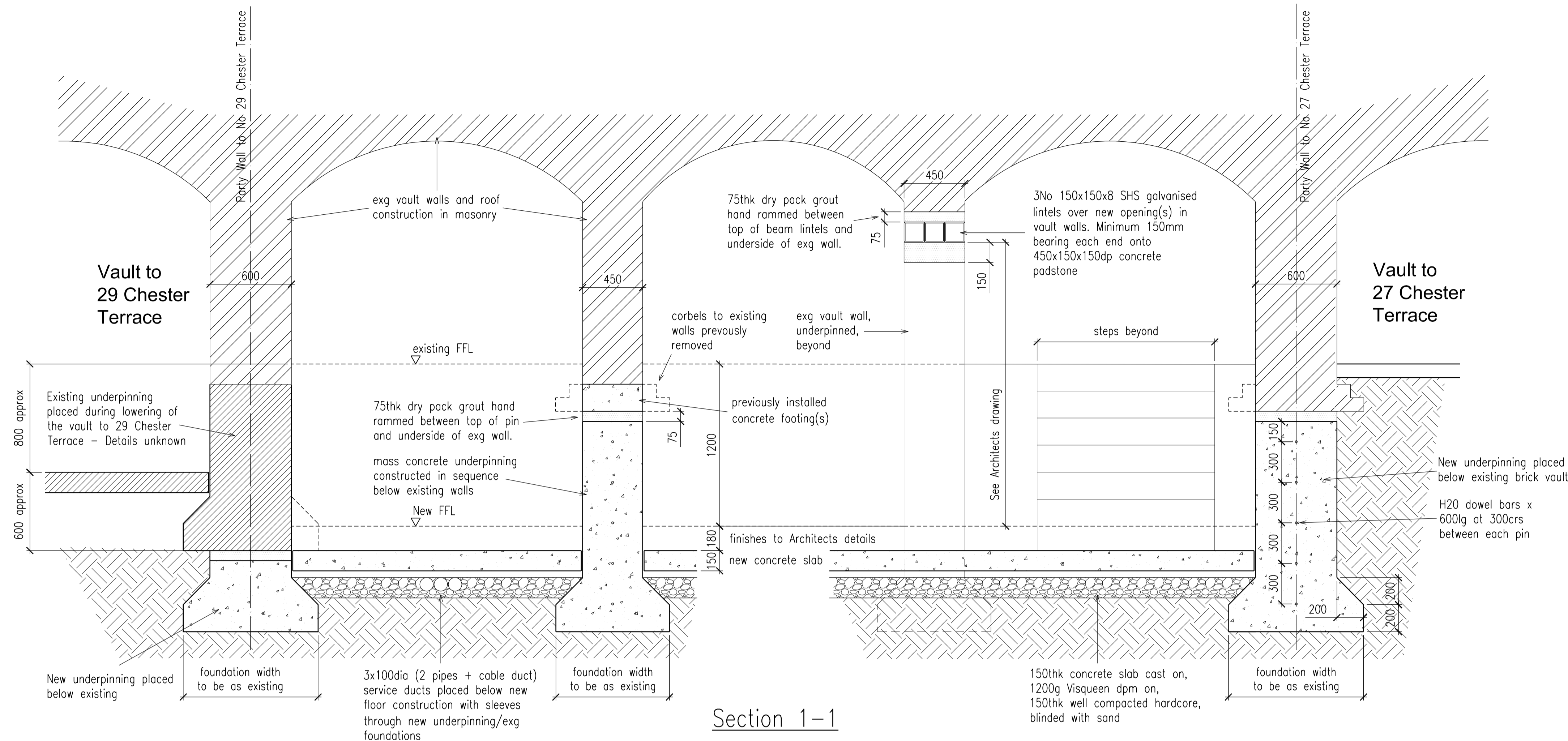

Section 1-1

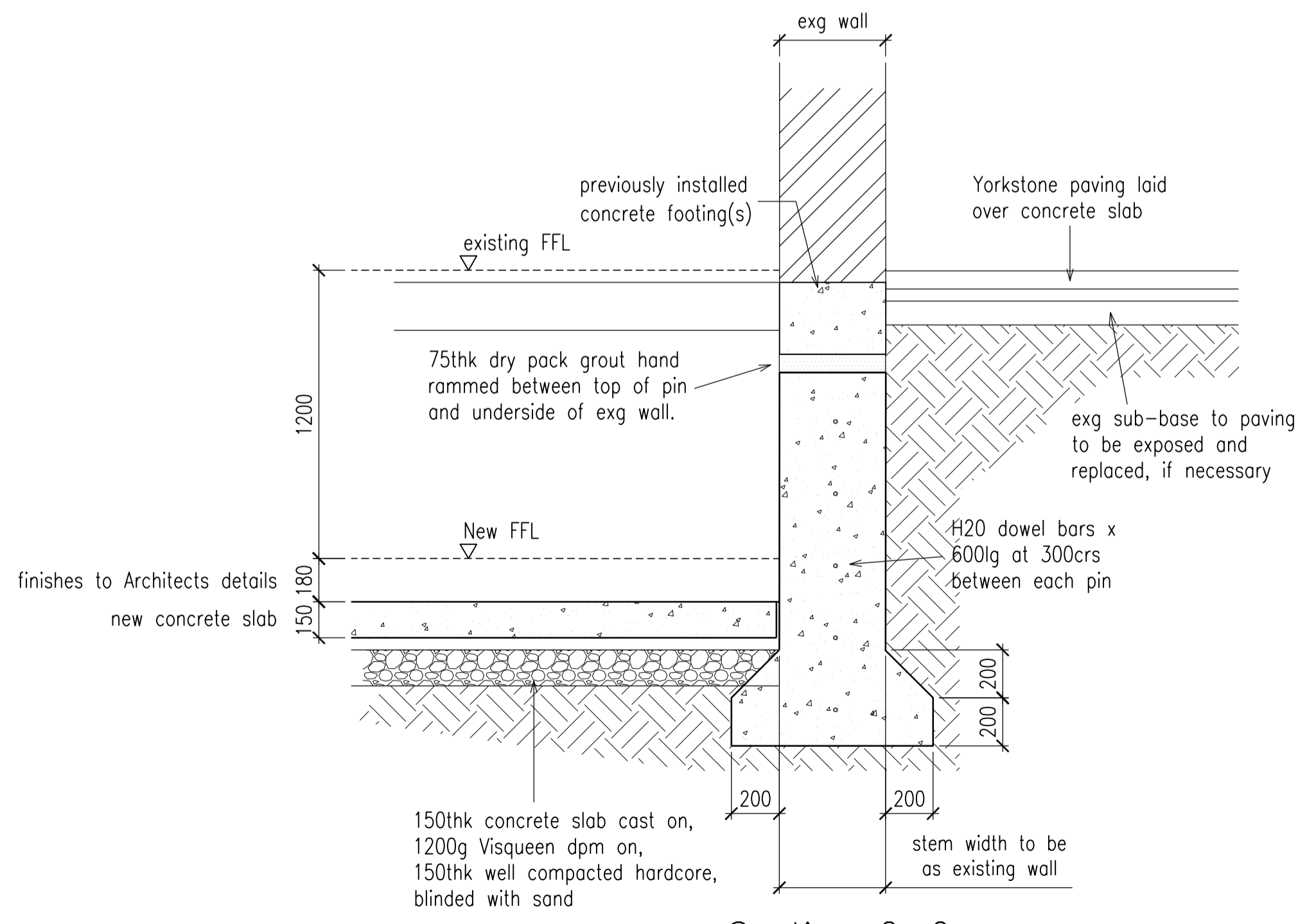

Section 2-2

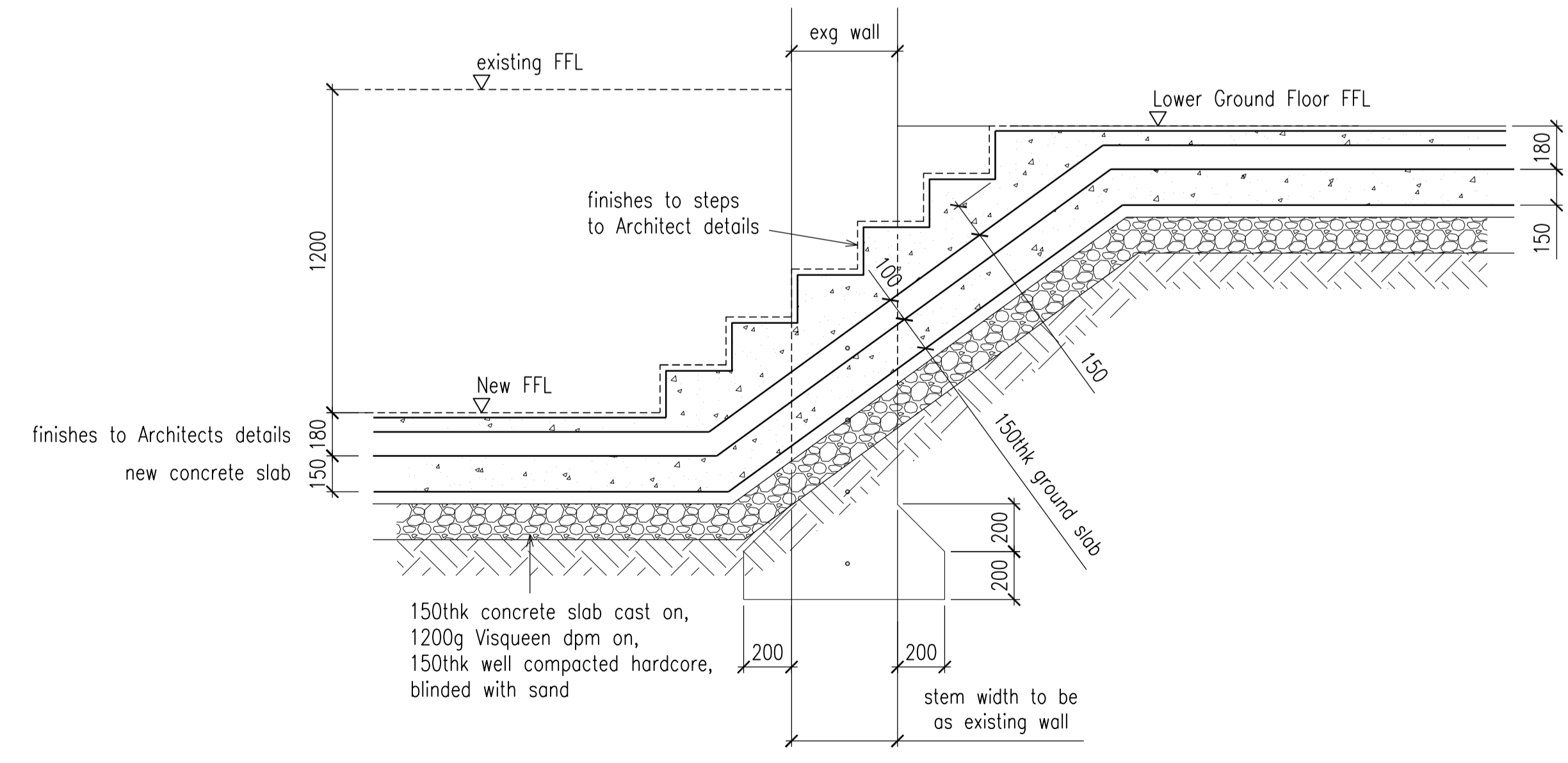

Section 3-3

D	14.09.16	DRAWING RESCALED
C	17.07.16	ISSUED FOR LICENCE
B	17.06.16	VAULT UNDERPINNING DETAILS UPDATED
A	14.06.16	ISSUED FOR PARTY WALL
Rev	Date	Comment

the **ELLIOTT PARTNERSHIP**
 Consulting Engineers
 14 Great Molewood
 Hertford, Hertfordshire, SG14 2PN
 tel : 01992 504700 • kevan@elliottpartnership.net

Project
28 Chester Terrace
 London NW1 4ND

Title
Layout and Details of Alterations to Vaults
 Sheet 2 - Sections

Drawn PAS	Checked KPE	Date June 2016	Scale A1, 1:20
Drawing No 1191-S-101			Rev D