

LOWER GROUND FLOOR PLAN  
1:50

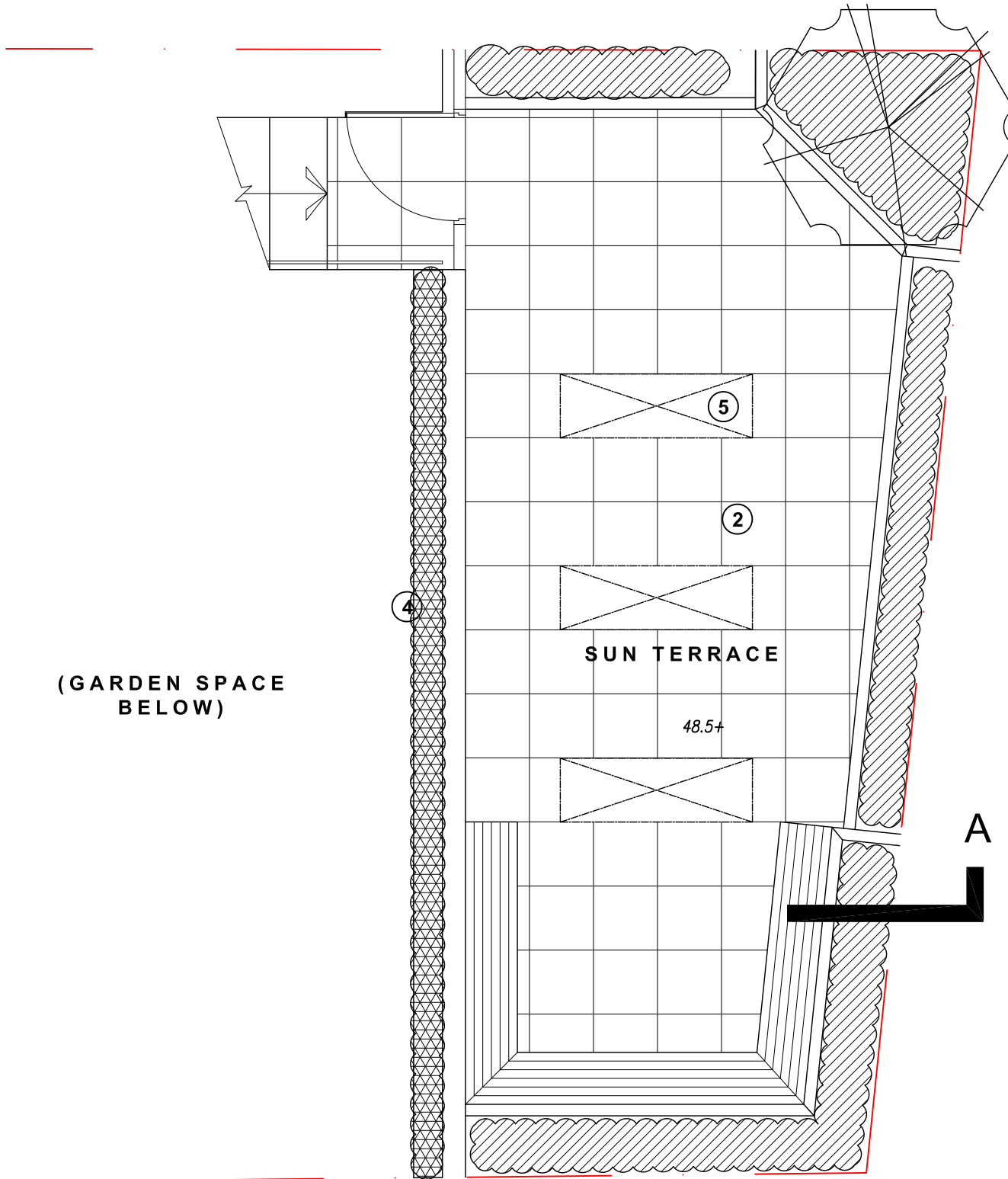

SUN TERRACE PLAN  
1:50

KEY

- NATURAL STONE PAVING**  
To main terrace, sun terrace and sunken courtyard. Marble Lazaro paving as supplied by Marshalls (0330 3114219) or similar approved
- STEPPING STONES**  
Recessed stone paving within lawn to provide access to Sun Terrace steps. Marble Lazaro paving as supplied by Marshalls (0330 3114219) or similar approved
- IN-BUILT SEATING AND RAISED PLANTER**  
In-built seating and planters to Sun Terrace constructed as tannalised softwood frame with hardwood cladding
- PROPOSED TREE/ LARGE SHRUB**  
Refer to planting plan for detail
- PLANTING**  
Refer to planting plan for detail
- HEDGE**  
Refer to planting plan for detail
- GREEN WALL SYSTEM**  
Green wall system to be fitted to extended wall elevation of sunken garden room and sunken terrace. Refer planting plan for detail.
- POTS**  
Handcraft pots as supplied by Atelier Vierkant (+32 50 370 056) or similar approved
- UP LIGHTING**  
Recessed Up lighting (CAT.NO NPS) as supplied by Hunza or similar approved
- WALL LIGHTING**  
Wall lighting (CAT.NO ESL) as supplied by Hunza or similar approved
- SLOT DRAIN**  
To sunken terrace paving

- ① **SUNKEN TERRACE**  
Secluded paved terrace providing access to sunken garden room.
- ② **SUN TERRACE**  
Sheltered space including in-built seating and raised planting to enclose seating area.
- ③ **LAWN**  
High quality lawn with glass balustrade to sunken terrace and steps. Including recessed stepping stones to provide access to the Sun Terrace.
- ④ **GREEN WALL**  
Wall to be fitted with green wall system to provide year round greening to sunken terrace and soften southern elevation.
- ⑤ **ALUMINIUM GLAZED ROOFLIGHT**  
A self-supported anti-slip walk on flat glass system with frosted privacy coating as supplied by Roofglaze (01480 474797). Installed to a supporting kerb, finished with roofing membrane for external applications. Unit to be double glazed with hermetically sealed glass, finished with a 78mm black perimeter border as standard.

**SUDS STATEMENT**  
Contribution to Sustainable Urban Drainage System:  
-- Drainage board to the terrace which acts as a shallow rainfall storage collection area. Contributing to onsite attenuation and reducing discharge.  
-- Link to an outfall within the building structure or drainage connection through the upstand wall. This can be connected vertically as a water feature into a simple DWP collection facility such as a contemporary planter disguised as a water butt with an overflow connection to a SW or sewer pipe.

B 16.09.2016 EP EP  
DWG UPDATED WITH COMMENTS FROM CLIENT

A 10.05.16 LL MJ  
DWG UPDATED WITH COMMENTS FROM CLIENT

FOR PLANNING



Blake House, 2a St Martin's Lane, York, YO16LN  
Tel: 01904 691630  
enquiries@landscapeagency.co.uk  
landscapeagency.co.uk  
client  
MR O'BRIEN

project  
38 REGENTS PARK ROAD

title  
GENERAL ARRANGEMENT PLAN  
AND SECTION

scale  
1:50@A1

date  
07.04.2016

drawn  
EP

checked  
MJ

drawing number  
1049-01

revision  
B

DO NOT SCALE FROM THIS DRAWING  
© The Landscape Agency