

INSET: UPPER BASEMENT LIGHTWELL GARDEN ABUTTING HOLMES ROAD

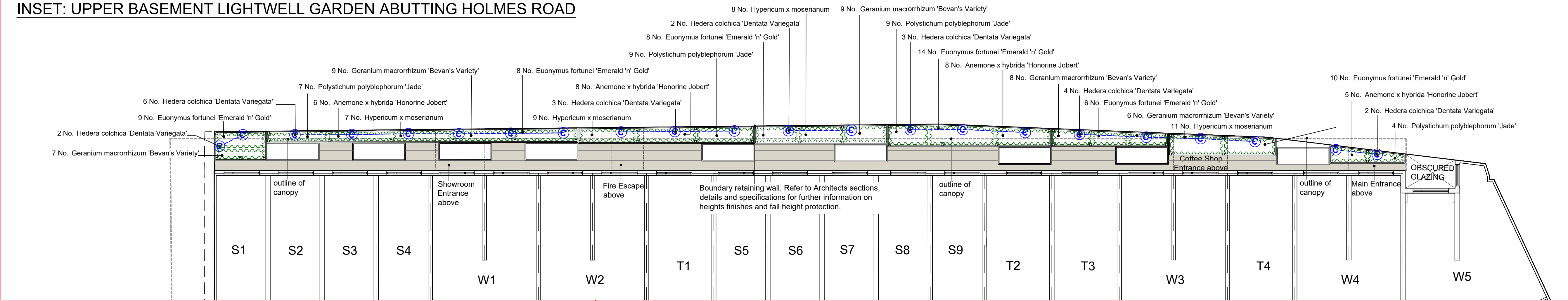

HOLMES ROAD

CATHCART STREET

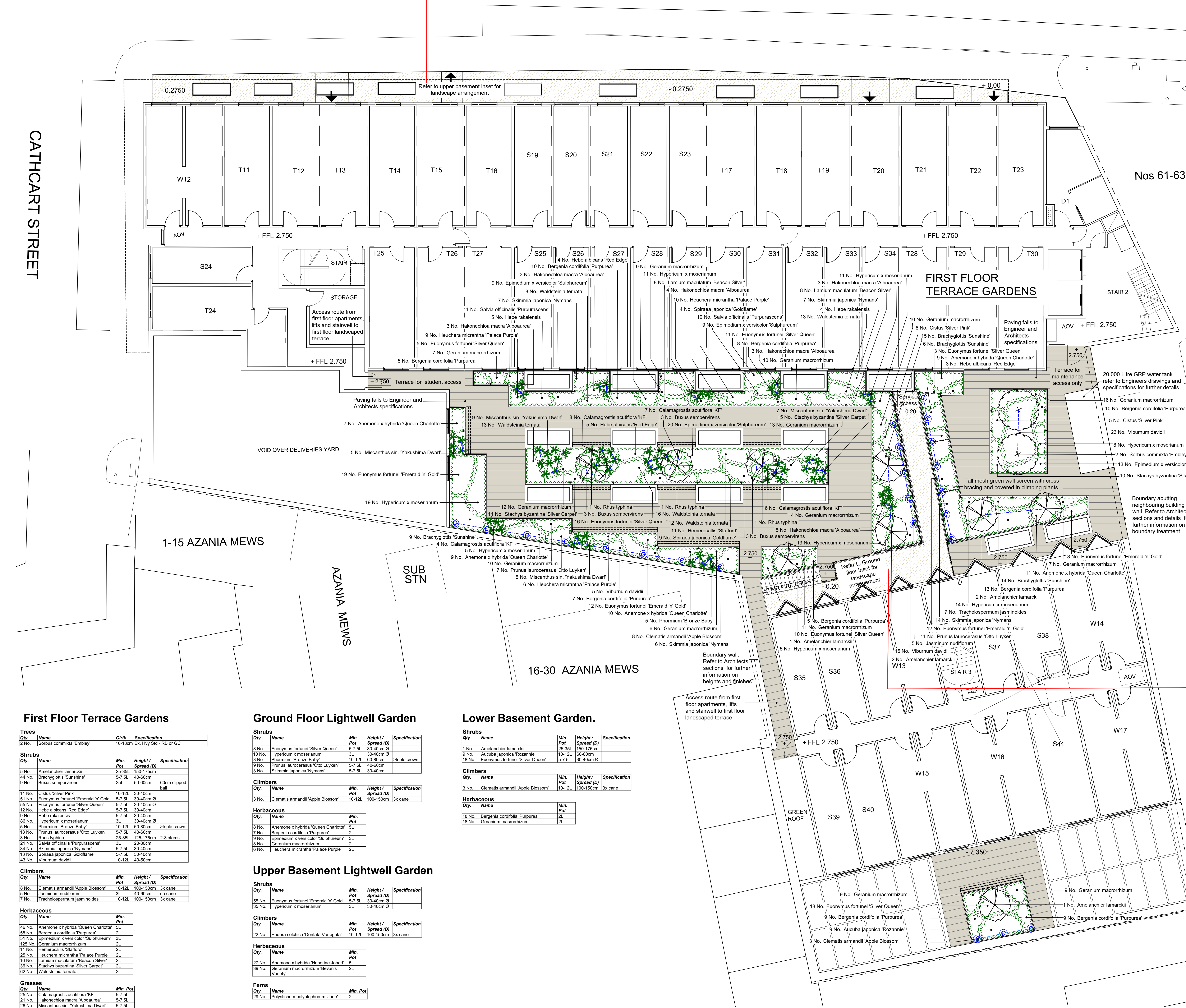

First Floor Terrace Gardens

Qty.	Name	Girth	Specification
------	------	-------	---------------

2	No. Sorbus commata 'Embley'	19-18cm Ex. Hvy Std. - RB or GC	
---	-----------------------------	---------------------------------	--

Shrubs

Qty.	Name	Min. Pot	Height / Spread (Ø)	Specification
3	No. Amelanchier lamarckii	25-30L	150-175cm	
44	No. Brachyglottis 'Sunshine'	5-7.5L	40-60cm	
9	No. Buxus sempervirens	25L	50-60cm	60cm clipped ball
11	No. Cistus 'Silver Pink'	10-12L	30-40cm	
51	No. Euonymus fortunei 'Emerald 'n' Gold'	5-7.5L	30-40cm Ø	
52	No. Euonymus fortunei 'Silver Queen'	5-7.5L	30-40cm Ø	
12	No. Hebe albicans 'Red Edge'	5-7.5L	30-40cm	
9	No. Hebe rakaisensis	5-7.5L	30-40cm	
86	No. Hypericum x moserianum	3L	30-40cm Ø	
6	No. Phormium 'Bronze Baby'	10-12L	60-80cm	stripe crown
18	No. Prunus laurocerasus 'Otto Luyken'	5-7.5L	40-60cm	
3	No. Rhus typhina	25-30L	125-175cm	2-3 stems
21	No. Salvia officinalis 'Purpureascent'	5-7.5L	20-30cm	
34	No. Skimmia japonica 'Nymans'	5-7.5L	30-40cm	
13	No. Spiraea japonica 'Goldflame'	10-12L	30-40cm	
42	No. Viburnum davidii	10-12L	40-60cm	

Climbers

Qty.	Name	Min. Pot	Height / Spread (Ø)	Specification
8	No. Clematis armandi 'Apple Blossom'	10-12L	100-150cm	3x cane
8	No. Jasminum nudiflorum	3L	40-60cm	No cane
7	No. Trachelospermum jasminoides	10-12L	100-150cm	3x cane

Herbaceous

Qty.	Name	Min. Pot
46	No. Anemone x hybrida 'Queen Charlotte'	5L
46	No. Bergenia cordifolia 'Purpurea'	3L
51	No. Epimedium x versicolor 'Sulphureum'	3L
25	No. Geranium macrorrhizum	2L
11	No. Hemerocallis 'Shafford'	2L
25	No. Heuchera micrantha 'Palace Purple'	2L
18	No. Lamium maculatum 'Beacon Silver'	2L
36	No. Stachys byzantina 'Silver Carpet'	2L
62	No. Waldsteinia ternata	2L

Grasses

Qty.	Name	Min. Pot
15	No. Calamagrostis acutiflora 'KF'	5-7.5L
21	No. Hakonechloa macro 'Albaurea'	5-7.5L
20	No. Miscanthus sin. 'Yakushima Dwarf'	5-7.5L

Ground Floor Lightwell Garden

Shrubs

Qty.	Name	Min. Pot	Height / Spread (Ø)	Specification
8	No. Euonymus fortunei 'Silver Queen'	5-7.5L	30-40cm Ø	
10	No. Hypericum x moserianum	3L	30-40cm Ø	
7	No. Phormium 'Bronze Baby'	10-12L	60-80cm	
3	No. Prunus laurocerasus 'Otto Luyken'	5-7.5L	40-60cm	
3	No. Skimmia japonica 'Nymans'	5-7.5L	30-40cm	

Climbers

Qty.	Name	Min. Pot	Height / Spread (Ø)	Specification
3	No. Clematis armandi 'Apple Blossom'	10-12L	100-150cm	3x cane

Herbaceous

Qty.	Name	Min. Pot
8	No. Anemone x hybrida 'Queen Charlotte'	5L
8	No. Bergenia cordifolia 'Purpurea'	3L
9	No. Epimedium x versicolor 'Sulphureum'	3L
10	No. Geranium macrorrhizum	2L
11	No. Hemerocallis 'Shafford'	2L
25	No. Heuchera micrantha 'Palace Purple'	2L
18	No. Lamium maculatum 'Beacon Silver'	2L
36	No. Stachys byzantina 'Silver Carpet'	2L
62	No. Waldsteinia ternata	2L

Upper Basement Lightwell Garden

Shrubs

Qty.	Name	Min. Pot	Height / Spread (Ø)	Specification
55	No. Euonymus fortunei 'Emerald 'n' Gold'	5-7.5L	30-40cm Ø	
35	No. Hypericum x moserianum	3L	30-40cm Ø	

Climbers

Qty.	Name	Min. Pot	Height / Spread (Ø)	Specification
22	No. Hedera colchica 'Dentata Variegata'	10-12L	100-150cm	3x cane

Herbaceous

Qty.	Name	Min. Pot
27	No. Anemone x hybrida 'Honore Jobert'	5L
36	No. Geranium macrorrhizum 'Bevan's Variety'	2L
29	No. Polystichum polyblepharum 'Jade'	2L

Lower Basement Garden.

Shrubs

Qty.	Name	Min. Pot	Height / Spread (Ø)	Specification
1	No. Amelanchier lamarckii	25-30L	150-175cm	
9	No. Aucuba japonica 'Rozanne'	10-12L	60-80cm	
10	No. Euonymus fortunei 'Silver Queen'	5-7.5L	30-40cm Ø	
3	No. Skimmia japonica 'Nymans'	5-7.5L	30-40cm	

Climbers

Qty.	Name	Min. Pot	Height / Spread (Ø)	Specification
3	No. Clematis armandi 'Apple Blossom'	10-12L	100-150cm	3x cane

Herbaceous

Qty.	Name	Min. Pot
18	No. Anemone x hybrida 'Queen Charlotte'	5L
7	No. Bergenia cordifolia 'Purpurea'	3L
9	No. Epimedium x versicolor 'Sulphureum'	3L
8	No. Geranium macrorrhizum	2L
6	No. Heuchera micrantha 'Palace Purple'	2L

NOTES / BRIEF SPECIFICATION

PROPOSED FINISHED LEVELS

Refer to architects and or engineers plans full levels detail ensuring adequate falls for drainage and compliance with disability access standards.

BOUNDARY TREATMENTS

Refer to architects plans and specifications for boundary treatments.

MATURED BARK MULCH FOR PLANTERS

- Pine, Spruce, Douglas Fir or Larch bark mulch from an FSC certified sustainable source.
- Particle size 5-35mm
- Wood content: less than 5%
- pH between 4.5 and 5.5
- Free of any pests, disease, fungus, weeds or other contamination
- Tested in accordance with BS 4750:1987 for fire resistance and classified as having "low" potential to burn.
- Matured through natural heat treatment to ensure that excess volatile substances are driven off, involving temperatures within the heap exceeding 50°C for a minimum 14

WATER STORAGE & GROWING MEDIA FOR PLANTERS

- Bottom of Planters to be lined with thermofomed plastic water storage mat such as Floradrain FD60 by (ZINCO ph: 01223 853843) or similar. Water reservoir should be installed facing upwards.
- Fill plastic water storage matt with a minimum of 40mm of Zincolit Plus by (ZINCO ph: 01223 853843) or similar.
- Prior to installation of growing media cover water storage layer with a non-rotting permeable geotextile such as Protection Mat ISM 50 by (ZINCO ph: 01223 853843) or similar.
- Planters to be filled with and approved intensive roof garden growing media such as system substrate 'Roof Garden' by (ZINCO ph: 01223 853843) or similar.
- Minimum depth of growing media installed into planters to be 400mm deep.
- Growing media to be firmly tamped and watered in to prevent excessive settlement.
- Fill planters with growing media to minimum 50mm below top of planter to allow for settlement and for FSC approved matured mulch layer onto.

GENERAL FERTILIZER: ALL PLANTING AREAS

- NPK - 10-7-5.10.2 with slow release nitrogen and balanced trace elements
- E.g. Manufacturer and reference: Vitax Q4 HN or Vitax Conifer & Shrub Fertilizer
- Apply evenly over all planting areas at a rate of 60g/sq m.

CLIMATIC CONDITIONS:

- Carry out the work while soil and weather conditions are suitable for the relevant operations.

WATERING GENERALLY:

- Ensure the full depth of topsoil is thoroughly wetted.
- Use a fine rose where appropriate to avoid damaging or loosening plants.
- Water as necessary to ensure the establishment and continued thriving of all planting.

QUALITY OF ALL PLANT MATERIAL:

- All plant material shall be of the best "garden center" quality, being healthy, bushy and where appropriate for the season in bud or in flower. Herbaceous plants supplied during the growing season are to be supplied with full, undamaged top growth - not cut back.
- Materially undamaged, sturdy, healthy, vigorous, of good shape and without elongated shoots.
- Grown in a suitable environment and fully hardened off
- Free from pests, diseases, discoloration, weeds and physiological disorders
- Budded or grafted plants to be bottom worked, unless otherwise specified or approved.
- With balanced root and branch systems, root system and condition in accordance with the relevant part of the National Plant Specification unless otherwise specified.
- True to specified name
- Plant material shall conform to the pot sizes and heights as scheduled. Where height cannot be obtained at the pot size specified a larger pot size shall be supplied instead to provide the required height.

TREE PLANTING:

- Unless otherwise specified, plant upright / vertically.
- Remove any temporary ties or wrapping of the crown and encourage branches to spread naturally.
- Orientate so that best side of the crown faces the main viewpoint
- Ensure tree is planted at original nursery soil level.
- Back fill with excavated topsoil, firming as work proceeds and ensuring there are no voids.

STAKING / SUPPORT TREES IN GRASS AND PLANTING BEDS:

- Except where indicated otherwise, support as follows:
- 16-18cm standard and larger: Underground guy using proprietary "duck bill" type anchors driven into sides / base of pit, or similar system but using concrete "deadmen" (do NOT use timber)
- 12-14 and 14-16cm standards: Double short stake with crossbar.
- 10-12cm standards and smaller: Short diagonal stake.
- Stakes: Treated softwood, peeled chestnut, larch or oak, free from projections and large or edge knots and with pointed lower end, 50mm diameter
- Drive stakes vertically / diagonally as appropriate, at least 400 mm into bottom / side of pit, avoiding the root ball, preferably before placing the tree.
- Consolidate material round stakes during backfilling.
- Newly cut stakes to finish 500-600mm above ground
- For double stakes, firmly fix a softwood cross bar (approx. dimensions 100x50mm) on windward side of tree and as close as possible to stem. All fixings to be neat and tidy with no sharp ends left protruding
- Secure tree firmly but not rigidly to cross bar / stake with proprietary adjustable rubber tie, fixed to avoid chaffing of the tree, but with sufficient slack to allow expansion of the trunk over first 6-months growth.
- Diagonal stakes: Adjustable buckle type tie with spacer block
- Double stake and crossbar: Rubber strap threaded through rubber spacer block and nailed to crossbar.
- Where trees are in a line or group ensure all stakes and bars are orientated the same way and look neat.

ORNAMENTAL SHRUBS, HERBACEOUS PLANTS, HEDGES AND CLIMBERS:

SHRUB PLANTING PITS:

- Excavate not more than 24 hours before planting and retain planting media for re-use where specified.
- Size(s): a minimum of 20% bigger than required to take rootball / full root spread.

PLANTING CLIMBERS

- Remove nursery canes or frames and train plant onto the wire supports (or trellis), lightly tying stems using soft twine. Retain canes of plants too small to reach first horizontal wire, but angle fix to wall.
- Where climbers are not planted on a trellis fence or similar structure, supply and fix vine eyes and wires.
- Where self-climbing climbers are specified no wire supports will be required.
- Where *Jasminum nudiflorum* is planted at the top of walls, these are intended to hang down the wall and no wire supports are required.

ON WALLS AND FENCES

- 3mm galvanized wires to be set horizontally, the first 550mm above ground level and subsequent rows at 300mm vertical spacing up the wall / fence. (Exact spacing may be adjusted to suit coursing of masonry or the structure of the fence).
- Top wire to be at a height of 2.3m above ground, or just below top of supporting structure if this is lower
- Each wire to be 2m long, centered on climber. Where adjacent climbers are closer than 3m apart, continuous wires should run between them.
- Secure with 100mm long galvanized vine eyes, one at each end and at max. 600mm horizontal centres, ensuring that vine eyes align vertically forming a regular grid. Vine eyes screwed into neatly drilled holes with appropriate fixing plug (e.g. Rawl Plug for fixing into masonry)
- Wires to pass through each vine eye, pulled taut, neatly and tightly twisted back on itself at each end (at least 2no. turns close to vine eye)

AFTER PLANTING:

- Water all plants thoroughly immediately after planting, using a fine rose or sprinkler where necessary to avoid damaging plants.
- Lightly firm growing media around plants and rake even, without damaging roots.
- Carefully prune back/remove any damaged shoots or branches from shrubs and broken stems of herbaceous material.
- Remove all tags, ties and labels.

All landscape works to be carried out in accordance with British Standard 4429: 1989 & AMD 'Code of practice for general landscape operations' unless otherwise stated in this document.

KEY

- Proposed trees.
- Large Specimen shrubs.
- Proposed shrub and herbaceous planting.
- Locations for climbing plants.
- Imprinted Concrete Paving: In a Granite grey colour. Setout and imprinted in 450x450mm courses to alignment as indicated on plan.
- Planter boxes: 'Granadier' planter by Street Design Limited or similar. Waiting heights to be 630mm and Built to custom sizes as per plan from FSC European redwood in Natural finish. Refer to website www.street-design.com and product specification for further details.
- Integral Bench Seating: 'Henley' bench by Street Design Limited or similar. Built to custom sizes as per plan from FSC European redwood in Natural finish. Refer to website www.street-design.com and product specification for further details.
- Green Wall Screens: Integral Green Wall Screen by Street Design Limited or similar. Height 2080mm above planter, braced and built to custom sizes as per plan in galvanneal steel. Refer to website www.street-design.com and product specification for further details.
- Vertical Bar Boundary Railings: Approx 1100 high galvanneal steel vertical bar railings fixed securely along top of lightwell where falling from height protection is required.
- Glazed Rooflights as proposed by Architect.
- 2,750 + Proposed finished levels as specified by Architect.
- 20,000 Litre GRP water storage tank dimensions 5.16m x 2.16m x 2.13m to provide supplementary water to plants. Tanks by Direct water tanks or similar www.directwatertanks.co.uk

Client: Contemporary Design Solutions LLP

Project: 65-85 Holmes Road, Kentish Town, London

Title: Landscape Proposal (Sheet 1 of 1)

Drg by: RH Date: July 2016 Scale: Scale 1:100@ A0

Chkd by: DCL 571 / Drg 01 Rev:

1.17 PAINTWORKS, BATH ROAD, BRISTOL. BS4 3EH Tel: 0117 300 5330

