



16 Avenue Road. London NW8 6HP

TPO consent for removal of Tree of Heaven

Design Statement



Background

This application is made in advance of the development of details proposals for a scheme of improvements for the property in order to establish the principle of acceptability of the removal of this centrally located tree.

Prior to entering into more detailed planning negotiations with the Council the Applicant is aware that any proposals for the extension of the existing building or the redevelopment of the site are contingent on the removal of this tree which we are advised is not in the best of health and which has been allowed to grow directly adjacent to the existing house.

No firm proposal can be developed until the principle of removal is established.



aerial view showing context and trees



aerial view showing site and subject tree

Extension and Development

Currently the subject tree prevents extension or development of the site being centrally located immediately adjacent to the existing house

We will be considering both the possible extension of the house and/or the redevelopment of the site. The images below give two ideas of where, logically, that building might take place. Both affect the tree.

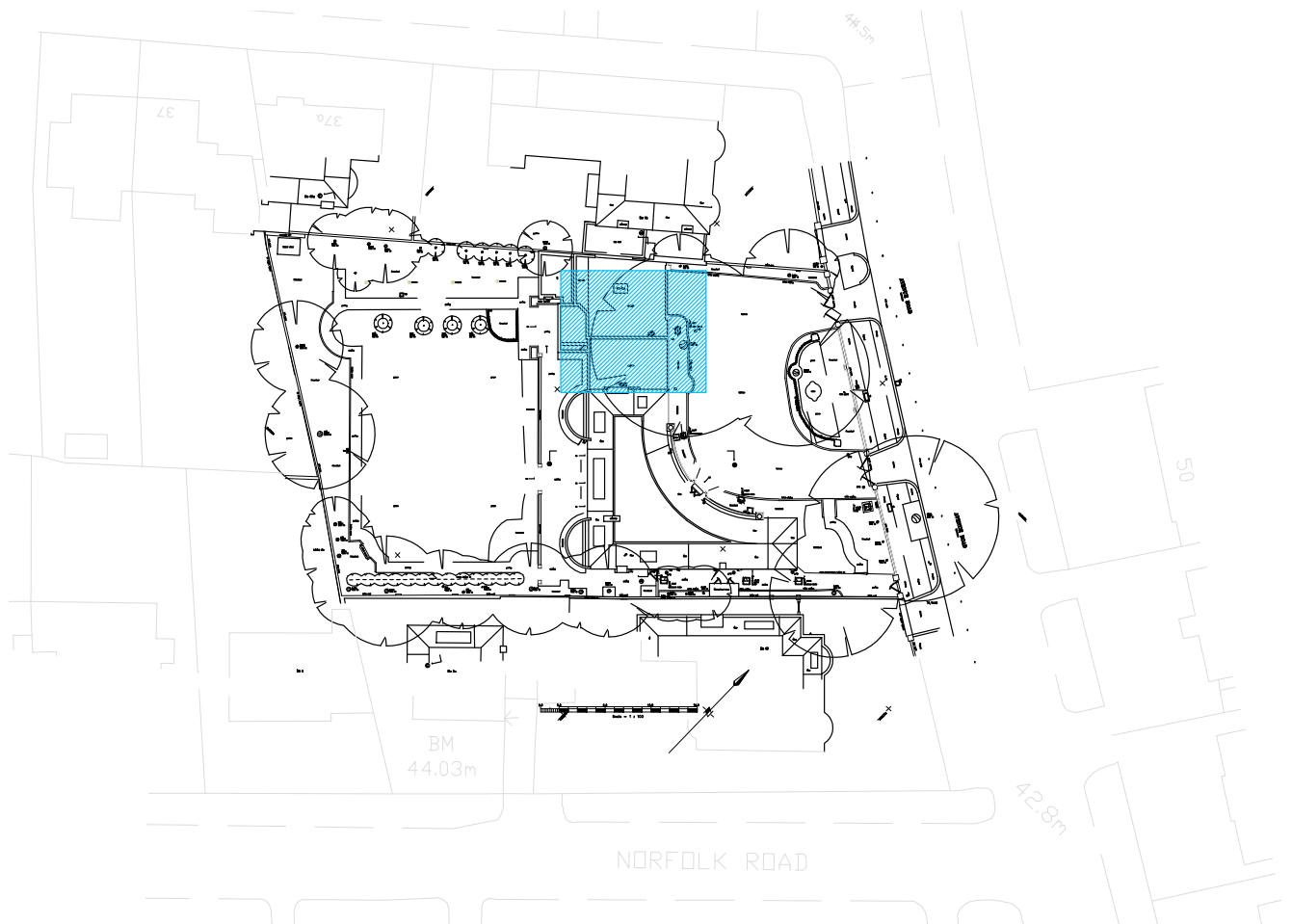

potential building showing extension in blue

Potential footprint

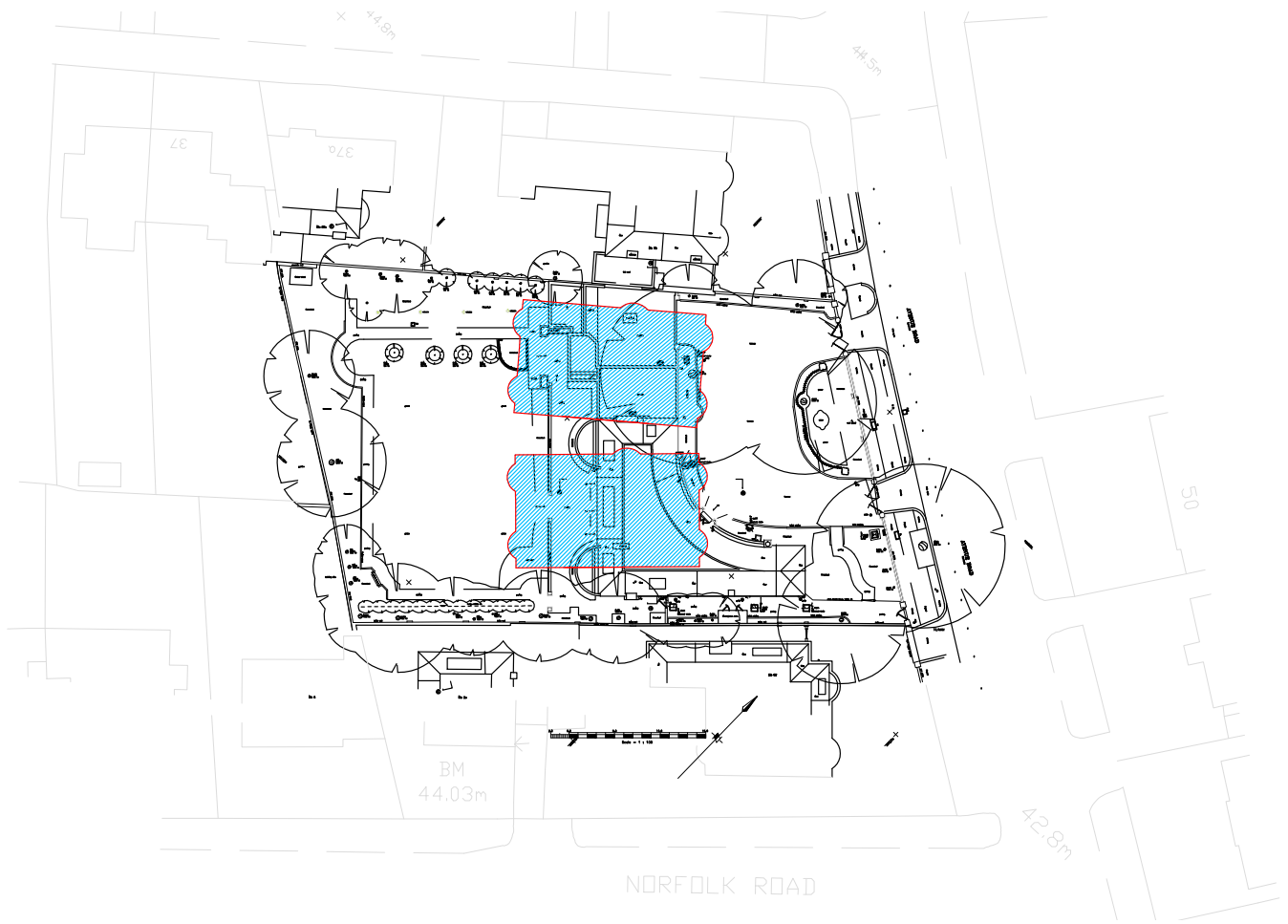

potential building showing redevelopment in blue



Foundation Architecture Ltd. Omnibus, 39-41 North
Road, London N79DP
0207 036 1070

- www.foundation-architecture.com •
Registered in England and Wales No. 3914245