



**Material Name**  
Exposed Steel Structure Paint

**Source**  
HBE

**Colour**  
RAL 7016

**Finish/Texture**  
n/a

**Location**  
Exposed steelwork on roof and structural elements in Stair 3



**Material Name**  
Galvanised Steel Roof Balustrade

**Source**  
Anglian Architectural

**Colour**  
Zinc galvanised

**Finish/Texture**  
n/a

**Location**  
Main building rooftop.



**Material Name**  
External WBS Silicon Render Cladding

**Source**  
Wetherby

**Colour**  
RAL 7016

**Finish/Texture**  
1.5mm grade

**Location**  
Rooflight enclosure.



**Material Name**  
Rooftop aluminium copings.

**Source**  
Anglian Architectural

**Colour**  
Syntha Pulvin Ebony XDMC002 Polyester powder coating

**Finish/Texture**  
30% gloss

**Location**  
Rooftop and above living wall. Material also used on southern facade capping pieces.



**Material Name**  
GL101 Clear Glazing Panel with black capping piece

**Source**  
Anglian Architectural

**Colour**  
Glass - Clear Capping Piece - RAL 9005

**Finish/Texture**  
Glass - Neutral tinted

**Location**  
Southern facade windows at levels 01-03 and East, West and North Facade curtain walling.



**Material Name**  
GL101B Opaque Glazing Panel with SSAF004EX window film with externally applied white frit pattern

**Source**  
Anglian Architectural

**Colour**  
Clear

**Finish/Texture**  
Neutral tinted

**Location**  
Southern facade curtain walling at level 04



**Material Name**  
GL101B Opaque Glazing Panel

**Source**  
Anglian Architectural

**Colour**  
Clear

**Finish/Texture**  
Neutral tinted

**Location**  
Southern facade windows at level 04



**Material Name**  
GL106 Opaque Glazing Panel

**Source**  
Anglian Architectural

**Colour**  
Clear

**Finish/Texture**  
Neutral tinted

**Location**  
Spandrel locations



**Material Name**  
Southern Facade Window Framing

**Source**  
Anglian Architectural

**Colour**  
Syntha Pulvin Ebony XDMC002 Polyester powder coating

**Finish/Texture**  
30% gloss

**Location**  
Southern facade window framing including mullions, transoms and capping pieces.



**Material Name**  
Southern Facade Louvred Shading Devices

**Source**  
Anglian Architectural with Lunar 100 aerofoils.

**Colour**  
Syntha Pulvin Ebony XDMC002 Polyester powder coating

**Finish/Texture**  
30% gloss

**Location**  
Southern facade windows.



**Material Name**  
Biotecture Living Wall

**Source**  
Biotecture

**Colour**  
n/a

**Finish/Texture**  
n/a

**Location**  
South and West Facade



**Material Name**  
Reinstated paving

**Source**  
VIMN

**Colour**  
n/a

**Finish/Texture**  
n/a

**Location**  
Ground floor cycle store and loading bay.



**Material Name**  
Reinstated granite facade base

**Source**  
VIMN

**Colour**  
Black

**Finish/Texture**  
n/a

**Location**  
Southern facade base at ground level.



**Material Name**  
Southern Facade Powder Coated Aluminium Louvres

**Source**  
Ermine

**Colour**  
Polyester powder coated to match existing.

**Finish/Texture**  
to match existing

**Location**  
Southern facade



**Material Name**  
Expanded Aluminium Mesh set within Steel Frames

**Source**  
James & Taylor

**Colour**  
Mesh - Aluminium Frame - RAL 7016

**Finish/Texture**  
n/a

**Location**  
Southern facade and Stair 3 enclosure

Copyright of this drawing is vested in Splus Architects and it must not be copied or reproduced without written consent. Plotted instructions only are to be taken from this drawing. Do not scale from this drawing.  
All Contractors must refer to the site and are responsible for verifying and checking all dimensions, levels and all work. Splus Architects are to be advised of any variation between drawings and site conditions.  
This drawing shall remain the property of Splus Architects and must not be reprinted or reproduced.  
All dimensions and levels shall be taken from those values stated in text on the drawing.  
CONSTRUCTION - It is considered that the proposed works are within the scope of a competent Contractor and as such no specialist reports have been identified, other to relevant Risk Stratification/Outgoing Risk Assessment.

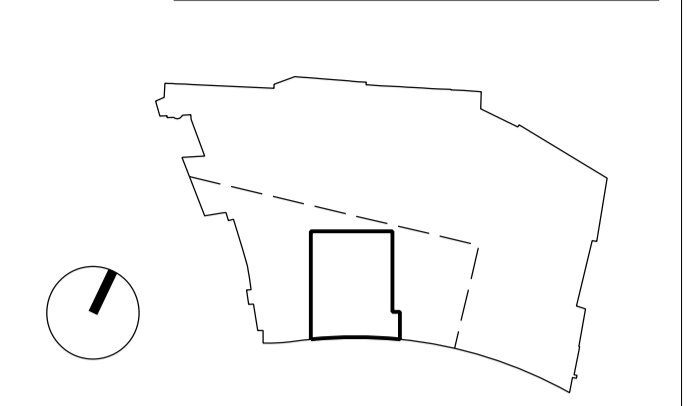

P1 23/09/16 Discharge of Conditions Submission

CLIENT: Viacom International Media Networks, 17-23 Hawley Crescent, London NW1 8TT, t. +44 (0)203 580 2000

CONTRACTOR: FAITHDEAN PLC, Faithdean Plc, The Oaks, Revene Road, Lordswood, Chatham, Kent ME5 8LP, t. +44 (0)1634 888 268

ARCHITECT: 5plus architects, 3rd Floor, 25 Chart Street, London N1 6FA, t. +44 (0)207 253 7644, www.5plusarchitects.com

PROJECT: VIMN Courtyard Infill, Camden

TITLE: Block 1 - Proposed Conditions Facing Materials Palette

SCALE: n/a, ORIGIN DATE: 23/09/16, DRAWN: OR, CHECKED: AT

STATUS: Planning

PROJECT: 05445, DRAWING NO: B1\_18\_9200, REV: P1

Architecture | Masterplanning | Interiors | Graphics | Branding