



# Design development

Midland Goods Shed and East Handyside Canopy

## Proposed plans - Key areas

These plans highlight the key areas of the design scheme. Each architectural insertion is an important element comprising the overall concept.

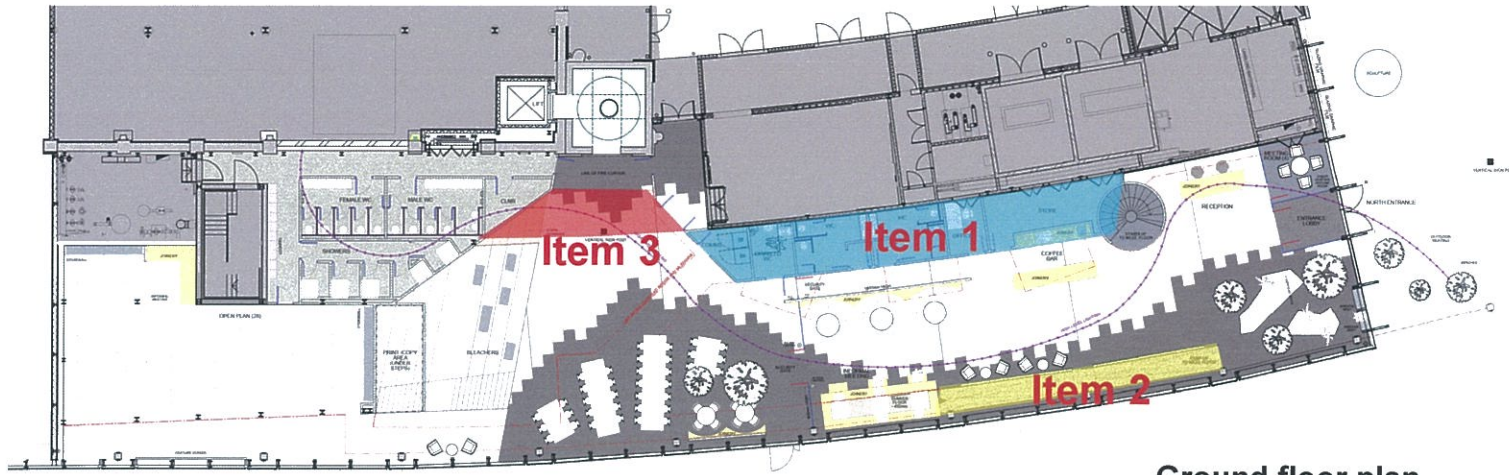

### Ground floor plan

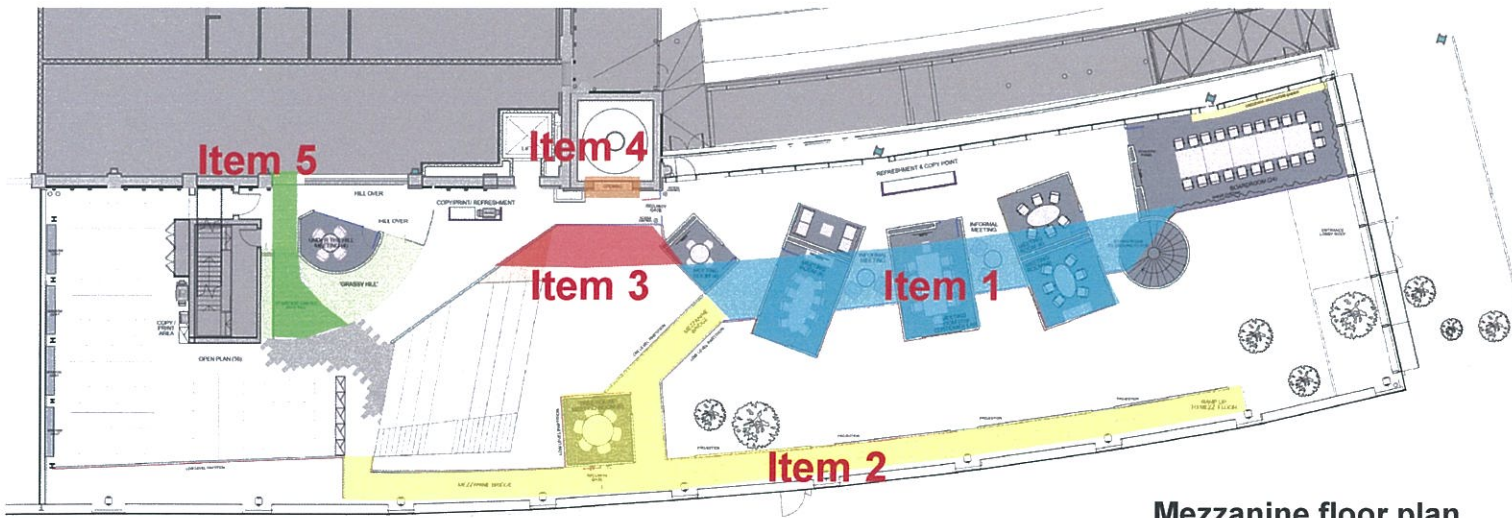

### Mezzanine floor plan



th entrance are to be removed, to open up the views into the building. The existing  
duce interesting and complimentary architectural forms to the environment.

views across the building. This piece allows an alternative vista to experience the interrupted, natural daylight and views in are maintained and not compromised.

hidden away. Removing part of the mezzanine will allow this existing feature to be take

is currently too hidden away. Opening this up will allow this existing feature to be take

the floors - as per the previously approved Guardian scheme.

ground floor and mezzanine areas.

s use of the high ceilings while retaining a sense of the overall volume of the space. It

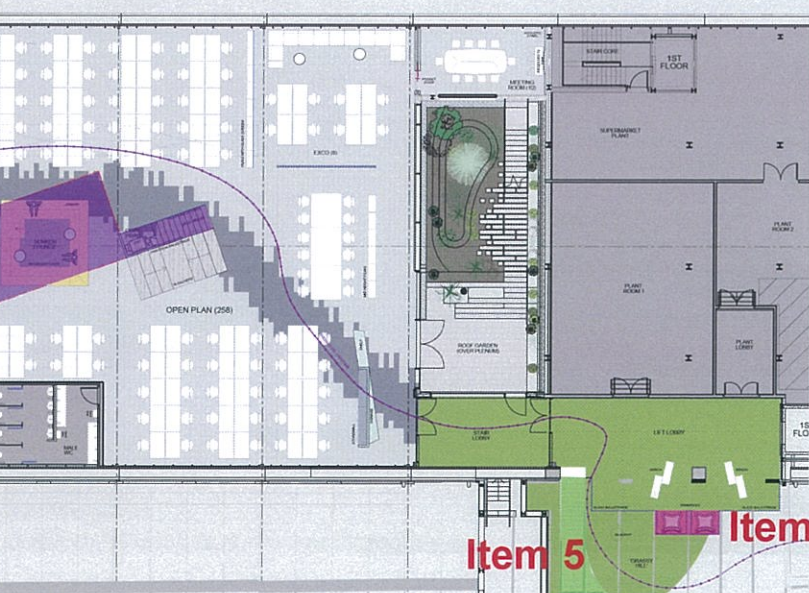



# Proposed entrance - Ground floor

View 1





# Proposed plans - Ground floor

The key architectural features described in the previous pages (12 and 13) have been carefully designed to compliment and enhance the existing building. The insertions are viewed as independent structures, maintaining sight lines and the overall volume of the space.

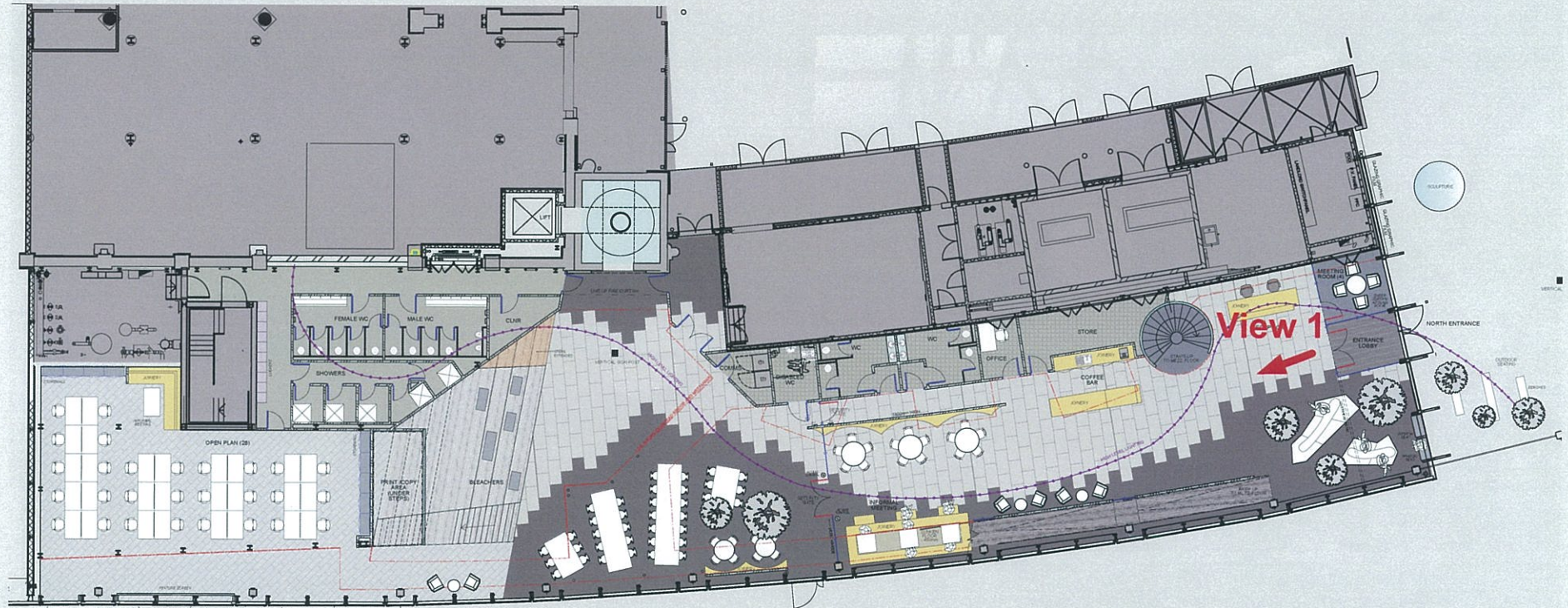



# Proposed cafe - Ground floor

View 2

