

GREEN WALL MAINTENANCE PLAN

It is recommended on installing an integrated irrigation system as per the details below. Typical maintenance operations are as follows:

- Check that the irrigation is performing as it should be. Full rootzone saturation, free flow, timing as per required setting. Checks should be undertaken by a qualified and competent maintenance operative fortnightly or in accordance with maintenance contract.
- Regularly check the plants. Trim off any unwanted growth or dead head as necessary. This should be undertaken by a qualified and competent maintenance operative fortnightly or in accordance with maintenance contract.
- Check for pests and diseases and treat accordingly by a qualified and competent maintenance operative fortnightly or in accordance with maintenance contract.
- Apply liquid feed such as All-purpose liquid feed by Miracle grow or similar at regular intervals by a qualified and competent maintenance operative, monthly or in accordance with suppliers instructions (care should be taken to avoid over feeding).
- Avoid over watering.
- Occasional topping up of compost will be required if integrating edible plants.

Irrigation
The simple to install Easiwall irrigation system is pre-made for convenience and will deliver a precise amount of water to the root zone in every trough. The irrigation system is self-cleaning, pressure regulated and anti-siphon. For optimal results it is recommended that it is used in conjunction with the Tap Timer or Controller.

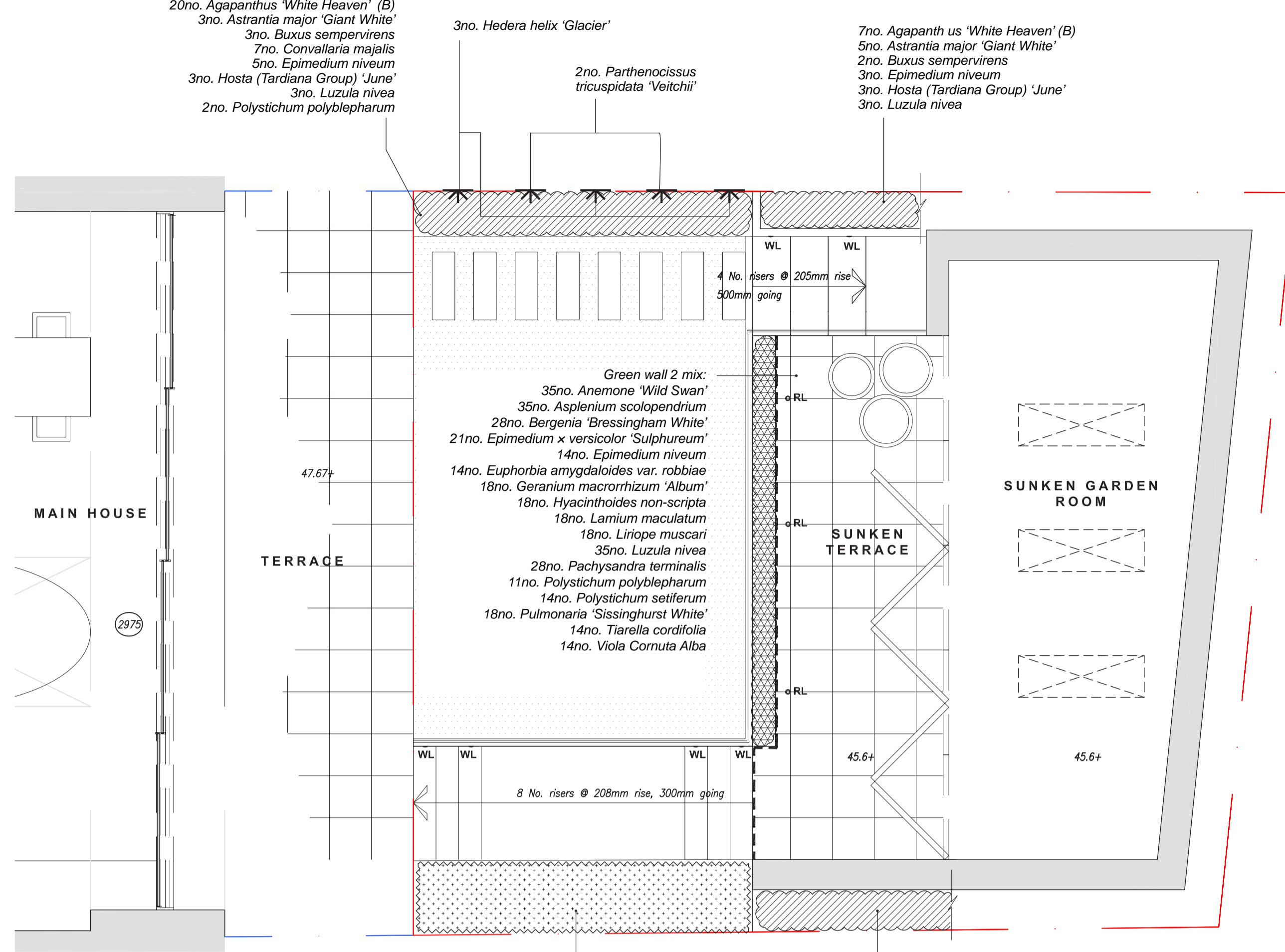

LOWER GROUND FLOOR PLANTING PLAN
1:50

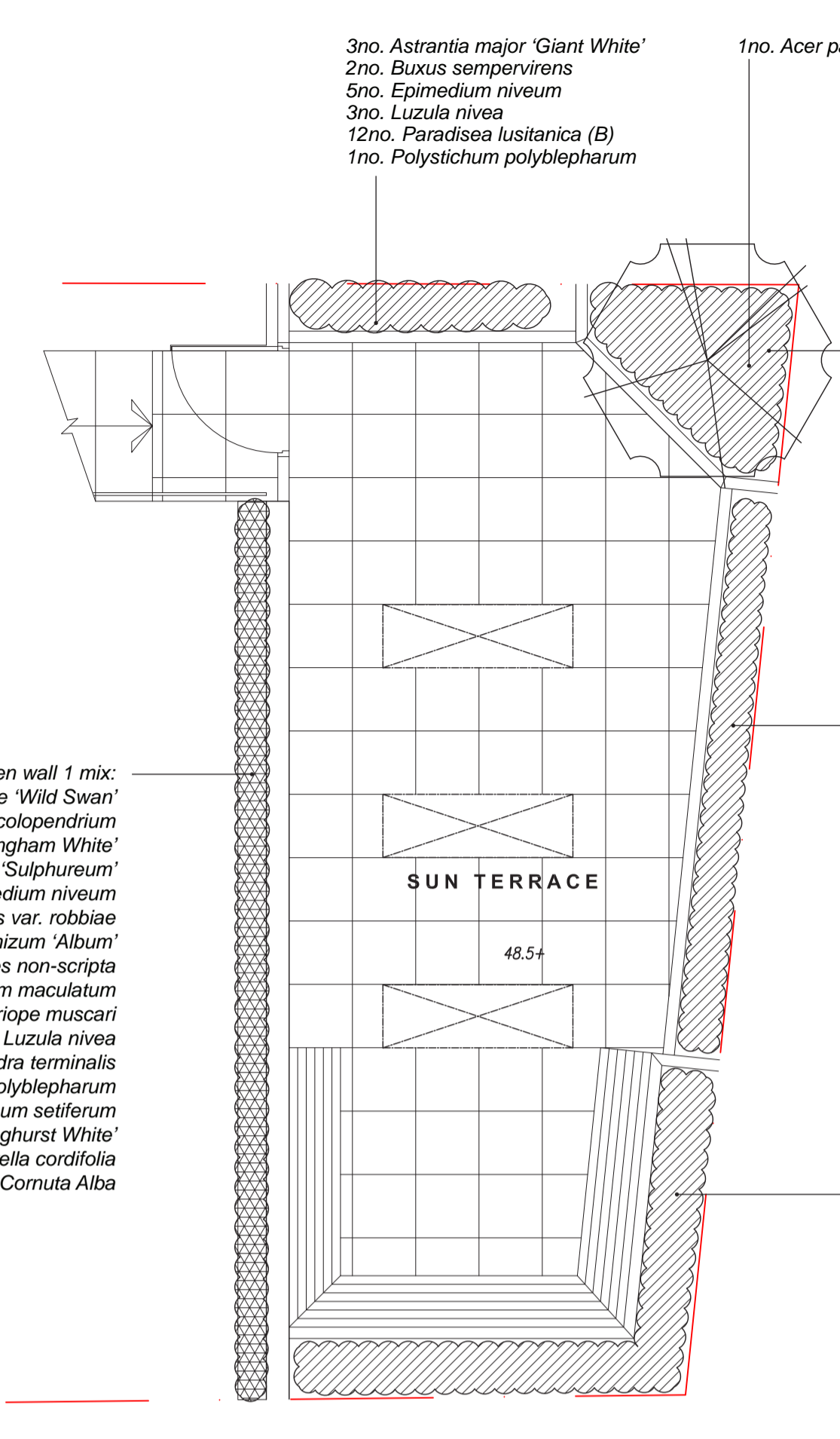

SUN TERRACE PLANTING PLAN
1:50

PLANTING PALETTE



PLANTING SCHEDULE

HERBACEOUS MIX		
Species	Pot size	Total
Atrantia major 'Giant White'	2L	23
Buxus sempervirens (clipped ball 35-40cm)	10L	12
Convallaria majalis	2L	43
Epimedium niveum	2L	47
Hosta (Tardiana Group) 'June'	2L	11
Hosta 'Sum and Substance'	2L	8
Luzula nivea	2L	33
Polystichum polyblepharum	2L	5
Polystichum setiferum	2L	6
Total plants		188

BULB LAYER		
Species	Total	
Agapanthus 'White Heaven'	43	
Paradisea lusitanica	33	
Total bulbs	76	

CLIMBERS		
Species	Pot size	Total
Hedera helix 'Glacier'	2L	3
Parthenocissus tricuspidata 'Veitchii'	2L	2
Total plants		5

GREEN WALL MIX						
Species	Pot size	no./m2	% mix	Wall 1	Wall 2	Total
Anemone 'Wild Swan'	1L		35	10	53	35
Asplenium scolopendrium	1L		35	10	53	35
Bergenia 'Bressingham White'	1L		35	8	42	28
Epimedium x versicolor 'Sulphureum'	1L		35	6	32	21
Epimedium niveum	1L		35	4	21	14
Euphorbia amygdaloides var. robbiae	1L		35	4	21	14
Geranium macrorrhizum 'Album'	1L		35	5	27	18
Hyacinthoides non-scripta	1L		35	5	27	18
Lamium maculatum	1L		35	5	27	18
Liriope muscari	1L		35	5	27	18
Luzula nivea	1L		35	10	53	35
Pachysandra terminalis	1L		35	8	42	28
Polystichum polyblepharum	1L		35	3	16	11
Polystichum setiferum	1L		35	4	21	14
Pulmonaria 'Sissinghurst White'	1L		35	5	27	18
Tiarella cordifolia	1L		35	4	21	14
Viola Cornuta Alba	1L		35	4	21	14
Total plants						884

CLIMBERS			
Species	Pot size	Height	Total
Hedera helix 'Glacier'	2L		3
Parthenocissus tricuspidata 'Veitchii'	2L		2
Total plants			5

SMALL TREE/SHRUB			
Species	Pot size	Height	Total
Acer palmatum 'Atropurpureum'	45L	120-150cm	1

HEDGING				
Species	Pot size	Height	Spacing	Total
Taxus baccata	15L	120-150cm	3/linear m	14

C 16.09.16 EP EP
DWG UPDATED WITH ADDITIONAL MAINTENANCE REQUIREMENTS TO GREEN WALL

B 01.08.16 MJ MJ
DWG UPDATED WITH MAINTENANCE REQUIREMENTS TO GREEN WALL

A 10.05.16 LL MJ
DWG UPDATED WITH COMMENTS FROM

FOR PLANNING

the landscape agency
Aviator Court, Clifton Moor, York, YO30 4UZ
Tel: 01904 691630 Fax: 01904 691634
enquiries@landscapeagency.co.uk
www.landscapeagency.co.uk

client
MR O'BRIEN

project
38 REGENTS PARK ROAD

title
PLANTING PLAN

scale 1:50@A1 date 07.04.2016

drawn EP checked MJ

drawing number 1049-03 revision B

DO NOT SCALE FROM THIS DRAWING
© The Landscape Agency