

KING HENRY'S ROAD

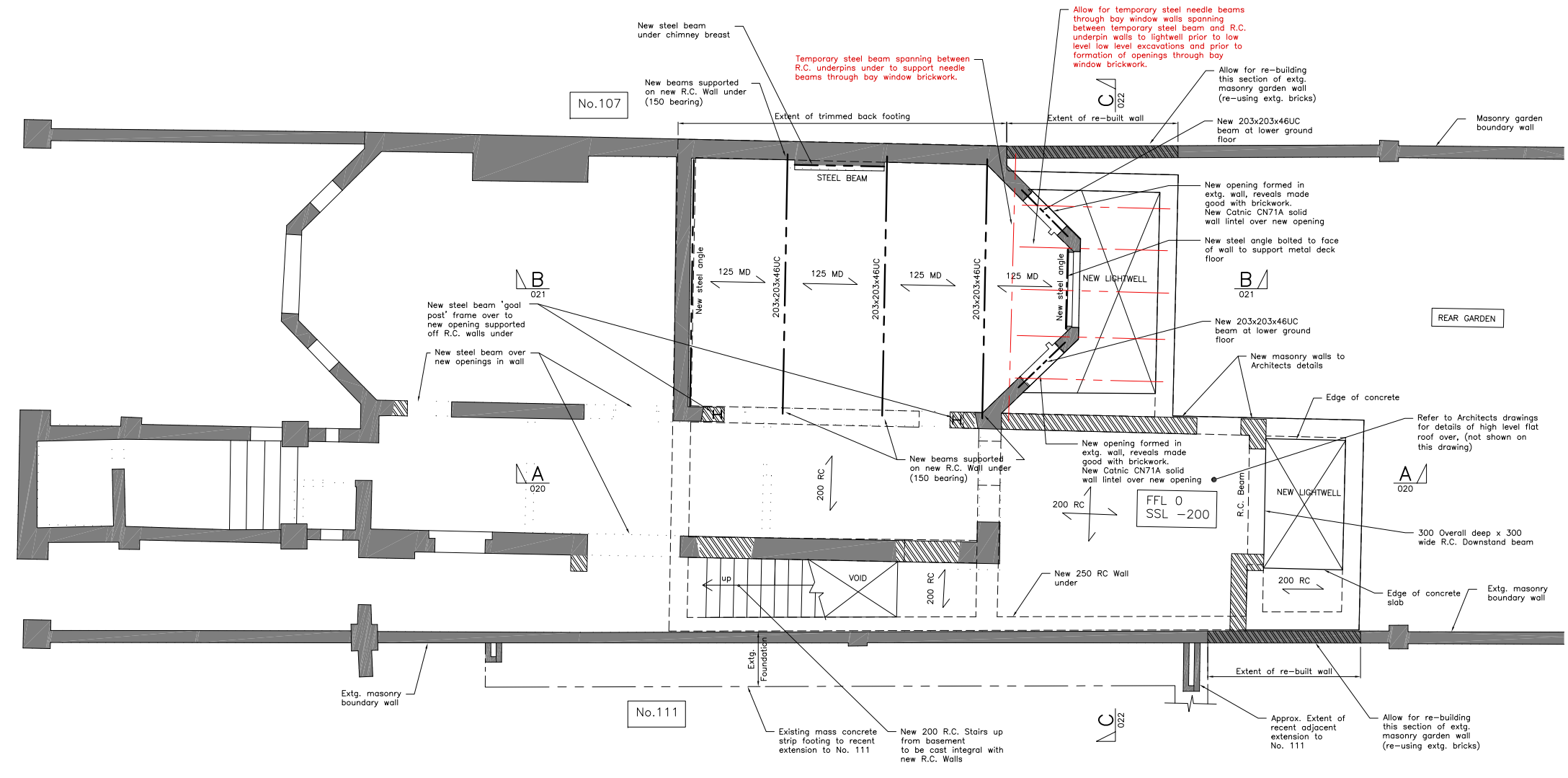

- NOTES:**
- All structural engineering drawings are to be read with the specification and with all relevant Architect's and Service Engineer's drawings and specifications.
 - Do not scale from this drawing in either paper or digital form. Use written dimensions only.
 - All dimensions are in millimetres and levels in metres.

- LEGEND:-**
- Denotes existing masonry wall.
 - Denotes new brick wall. (to be fully tooth bonded into existing)
 - Denotes new structure under
 - Denotes walls to be demolished
 - Denotes new steel beam
 - Denotes new 200 thick R.C. Insitu suspended solid slab
 - Denotes span of new 125 overall thick R.C. insitu metal deck slab comprising of 51 deep metal deck 0.9mm gauge reinforced with one layer of A193 mesh in top with 25 top cover

NOTE:-
LIGHTWEIGHT NON-LOADBEARING PARTITIONS ARE NOT SHOWN ON THIS DRAWING REFER TO ARCHITECTS DRAWINGS FOR DETAILS

Rev	Date	Issued	Amendment
B	09.08.16	SH	UPDATED
A	07.10.15	DJP	UPDATED
-	18.06.15	DJP	ISSUED FOR PLANNING

Status **PLANNING**

SINCLAIR JOHNSTON
Consulting Civil & Structural Engineers

93 Great Suffolk Street
London SE1 0BX
T: 020 7593 1900
F: 020 7593 1910
www.sinclairjohnston.co.uk

**109 KING HENRY'S ROAD
LONDON NW3**

**PROPOSED LOWER GROUND
FLOOR PLAN**

Drawn D Phillips Scale 1:50 at A1

Project No./Drawing No. **8438/009** Rev **B**