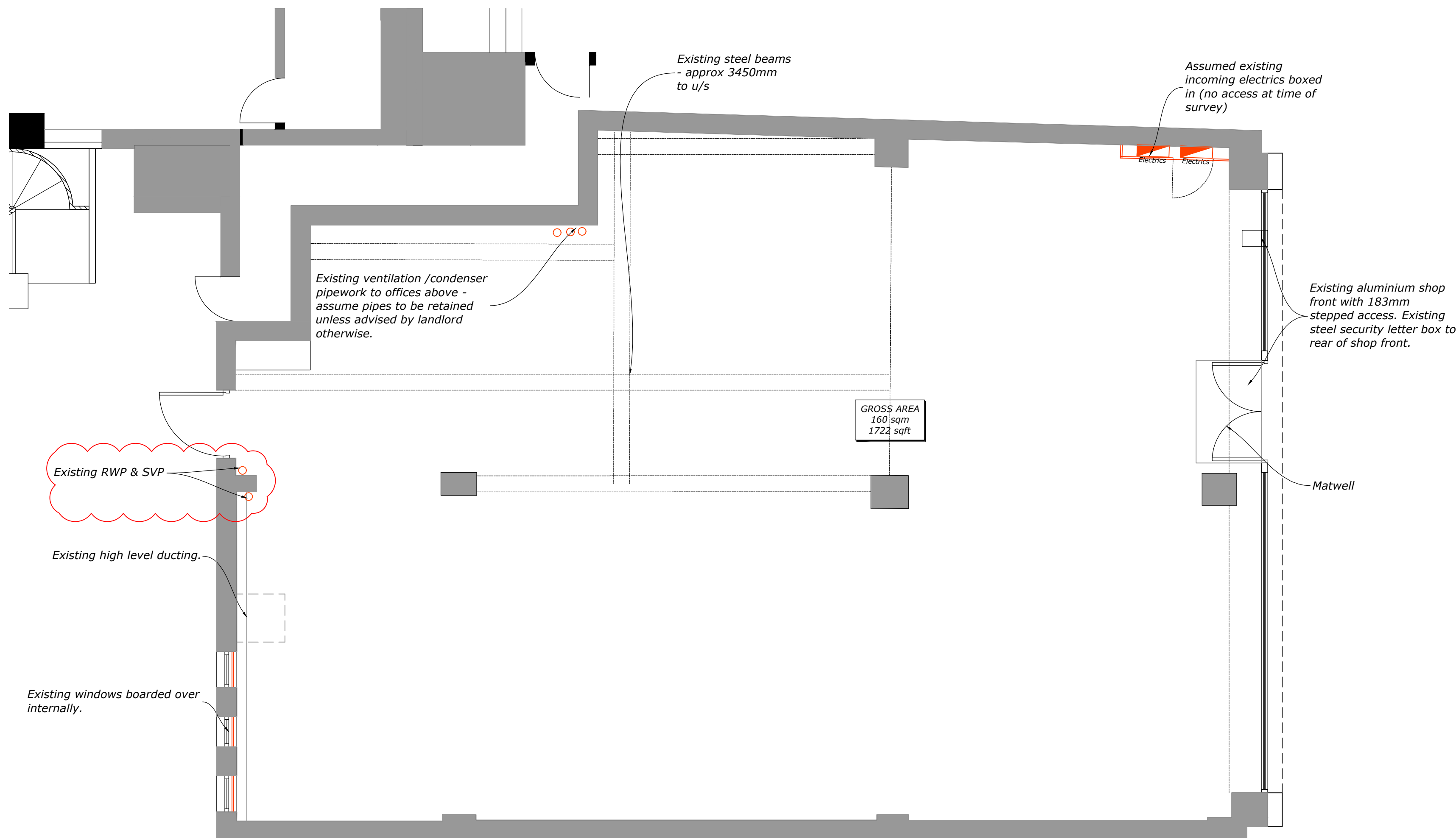

[illegible]

Existing GA Layout
Scale 1:50

- The contractor must verify all dimensions on site before any works are undertaken, discrepancies are to be reported to the project architect/designer for clarification.
- All works will be carried out in accordance with the SUPERDRUG NFOS document & are to comply with the tenants fit out guidelines following landlords approval.
- HVAC, M&E layouts are indicative & must be verified with the relevant contractor before commencement of work.
- All works to be carried out in accordance with the fire strategy and fire cert application schedule produced by the landlord team issued at tender.
- The existing/proposed sprinkler system is to be assessed by a contractor to ensure the system is in compliance with building regs part B.
- This drawing remains the property of ASWORTH SUPERDRUG and may not be reproduced in any way without prior consent.

AREA SCHEDULE			
AREA	Ground Floor SqM / Sqft	First Floor SqM / Sqft	
Gross Area	160/1722		
Total Sales			
Total BOH			
- Staff Room			
- Managers Office			
- Toilets			
- Warehouse			
- Circulation Area			
- Void			
DRAWING TITLE			
EXISTING GA			
DRAWING NUMBER			REVISION
CPS 16 078 002			A
SCALE	DATE	DRAWN	CHECKED
1:50 @ A1	19.07.16	DL	+
PROJECT			
133 CLERKENWELL ROAD			
LONDON			

STATUS

L2

118 Northampton Lane
Croydon
Surrey
CR9 4TB

☆

Superdrug

502 BEECHWOOD ONE BUSINESS PARK
LEWISHAM ROAD,
SOUTHWOOD,
BARNET, Herts
MK45 7GB

cube.

Tel: 01295 832715
E-mail: advertising@cube.co.uk
Web: www.cubepri.co.uk