

PROPOSED REAR ELEVATION



ROOF EXTENSION OVER REAR ADDITION VOLUME

$$2.85 \times 1.98 + 2.85 \times 0.115 / 2 = 5.8m^2$$

$$5.8m^2 \text{ (area)} \times 4.34m \text{ (length)} = 25.2m^3$$

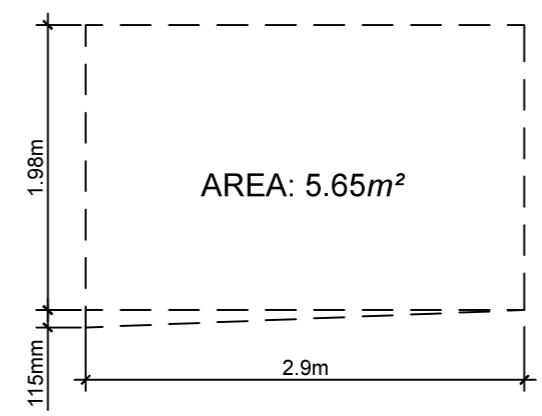

DORMER TO MAIN ROOF VOLUME

$$4.04 \times 3.05 \times 2.4 / 2 = 14.79m^3$$

TOTAL VOLUME

$$25.2m^3 + 14.79m^3 = 39.99m^3$$

Note:
This drawing has been drawn to scale for the purposes of obtaining local authority approval. Any measurements required for construction must not be scaled from this drawing.
All structural elements to be agreed with local authority Building Control prior to commencement of works.
Attention is drawn to the provisions of the party wall act 1996. Legal boundaries should be determined by others.



Revive Renovations

Planning & Technical Drawings
www.revive-renovations.com

client
Toby Vanhegan
23 Ingham Road, NW6 1DG

project
CERTIFICATE OF LAWFULNESS APPLICATION
Rear roof extension

drawing title
PROPOSED REAR ELEVATION

date
AUG 2016

scale
1:50@A3

dwn
DM

drawing number
006

sheet no.
6 OF 14

rev
A