

KEY PLAN
NOTE:
ALL INFORMATION SHOWN ON THIS DRAWINGS IS SUBJECT TO DESIGN DEVELOPMENT

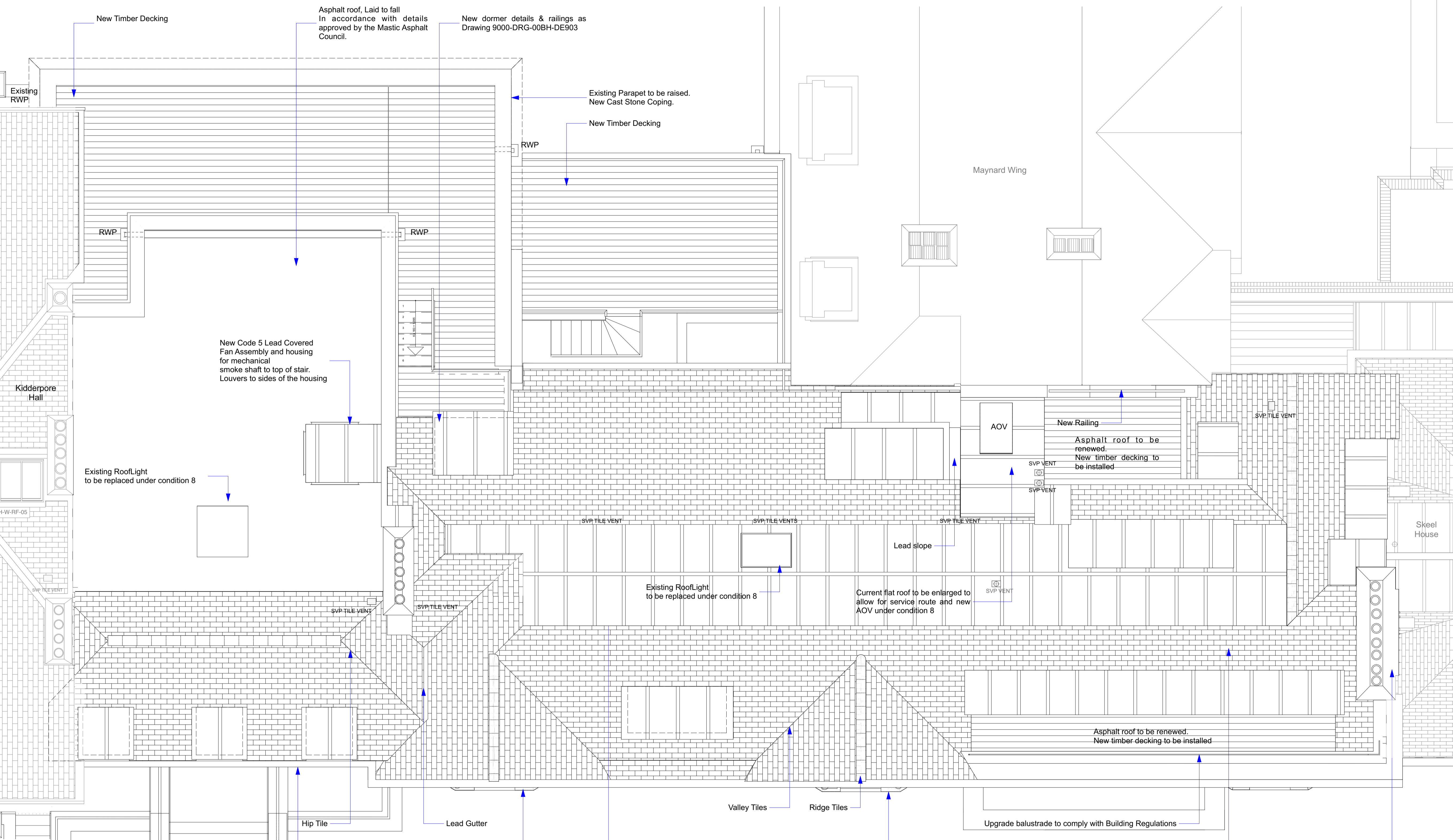

PLANNING

REVISION	DRN	CHKD	DATE
- First Issue	K/C/GC	KC	11/07/2016
A Planning comments incorporated	K/C/GC	KC	15/08/2016



CLIENT
MOUNT ANVIL LTD

PROJECT
KIDDERPORE AVENUE

DRAWING
Bay House
Level RF Proposed GA Plan

SCALE 1:50 @ A1 DATE August 2016

DRAWING No. 9000-DRG-03BH-RF910 DRAWN BY K/C/GC REV A

A & Q PARTNERSHIP (LONDON) LTD
THE LUX BUILDING, 2-4 HOXTON SQUARE, LONDON N1 6 NU
Tel: 020 7613 2244 Fax: 020 7613 2642 Email: london@aqp.co.uk
ARCHITECTURE DESIGN MASTERPLANNING INTERIORS

NOTE:
For brick cleaning and brick repointing methods please refer to drawing number 9000-DRG-00GN-AL040.