

NOTE:
CONTRACTOR TO ALLOW IN HIS TENDER FOR THE ALTERNATIVE OPTION OF A 700mm THICK R.C. RAFTER THROUGHOUT.

- NOTES
- THIS DRAWING IS TO BE READ IN CONJUNCTION WITH ALL RELEVANT ARCHITECT'S AND ENGINEER'S DRAWINGS AND THE SPECIFICATION.
 - DO NOT SCALE FROM THIS DRAWING.
 - FOR GENERAL NOTES SEE DRAWING 1636/001/100.
 - FOR PILE SCHEDULE AND TYPICAL PILE SECTIONS SEE DRAWING 1636/001/95.
 - FOR CONTIGUOUS PILED WALL PERFORMANCE REQUIREMENTS SEE SPECIFICATION AND DRAWING 1636/001/96.
 - CONTRACTOR TO CONFIRM THE PROPOSED SEQUENCE OF INSTALLATION OF THE PILES THEY INTEND TO ADOPT.
 - DIAMETER, SPACING AND LENGTH OF PILES ARE GIVEN FOR COSTING PURPOSES. PILES TO BE DESIGNED BY THE CONTRACTOR.

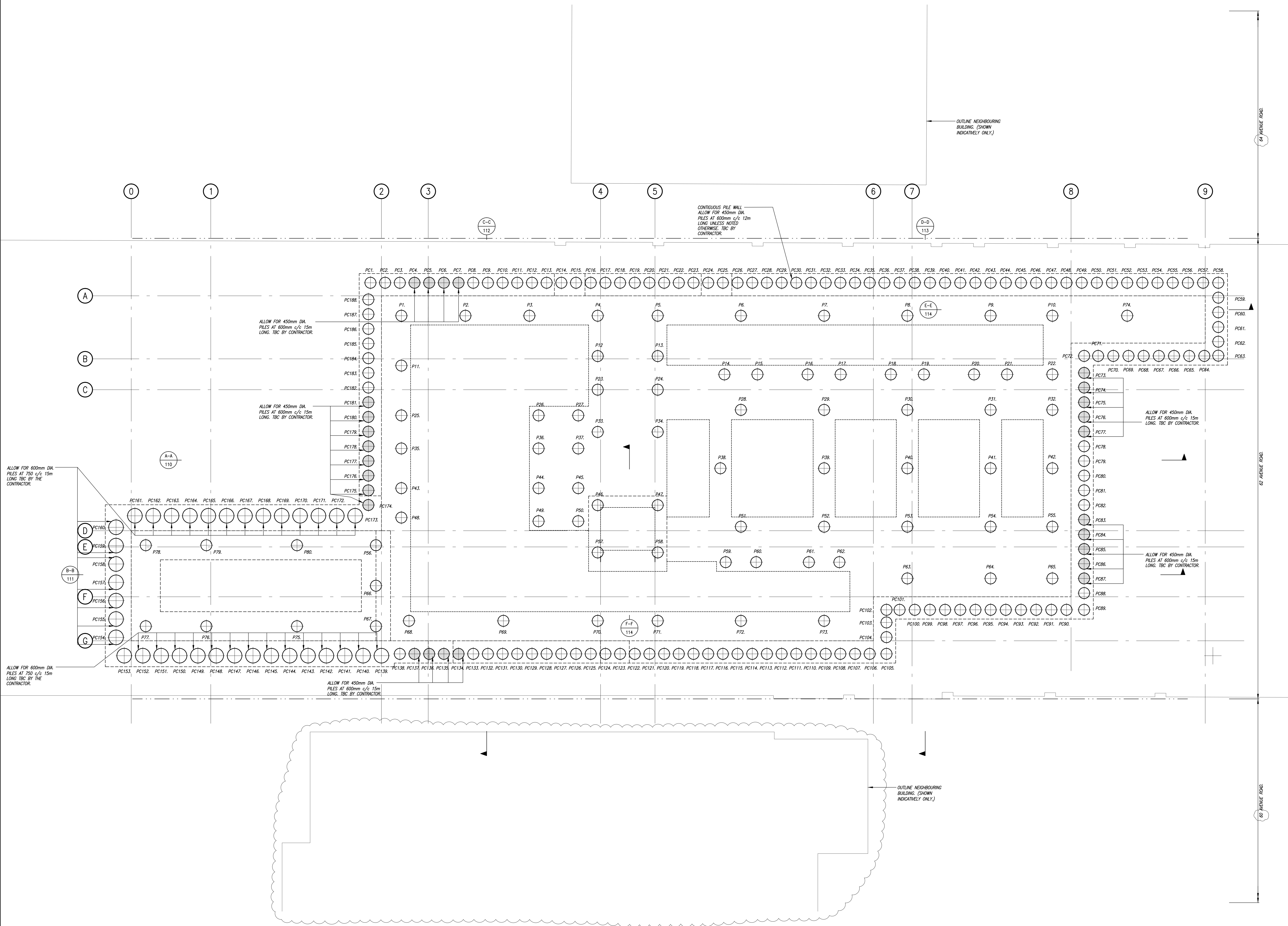

NOT FOR CONSTRUCTION

A	05.09.16	ISSUED FOR PLANNING, EXTENT OF ADJACENT PROPERTY & NOTES REVISID.	LF
	07.06.13	ISSUED FOR TENDER.	LF

62 AVENUE ROAD	
PROPOSED PILING PLAN	
drawn MM	checked LF
date MAY'13	scale (original - A0) 1:50

Alan Baxter

75 Cowcross Street, London EC1M 6EL
 tel 020 7250 1555
 email aba@alanbaxter.co.uk
 www.alanbaxter.co.uk

09p. no.	1636/001/97	rev.	A
----------	-------------	------	---