

No 265 TOTTENHAM COURT ROAD  
TOTTENHAM COURT ROAD ELEVATION  
SCALE 1:100@A1

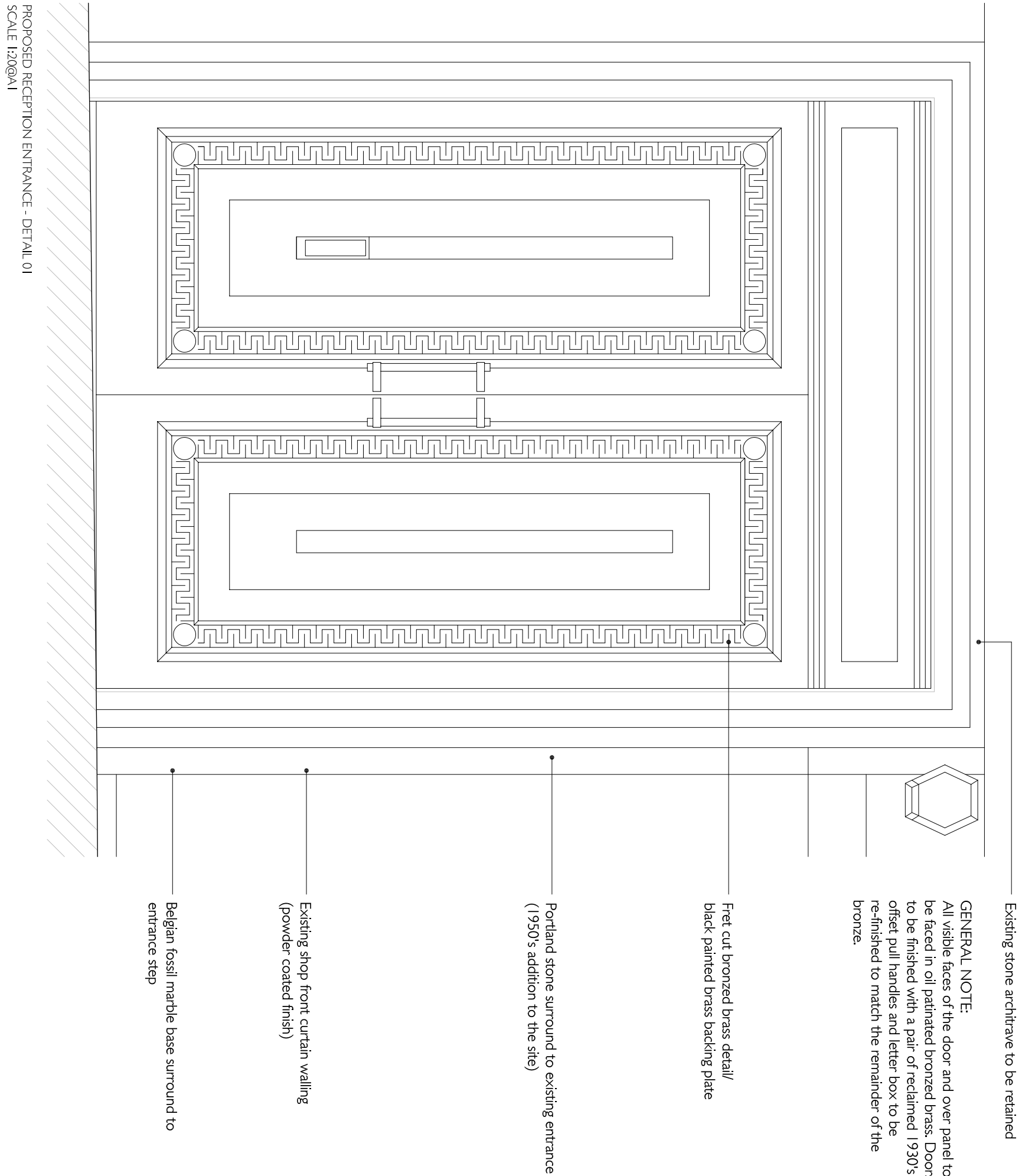

PROPOSED RECEPTION ENTRANCE - DETAIL 01  
SCALE 1:200@A1

- ANNOTATION KEY:
- 01 Existing windows to be refurbished throughout. Paintwork to be stripped back and re-painted in a bronze colour (general note).
  - 02 Existing external Portland stonework to be repaired/cleaned to all elevations (general note) plus new pigeon deterrent applied.
  - 03 Existing signage/shopfront to retail unit at ground-first floor to be retained. No works proposed to this area.
  - 04 Original Portland stone detailing and cornice work to be repaired/reconditioned where necessary
  - 05 Proposed set-back, toughened glass balustrade to roof terrace perimeter (incl. concealed up-lighter to base of glazed panel)
  - 06 New full height glazing to new elevation to provide service and maintenance access to existing external-terrace (PPC frame/ RAL colour tbc). Refer To dwg P(-)23 for localised elevation and section--
  - 07 Perforated metal panels to form screening to roof level plant (2.5m above roof terrace flt)
  - 08 Applied through colour render (white finish) to extension of existing lift/stair core serving 7th floor roof terrace. PPC coping profile to head of rendered elevation (RAL colour tbc)
  - 09 Full height glazed frontage to 7th floor stair/lift core. To include full height glazed access doors to terrace area
  - 10 Existing service grilles/louvers replaced with metal framed glazed units to match existing unit within listed, southern facade i.e. to match original fabric.
  - 11 Glazed unit to be introduced to Portland stone facade to provide daylight to new atrium beyond. (PPC frame/ RAL colour tbc).

Existing stone architrave to be retained

GENERAL NOTE:  
All visible faces of the door and over panel to be faced in oil patinated bronzed brass. Doors to be finished with a pair of retilined 1930's offset pull handles and letter box to be re-finished to match the remainder of the bronze.

First cut bronzed brass detail/ black painted brass backing plate

Portland stone surround to existing entrance (1930's addition to the site)

Existing shop front curtain walling (powder coated finish)

Belgian fossil marble base surround to entrance step

TREHEARNE ARCHITECTS

CONINTHIAN HOUSE  
TOTTENHAM COURT ROAD, LONDON

ELEVATION A  
PROPOSED

DATE: 08 16  
DRAWN BY: L1665  
CHECKED BY: PT(-)10  
SCALE: 1:100@A1  
PROJECT: 310816  
LOCATION: 310816  
DRAWING NO: 010  
REVISION: B

\* 172616 DJ PLANNING SUBMISSION

A 080716 DJ WINDOW WALKOUT AMENDMENT ITEM 06

B 310816 PDC PLANNING AMENDMENT