



Canterbury Mansions Lymington Road London NW6 1SE  
Telephone: 020 7794 9494 Facsimile: 020 7794 9444  
Email: office@regalmain.co.uk

*2016/6/30/NEW  
AD*

Development Management  
Camden Town Hall Extension  
Argyle Street  
London  
WC1H 8EQ

26/08/2016

Dear Sir or Madam,

**RE: Bike Storage- Canterbury Mansions**  
**Appeal REF: APP/X5210/A/13/2198015**

Please see enclosed the following:

- Glass sample for supported roof
- 2 photos of the grating to be used on the platform
- Gate design
- (you have already received iron sample for the gate)

Can you please confirm if these samples are acceptable to you.

Yours faithfully,

A handwritten signature in black ink, appearing to read 'C O'Callaghan'.

Chris O'Callaghan  
Company Director





CAUTERBURY MANSIONS NWG  
CYCLE STORE  
ELEVATION OF ENTRANCE SCREEN  
SCALE 1/20



NOTE  
ALL METAL  
SECTIONS TO  
BE SQUARE  
ON PLAN

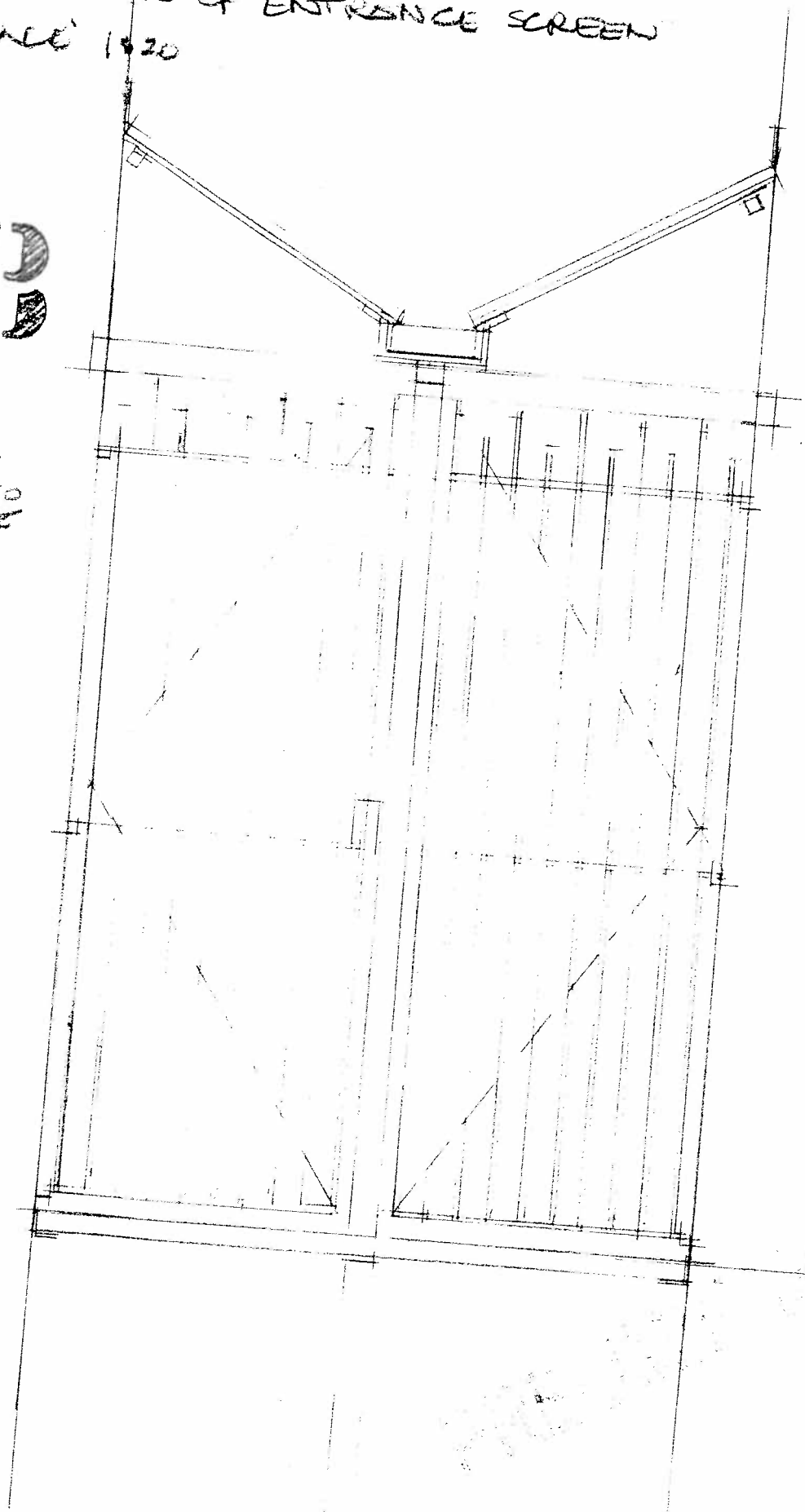

MORRIS FRANKLIN  
Chartered Architect

SHEET SIZE A4