

THIS IS A PRELIMINARY DESIGN AND SHOULD NOT BE TAKEN AS A COMMITMENT. THE DESIGN IS SUBJECT TO CHANGE AND SHOULD BE USED FOR INFORMATION PURPOSES ONLY AND MUST NOT BE USED FOR INSTALLATION PURPOSES.

- LEGEND
- DEBITS EXISTING PIPE WORK
 - DEBITS NEW PIPE WORK OPTION A
 - DEBITS NEW PIPE WORK OPTION B
 - DEBITS NEW INSULATION
 - ★ DEBITS NEW SOLARWAVE MATS

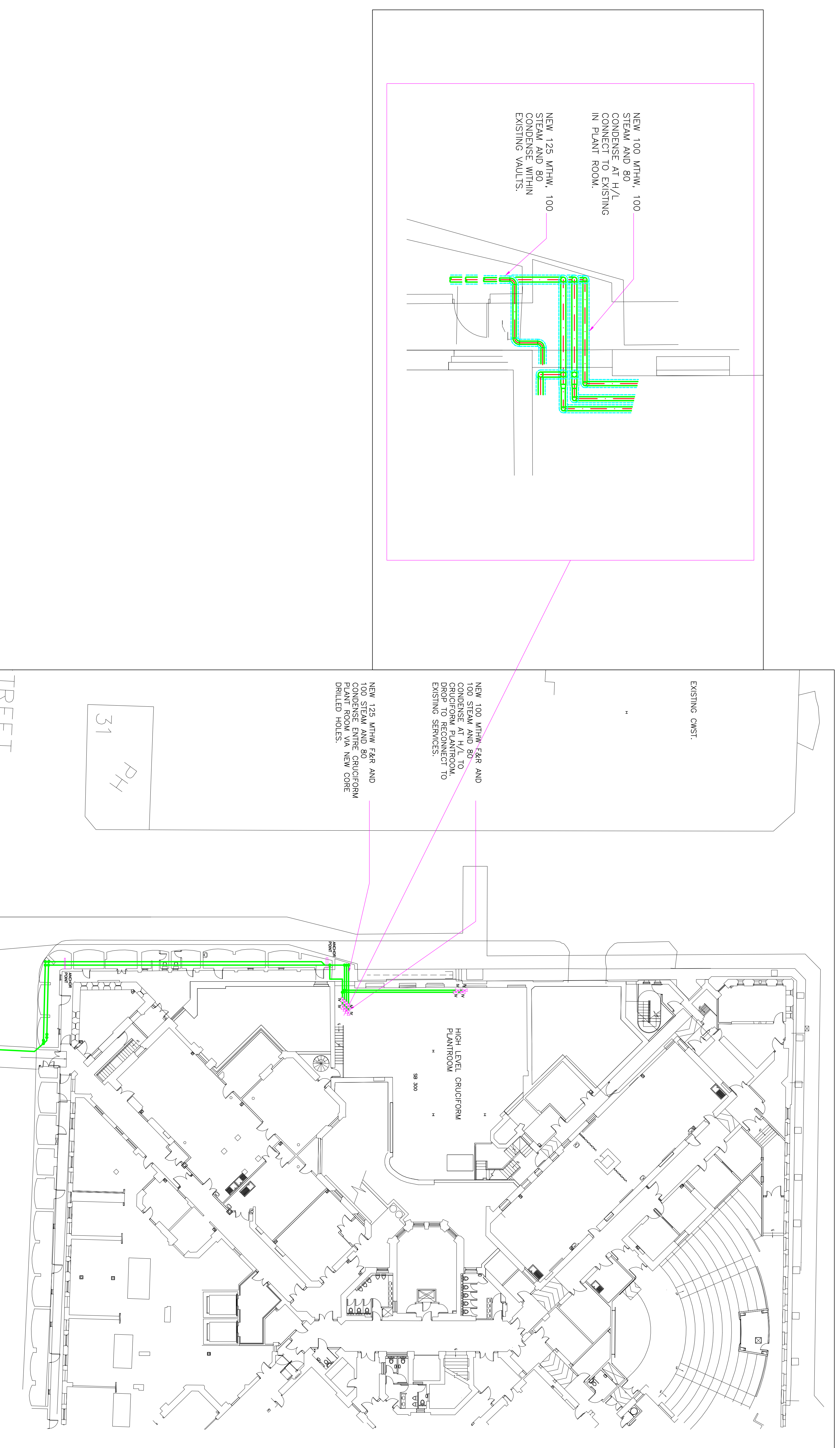

Ref	Date	Description	By	App

Location Plan:

UNIVERSITY COLLEGE LONDON
ESTATES
GOWER STREET
LONDON
WC1E 6BT

Project:
STEAM AND MHW PIPEWORK
PERMANENT DIVERSION FROM
PLANT ROOM
TO CRUCIFORM

Title:
ROUTE OF NEW MHW, STEAM AND
CONDENSE BETWEEN ROCKETFELLER
AND CRUCIFORM PLANT ROOMS WITHIN
BASEMENT

Date:	11-02-16	Designed by:	IR
Drawn by:	AO	Approved by:	IM
Scale:	1:200 & 1:50	Drawn by:	IR
Doc Ref:	1496-MS-Planning		

