

0 1km 2km  
Scale

### SITE LOCATION (Scale 1:50000)

Ordnance Survey map extract  
based upon Landranger map series  
with the permission of the controller of  
Her Majesty's Stationery Office  
Licence No. 0100023487  
Crown copyright.



SITE PHOTOGRAPH

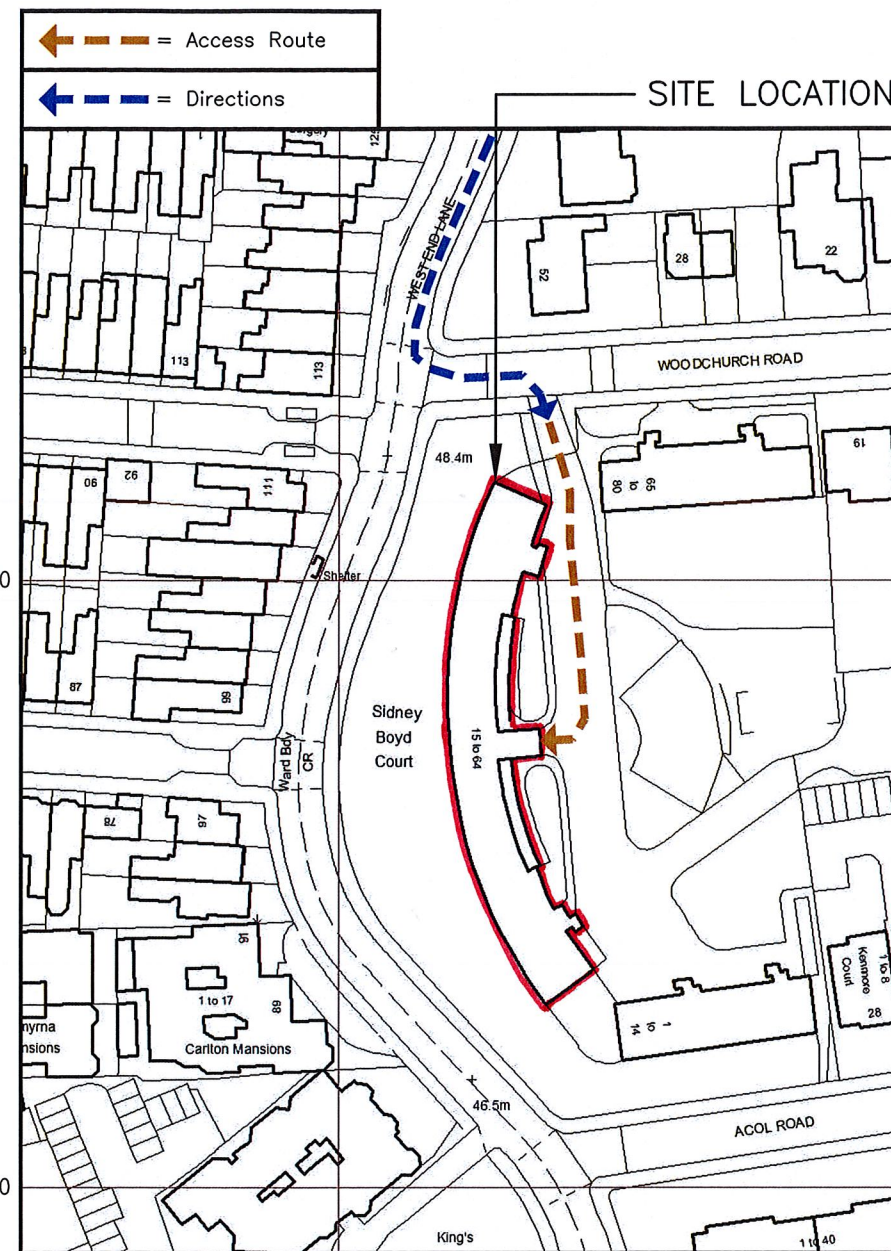
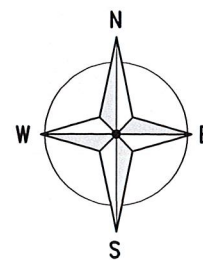

### DETAILED SITE LOCATION (Scale 1:1250)

Based upon Ordnance Survey map extract  
with the permission of the Controller of  
Her Majesty's Stationery Office.  
Crown copyright.  
Licence No. 100020449

50 0 50 100 150  
ORIGINAL SCALE AT A3 - 1:1250 ALL DIMENSIONS IN METRES

ALL DIMENSIONS ARE IN mm UNLESS NOTED OTHERWISE

N.G.R E: 525428 N: 184177

CONCESSION REQUIRED NO

DIRECTIONS TO SITE:  
LEAVE M1 AT JUNCTION 1 AND TAKE  
SLIPROAD LEFT ON TO A406 TOWARDS  
CENTRAL LONDON. AT THE ROUNDABOUT TAKE  
THE THIRD EXIT AND CONTINUE STRAIGHT ON  
TO BRENTFIELD GARDENS. CONTINUE STRAIGHT  
ON TO A41 HENDON WAY. AFTER 1.8 MILES  
TURN RIGHT ON TO CANNON HILL THEN TURN  
RIGHT ON TO WEST END LANE. TURN LEFT TO  
STAY ON WEST END LANE. TURN LEFT ON TO  
B510 WEST END LANE. AFTER 0.6 MILES  
TURN LEFT ON TO WOODCHURCH ROAD THEN  
IMMEDIATELY RIGHT AGAIN IN TO THE PARKING  
AREA BEHIND SIDNEY BOYD COURT.

NOTES:

A	Issued for Approval	BB	CT	15.03.16
REV	MODIFICATION	BY	CH	DATE

**GallifordTry**  
WOLVEY - HINCKLEY - LEICESTERSHIRE - LE10 3JF  
Tel: +44 (0)1455 222792 Fax: +44 (0)1455 222758

**O<sub>2</sub>**  
Beacon

Cell Name	Opt.
SIDNEY BOYD COURT	-

Cell ID No		
CTIL	TEF	VF
208310	078643	N/A

Site Address / Contact Details  
SIDNEY BOYD COURT  
WEST END LANE  
CAMDEN  
LONDON  
NW6 4RB

Drawing Title:  
SITE LOCATION MAPS

Purpose of issue:  
PLANNING

Drawing Number:  
100

Surveyed By: CT	Original Sheet Size: A3	Issue: A
Drawn: BB	Date: 15.03.16	Checked: CT
	Date: 15.03.16	