

Detail 1: Typical Ground Bearing Slab Internal  
Detail  
scale 1 : 25

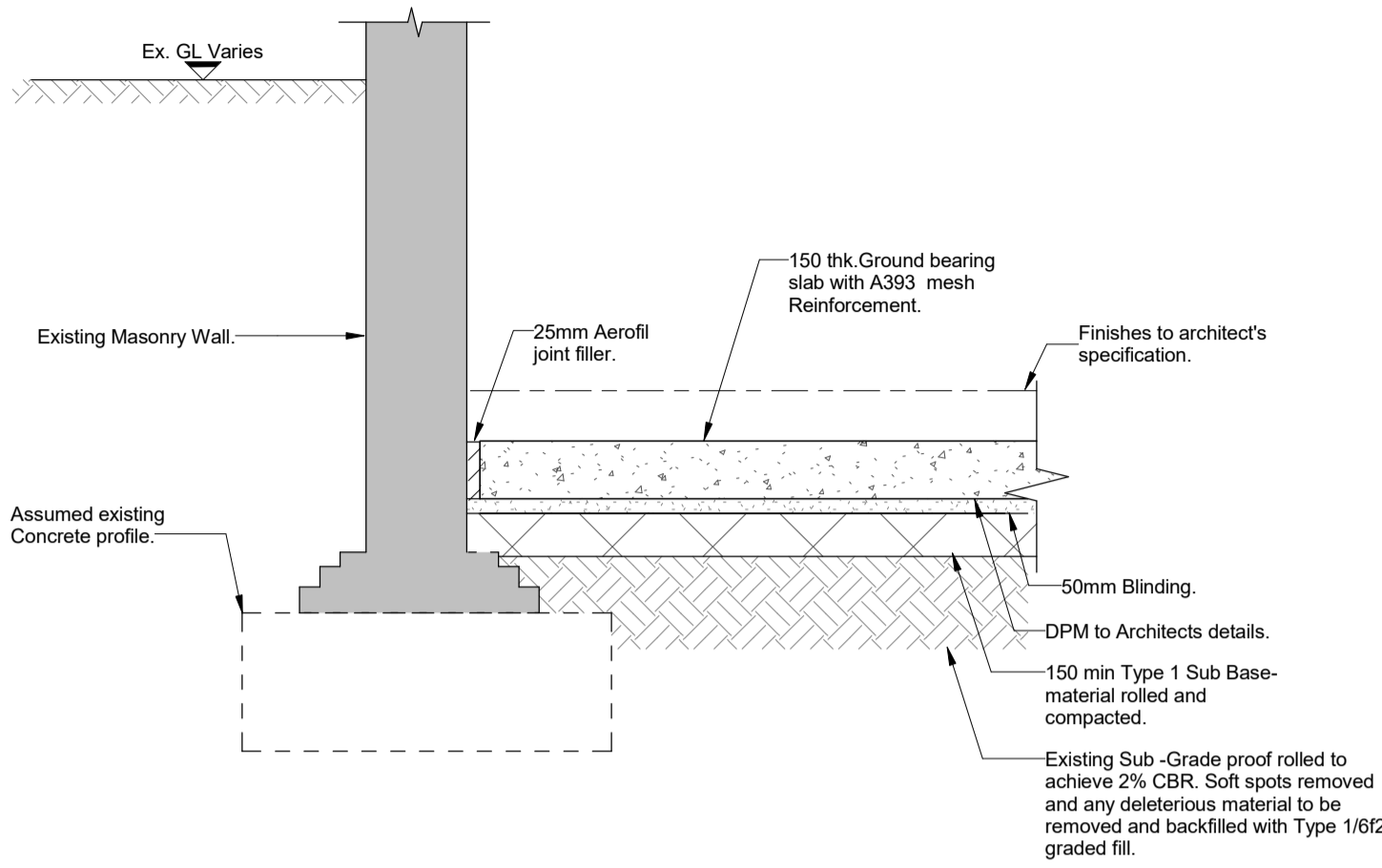

Detail 2: Typical Ground Bearing Slab Edge  
Detail Where Underpinning is not Required  
scale 1 : 25

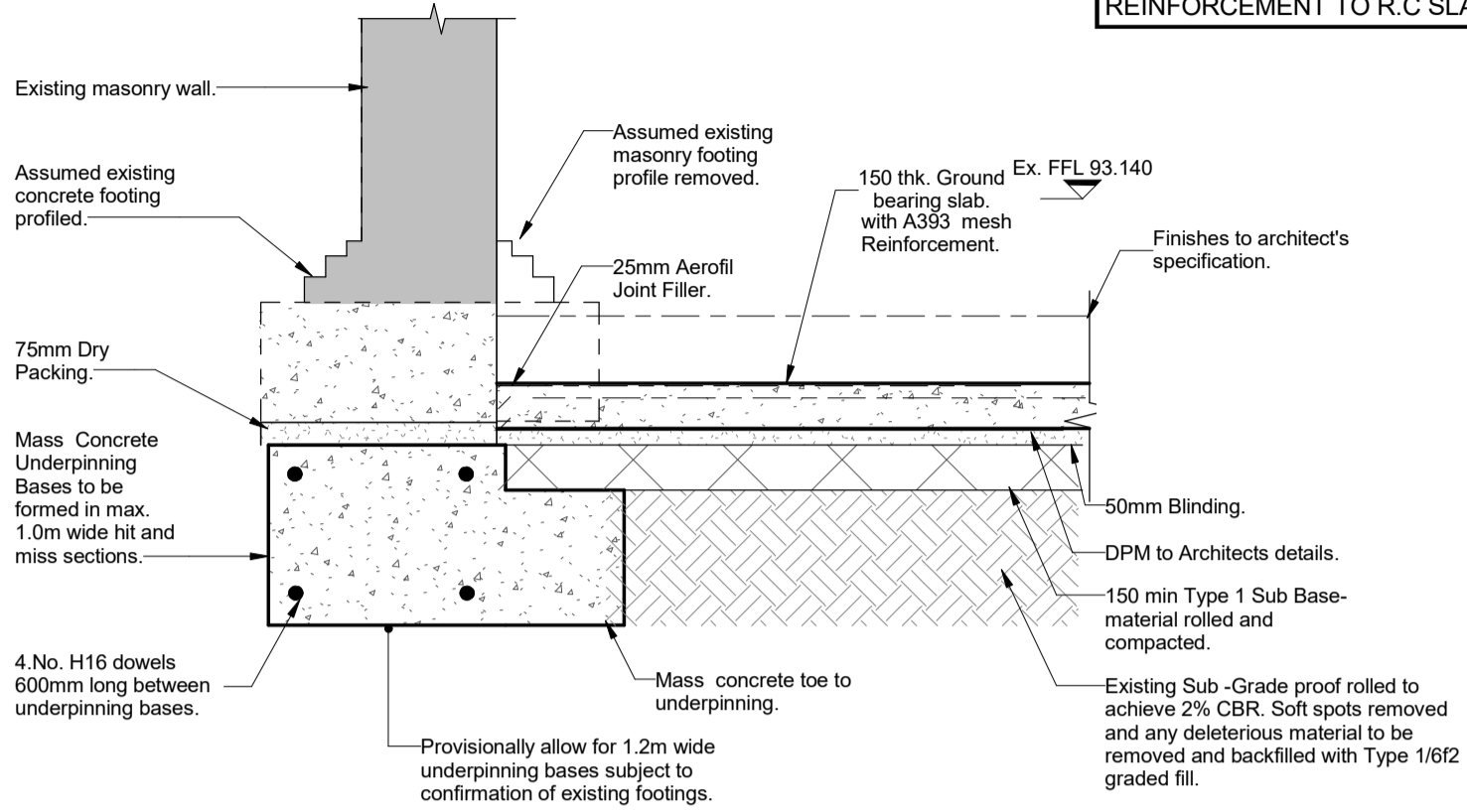

Detail 3: Typical Ground Bearing Slab Edge  
Detail Where Underpinning Required.  
scale 1 : 25

NOTE  
CONTRACTOR TO PROVIDE ALTERNATIVE PRICE WHICH EXCLUDES COMPACTION OF EXISTING SUB-GRADE BUT INCLUDES 2nd LAYER OF A393 BOTTOM MAT REINFORCEMENT TO R.C SLAB.

#### General Notes

1. Drawings shall be referred to for structural work only unless otherwise stated and read in conjunction with Architect's, Service Engineer's and Sub-Contractor's drawings.
2. The Contractor shall check all levels and dimensions, any errors or omissions are to be reported at once to the Engineer.
3. Existing layouts and levels based upon Murphy's surveys information received to date (February 2016)
4. For Key and Member Schedules refer to drawing no. 9100-DRG-99YY-GN010.
5. For General Notes refer to drawing no. 9100-DRG-99YY-GN002.
6.  Indicates areas of concrete to be formed in waterproof concrete.

NOTE  
FURTHER TRIAL PITS REQUIRED TO CONFIRM EXISTING FOOTINGS AND HENCE EXTENT OF UNDERPINNING REQUIRED.

NOTE  
WATERPROOFING STRATEGY TO BE CONFIRMED BY OTHERS.

NOTE  
REFER TO DRAWING No. 9100-DRG-03SK-LG001 & GF001 FOR SECTION LOCATIONS.

NOTE  
QUOTED TOP OF CONCRETE LEVELS (TOC) TO BE CONFIRMED BY ARCHITECT.

NOTE  
REFER TO DRG No. 9100-DRG-00YY-DE007 FOR GROUND BEARING SLAB REINFORCEMENT PRINCIPLES.

REV	DATE	DESCRIPTION	BY	CHKD
01	08.16	First Issue.	DA	TP

FOR TENDER

MOU  
NTA  
NVIL

TITLE: Skeel Library Lower Ground Floor Sections Sheet 2 of 2			
PROJECT: Project No. 11581 Kidderpore Avenue			
SCALE: A1@ 1:25	DATE: Aug'16	DRAWN: DA	CHKD: TP
DRG NO.	REV.		
9100-DRG-00SK-LG002	-		

Tully De'Ath  
consultants

Engineering at its Best

T: 01342 828 000  
E: info@tullydeath.com  
W: www.tullydeath.com