

Existing GF Plan
Scale 1:100

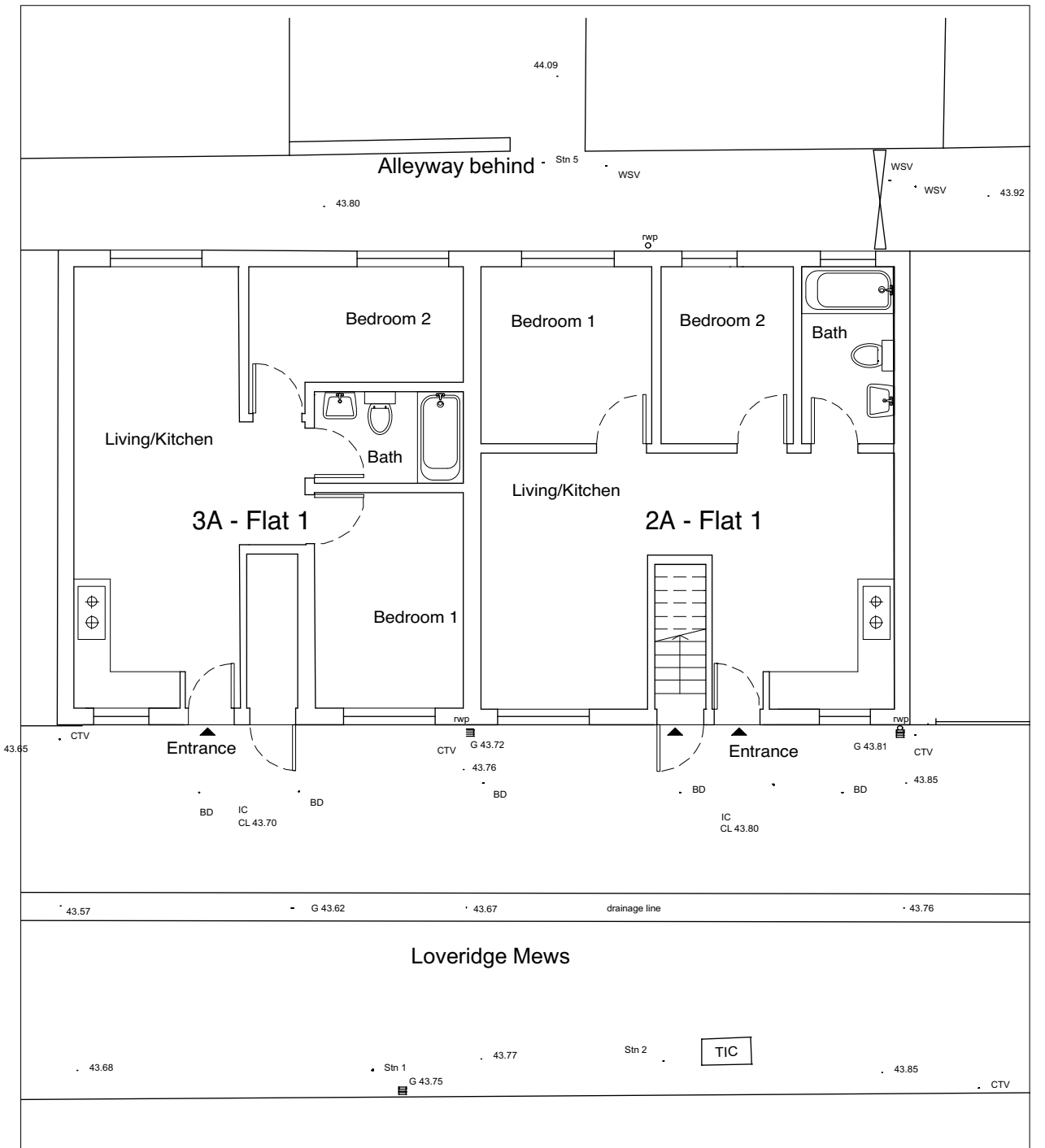

Proposed GF Plan
Scale 1:100

NB: All front external doors and windows retained as existing

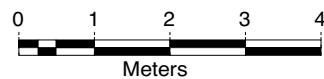

status	For Prior Approval Change of Use		Max Dewdney Architects a: 5th Floor 18 Broadwick Street London W1F 8HS e: maxdewdney@me.com m: 07967 698807	
revisions				
job			Prior Approval - Change of Use	
address			2/3A Loveridge Mews, London NW6 2DP	
dwg title			Existing & Proposed GF Plans	
scale		1:100	date	Aug 2016
LOV	150			
job reference	drawing number			revision