

New Entrance to be formed as part of the Summer 2016 enabling works – LBC request to put radius onto entrance to limit the numbers near the bus stop

Segregated Pedestrian Walkway for WES Pupils

Operative Pedestrian Access

SITE ENTRANCE

Proposed Location 1
Sept 2016 – Feb 2018
To serve LaSwap & Ribbon Construction

WES Car Entrance

1220mm High Hoarding

New Zebra Crossing

LA SWAP

Temporary Car Park
19 Spaces

Check condition of existing boundary fence – if it is not suffice, please allow for Green Leaf Printed Hoarding

Fencing & Gate to restrict access from compound to Site Works

No Car Parking during Construction Period

PHS TO ACCESS PHS TEMPORARY CAR PARK THROUGH WES ENTRANCE

Existing WES Gate

WES EXTENSION

Gate to only be utilised on Saturdays for WES Farmers Market

3D Image of WES Area

WES

WES COURTYARD

DINING HALL
NEW BUILD

MUGA PITCHES

MUGA PITCHES

HEATH BUILDING

PHS

RIBBON BUILDING

NB- Pinch Point from Boundary to Façade of Ribbon building – 6350mm

ROUTE FOR DEMOLITION OF COURTYARD

Lissenden Gardens

Lissenden Gardens

- Application Boundary
- Adjacent land owned by the applicant
- New Build
- Construction Traffic
- Client Traffic
- Areas of Demolition
- Site Compound
- Hoarding Line

DRAFT

PROPOSED SITE LOGISTICS PLAN – Time Frame 2: Sept 2016 – Feb/Mar 2018

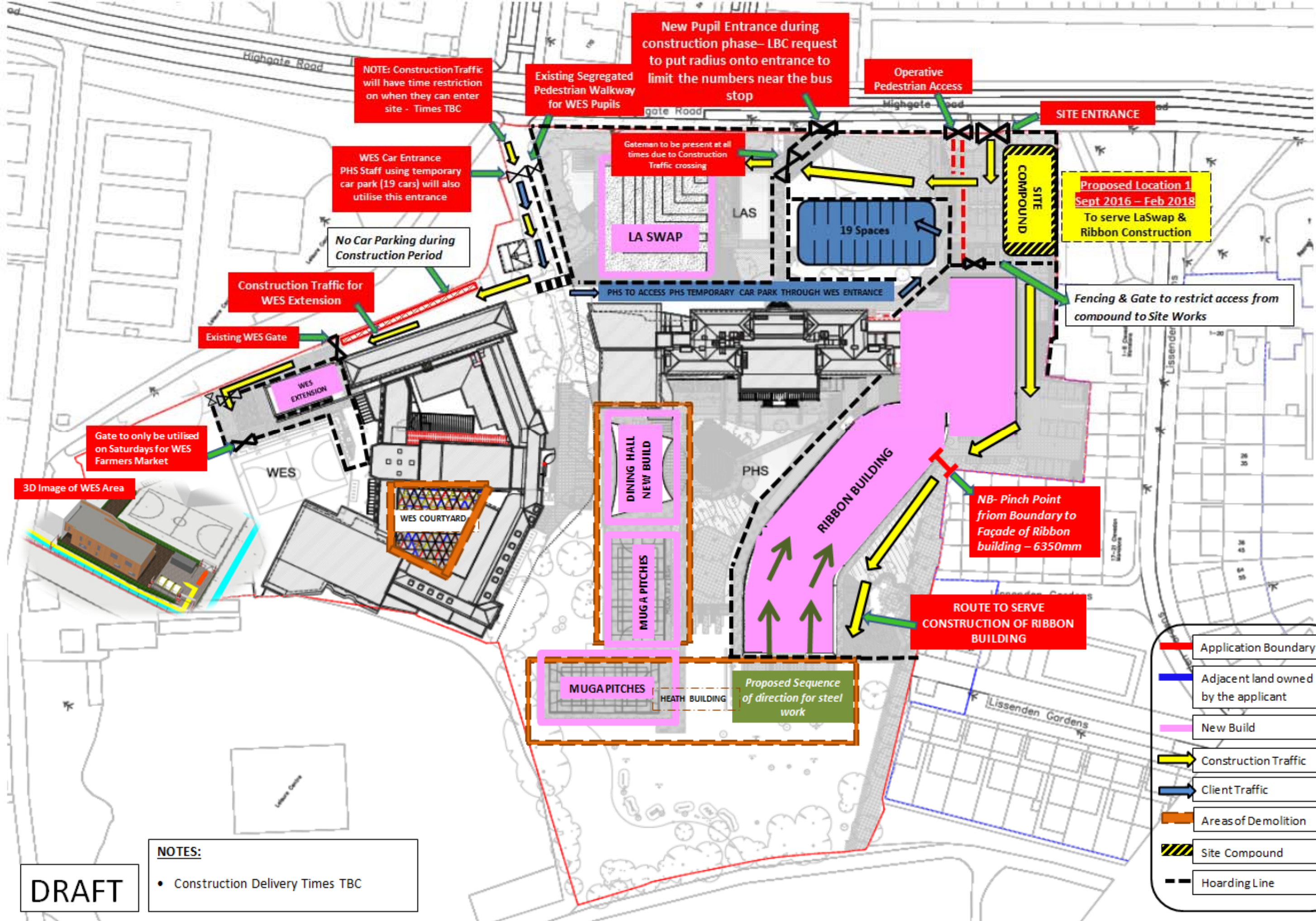

NOTE: Construction Traffic will have time restriction on when they can enter site - Times TBC

Existing Segregated Pedestrian Walkway for WES Pupils

New Pupil Entrance during construction phase- LBC request to put radius onto entrance to limit the numbers near the bus stop

Operative Pedestrian Access

SITE ENTRANCE

WES Car Entrance PHS Staff using temporary car park (19 cars) will also utilise this entrance

Gateman to be present at all times due to Construction Traffic crossing

Proposed Location 1 Sept 2016 – Feb 2018 To serve LaSwap & Ribbon Construction

No Car Parking during Construction Period

LA SWAP

19 Spaces

Fencing & Gate to restrict access from compound to Site Works

Construction Traffic for WES Extension

PHS TO ACCESS PHS TEMPORARY CAR PARK THROUGH WES ENTRANCE

Existing WES Gate

Gate to only be utilised on Saturdays for WES Farmers Market

3D Image of WES Area

WES

WES COURTYARD

DINING HALL NEW BUILD

PHS

RIBBON BUILDING

NB- Pinch Point from Boundary to Façade of Ribbon building – 6350mm

MUGA PITCHES

ROUTE TO SERVE CONSTRUCTION OF RIBBON BUILDING

MUGA PITCHES

HEATH BUILDING

Proposed Sequence of direction for steel work

- Application Boundary
- Adjacent land owned by the applicant
- New Build
- Construction Traffic
- Client Traffic
- Areas of Demolition
- Site Compound
- Hoarding Line

NOTES:

- Construction Delivery Times TBC

DRAFT

PROPOSED SITE LOGISTICS PLAN – Time Frame 3: Mar 2018 – Completion 2018

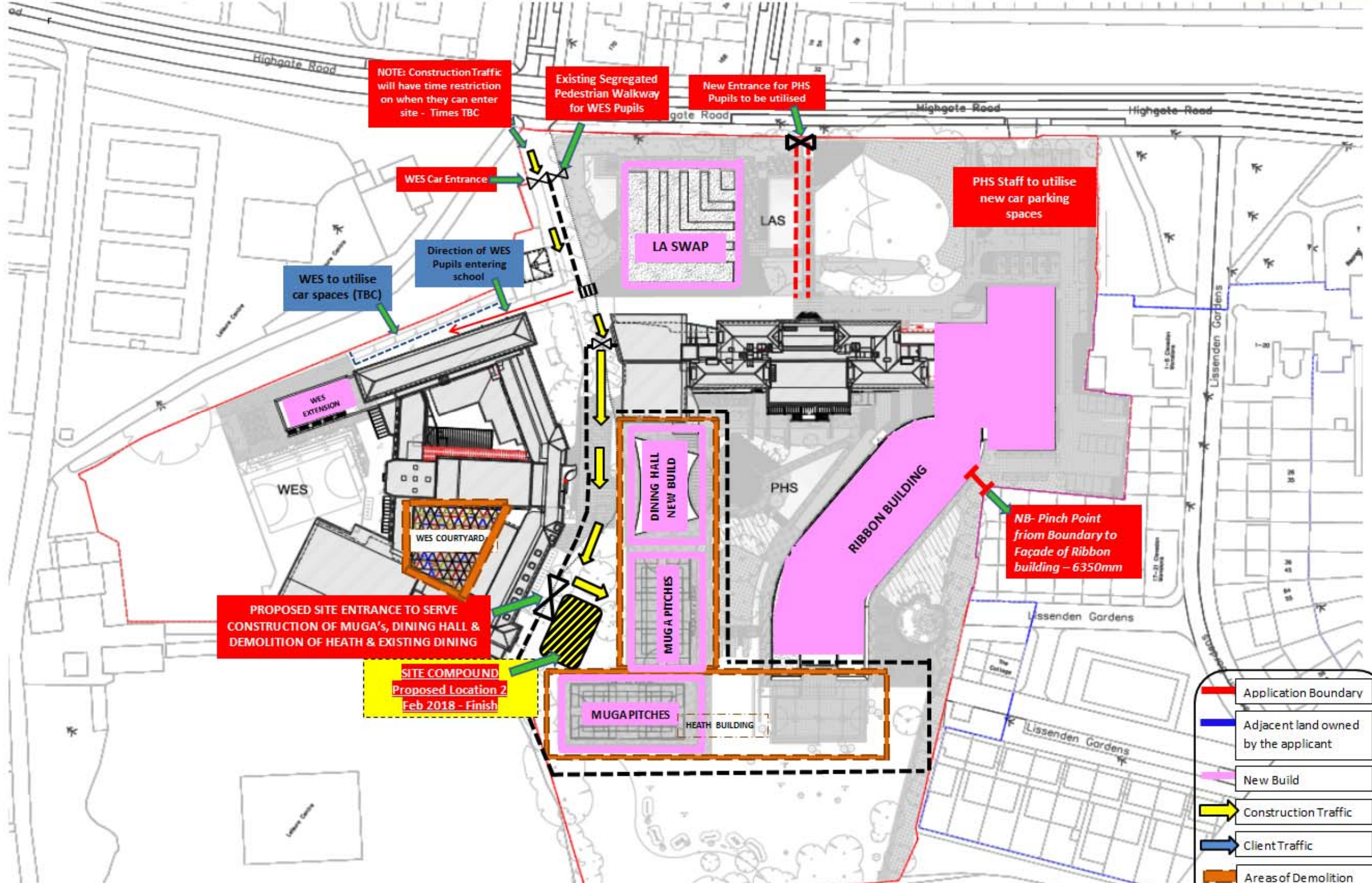

NOTE: Construction Traffic will have time restriction on when they can enter site - Times TBC

Existing Segregated Pedestrian Walkway for WES Pupils

New Entrance for PHS Pupils to be utilised

PHS Staff to utilise new car parking spaces

WES to utilise car spaces (TBC)

Direction of WES Pupils entering school

LA SWAP

WES EXTENSION

WES

WES COURTYARD

PROPOSED SITE ENTRANCE TO SERVE CONSTRUCTION OF MUGA's, DINING HALL & DEMOLITION OF HEATH & EXISTING DINING

SITE COMPOUND Proposed Location 2 Feb 2018 - Finish

DINING HALL NEW BUILD

MUGA PITCHES

MUGA PITCHES

HEATH BUILDING

PHS

RIBBON BUILDING

NB- Pinch Point from Boundary to Façade of Ribbon building – 6350mm

Lissenden Gardens

Lissenden Gardens

Lissenden Gardens

Application Boundary

Adjacent land owned by the applicant

New Build

Construction Traffic

Client Traffic

Areas of Demolition

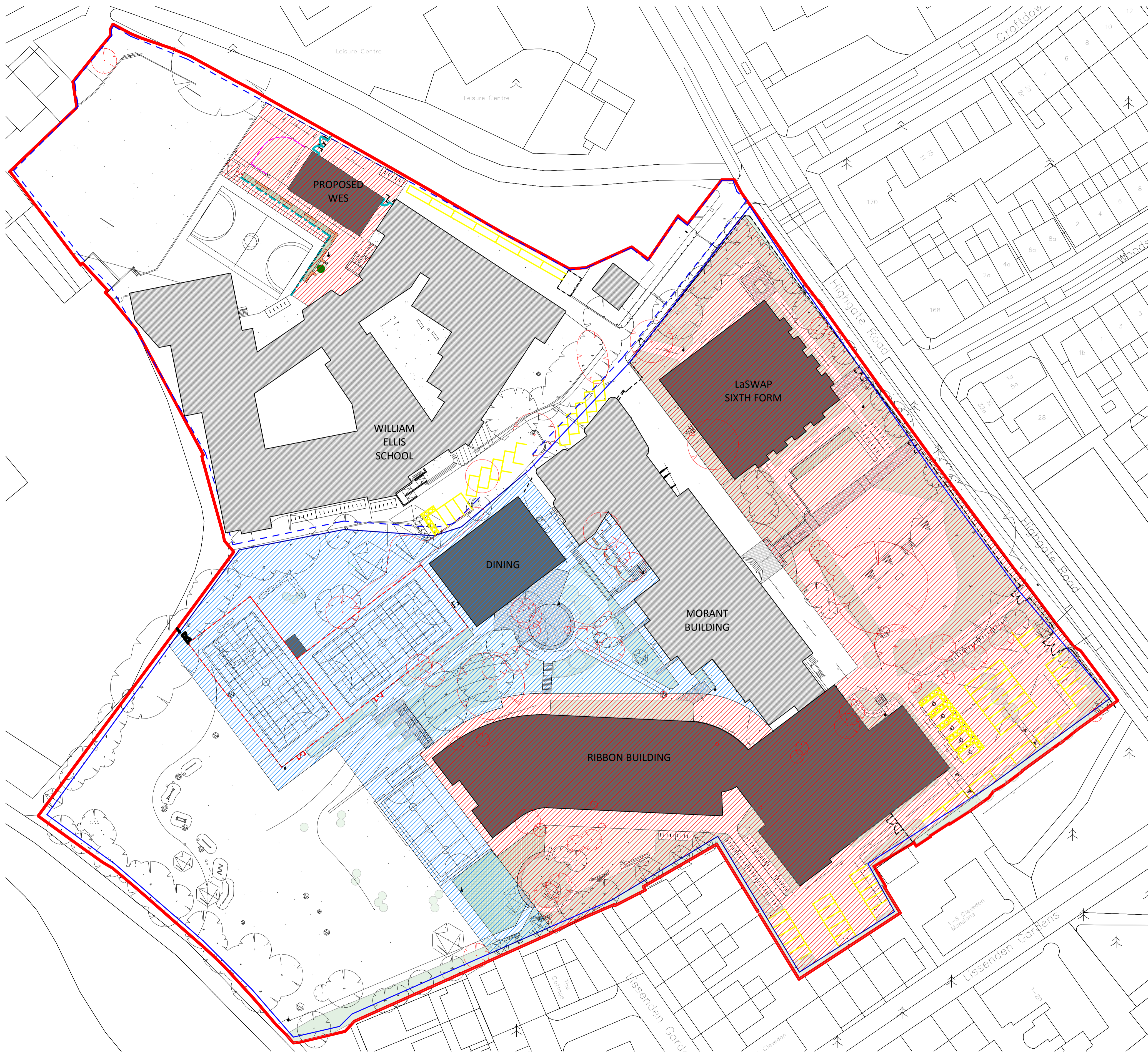

KEY:

- Phase 1 (October 2016 - February 2018)
- Phase 2 (May 2018 - December 2018)

Do not scale from this drawing for construction or acquisition purposes. Responsibility is not accepted for errors made by others in scaling from this drawing. All construction information must be taken from figured dimensions only. All dimensions and levels must be checked on site and discrepancies between drawings and specification must be reported to GSSArchitecture.
© Copyright GSSArchitecture

Ordnance Survey © Crown Copyright 2015. All rights reserved.
Licence number GSS 100017356.
Map Data Copyright 2015 Google.

Rev.	Date	Drawn	Check	Description

GSSarchitecture

35 HEADLANDS, KETTERING, NORTHANTS, NN15 7ES
Telephone: 01536 513 165, Fax: 01536 410 226
Email: gss@gotch.co.uk, Web: www.gssarchitecture.com

Gloucester: 01452 525 019, Harrogate: 01423 815 121

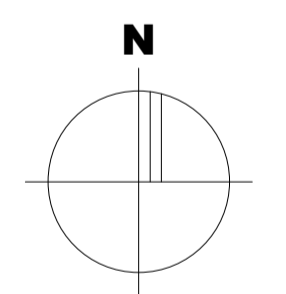

Project Title:
Parliament Hill School, William Ellis School and LaSWAP Sixth Form

Client:
Farrans

Drawing Title:
Phasing Plan

File Number: SCH284

Drawn By: FS

Checked By: BFLA

Scale@A1: 1 : 500 **Date:** 22/06/2016

Dwg No: (90)000 **Rev:**

1. Proposed Phasing Plan
SCALE - 1 : 500@A1

SITE DEMOLITION OVERVIEW



WES COURTYARD BUILDING

EXTERNAL STORES & IMMEDIATE AREA OF EXTENSION

HEATH BUILDING

PVC COVERED WALKWAY

DINING HALL

OCTAGON BUILDING

COURTYARD BUILDING & MORANT LINK

FENCING, BREAKOUT WALLS & STEPS FOR LASWAP CONSTRUCTION

DRAMA/ EXAM HUTS

GYM

CARETAKERS HOUSE

- Phase 1 Demolitions August/Sept 2016
- Phase 2 - July 2017 Demolitions
- Phase 3 - Early 2018 Demolitions