

**Plant Schedule**

Trees					
Number	Species	Girth	Height	Specification	Density
8 No.	Malus sylvestris	14-16cm	400-450cm	Extra Heavy Standard :Clear Stem 175-200 :5 brks :3x :RB	Counted
5 No.	Sorbus aria	14-16cm	400-450cm	Extra Heavy Standard :Clear Stem 175-200 :5 brks :3x :RB	Counted
7 No.	Crataegus monogyna	14-16cm	400-450cm	Extra Heavy Standard :Clear Stem 175-200 :5 brks :3x :RB	Counted
4 No.	Crataegus laevigata 'Paul's Scarlet'	20-25cm	500-550cm	Semi-Mature :Clear Stem min. 200 :3x :RB	Counted
1049 No.	Carpinus betulus		100-125cm	1+2 :Feather :RB	0.4Ctr Double Staggered at 0.3m offset
8 No.	Olea europaea	20-25cm	250-300cm	Clear Stem 125-150 :C	Counted
39 No.	Tilia cordata 'Greenspire'	25-30cm	550-600cm	Semi-Mature :Clear Stem min. 200 :5x :RB	Counted
15 No.	Zelkova serrata	25-30cm	550-600cm	4x :Semi-mature, clear stem minimum 200cm :RB	Counted
16 No.	Prunus avium 'Plena'	20-25cm	550-600cm	Semi-Mature :Clear Stem min. 200 :3x :RB	Counted
10 No.	Betula pendula		550-600cm	Multi-Stemmed :3 stems :4x :RB	Counted
1 No.	Prunus yedoensis	20-25cm	min. 450cm	3x :Semi-mature, clear stem minimum 200cm :RB	Counted
<b>Total :1162 No.</b>					

**Shrubs**

Number	Species	Pot Size	Height	Specification	Density
337 No.	Skimmia confusa 'Kew Green'	5L	30-40cm	Bushy :3 brks :C	4/m <sup>2</sup>
26 No.	Mahonia media 'Charity'		100-125cm	Bushy :3 brks :RB :Specimen	Counted
52 No.	Cornus mas 'Elegantissima'	5L	30-40cm	Branched :3 brks :C	4/m <sup>2</sup>
6 No.	Prunus spinosa		175-200cm	1+2 :Transplant :Branched :4 brks :RB	Counted
7 No.	Ilex aquifolium		175-200cm	Leader with laterals :RB	Counted
12 No.	Amelanchier lamarckii		300-350cm	3x :Multi-stem: bushy: 5 stems minimum :RB	Counted
350 No.	Buxus sempervirens		60-80cm	Bushy :5 brks :RB	0.4Ctr Double Staggered at 0.3m offset
188 No.	Ligustrum ovalifolium		80-100cm	Bushy :7 brks :RB	0.4Ctr Double Staggered at 0.3m offset
45 No.	Prunus laurocerasus 'Zabeliana'	5L	40-60cm	Bushy :3 brks :C	3/m <sup>2</sup>
215 No.	Lavandula angustifolia 'Munstead'	5L	20-30cm	Bushy :7 brks :C	4/m <sup>2</sup>
16 No.	Phormium 'Sundowner'	25L	60-80cm	Triple crown : Specimen	Counted
76 No.	Lonicera nitida 'Majgrün'	5L	30-40cm	Bushy :3 brks :C	4/m <sup>2</sup>
3 No.	Hydrangea arborescens 'Annabelle'	10L	60-80cm	Branched :7 brks :C : Specimen	Counted
342 No.	Hydrangea paniculata 'Limelight'	5L	40-60cm	Branched :5 brks :C	0.4Ctr Double Staggered at 0.3m offset
20 No.	Viburnum davidii	3L	30-40cm	Bushy :3 brks :C	4/m <sup>2</sup>
67 No.	Mahonia aquifolium	3L	30-40cm	Branched :3 brks :C	4/m <sup>2</sup>
<b>Total :1762 No.</b>					

**Herbaceous**

Number	Species	Pot Size	Specification	Density
82 No.	Bergenia 'Silberlicht'	3L	Full Pot	7/m <sup>2</sup>
128 No.	Anemone hybrida 'Honorine Jobert'	3L	Full Pot	5/m <sup>2</sup>
35 No.	Luzula nivea	3L	Full Pot	5/m <sup>2</sup>
469 No.	Liriope muscari 'Munro White'	3L	Full Pot	0.4Ctr Double Staggered at 0.25m offset
57 No.	Tiarella cordifolia	3L	Full Pot	5/m <sup>2</sup>
151 No.	Kniphofia uvaria	5L	Full Pot	4/m <sup>2</sup>
24 No.	Rudbeckia 'Goldsturm'	3L	Full Pot	5/m <sup>2</sup>
36 No.	Achillea 'Terracotta'	3L	Full Pot	5/m <sup>2</sup>
54 No.	Nepeta 'Six Hills Giant'	3L	Full Pot	5/m <sup>2</sup>
58 No.	Verbena bonariensis	5L	Full Pot	0.4Ctr
82 No.	Crococsmia 'Lucifer'	3L	Full Pot	5/m <sup>2</sup>
20 No.	Iris foetidissima	5L	Full Pot	Counted
<b>Total :1196 No.</b>				

**Climbers**

Number	Species	Pot Size	Height	Specification	Density
6 No.	Hedera canariensis	10L	100-150cm	Several Shoots : :5 brks :Caned	Counted
6 No.	Clematis montana	10L	100-150cm	Several Shoots : :5 brks :Caned	Counted
4 No.	Hedera helix	10L	100-150cm	Several Shoots : :5 brks :Caned	Counted
5 No.	Lonicera periclymenum	10L	100-150cm	Several Shoots : :5 brks :Caned	Counted
4 No.	Parthenocissus tricuspidata	10L	100-150cm	Several Shoots : :5 brks :Caned	Counted
<b>Total :25 No.</b>					

**Bulbs**

Number	Species	Specification	Density
60 No.	Hyacinthoides non-scripta	Grade 6/+	7/m <sup>2</sup>
363 No.	Narcissus pseudonarcissus	Grade 6/+	7/m <sup>2</sup>
<b>Total :423 No.</b>			

**Ferns**

Number	Species	Pot Size	Specification	Density
35 No.	Asplenium scolopendrium	3L	Full Pot	5/m <sup>2</sup>
<b>Total :35 No.</b>				

**Grasses**

Number	Species	Pot Size	Specification	Density
58 No.	Anemanthele lessoniana	3L	Full Pot	5/m <sup>2</sup>
260 No.	Miscanthus sinensis 'Gracillimus'	5L	Full Pot :C	4/m <sup>2</sup>
88 No.	Calamagrostis brachytricha	5-7.5L	Full Pot	4/m <sup>2</sup>
42 No.	Stipa tenuissima	3L	Full Pot	5/m <sup>2</sup>
25 No.	Hakonechloa macra 'Albo aurea'	5L	Full Pot	4/m <sup>2</sup>
29 No.	Miscanthus sinensis 'Kleine Fontäne'	5L	Full Pot :C	4/m <sup>2</sup>
40 No.	carex buchananii	3L	Full Pot	5/m <sup>2</sup>
<b>Total :542 No.</b>				

**Southern Boundary Native Planting Mix**

Trees					
Number	Species	Girth	Height	Specification	Density
287 No.	Crataegus monogyna		80-100cm	1+2 :Transplant :3/4 brks :BR	0.4Ctr Double Staggered at 0.35m offset
<b>Total :287 No.</b>					

**Shrubs**

Number	Species	Pot Size	Height	Specification	Density
115 No.	Corylus avellana		80-100cm	1+2 :Transplant :3/4 brks :BR	0.4Ctr Double Staggered at 0.35m offset
86 No.	Ilex aquifolium		80-100cm	1+2 :Transplant :3/4 brks :BR	0.4Ctr Double Staggered at 0.35m offset
86 No.	Prunus spinosa		80-100cm	1+2 :Transplant :3/4 brks :BR	0.4Ctr Double Staggered at 0.35m offset
37 No.	Rhamnus cathartica	40-60cm		1+1 :Transplant :Branched :2 brks :BR	3/m <sup>2</sup>
37 No.	Rhamnus frangula	40-60cm		1+1 :Transplant :Branched :2 brks :BR	3/m <sup>2</sup>
207 No.	Rosa canina	40-60cm		1+1 :Transplant :Branched :2 brks :BR	3/m <sup>2</sup>
37 No.	Rubus fruticosus	40-60cm		0/1 :Cutting; branched; 2 breaks :BR	3/m <sup>2</sup>
173 No.	Sambucus nigra	40-60cm		1+1 :Transplant :Branched :2 brks :BR	3/m <sup>2</sup>
207 No.	Viburnum opulus	40-60cm		1+1 :Transplant :Branched :2 brks :BR	3/m <sup>2</sup>
<b>Total :985 No.</b>					

**Trees in highways boundary**

Trees					
Number	Species	Girth	Height	Specification	Density
13 No.	Acer platanoides 'Columnare'	25-30cm	550-600cm	4x :Semi-mature; clear stem minimum 200cm	Counted
<b>Total :13 No.</b>					

**notes**

- The contractor is responsible for checking dimensions, tolerances and references. Any discrepancy to be verified with the Architect before proceeding with the works.
- Where an item is covered by drawings to different scales the larger scale drawing is to be worked to.
- Do not scale drawing. Figured dimensions to be worked to in all cases.

**CDM Regulations 2007**

ALL current drawings and specifications for the project must be read in conjunction with the Designer's Hazard and Environmental Assessment Record.

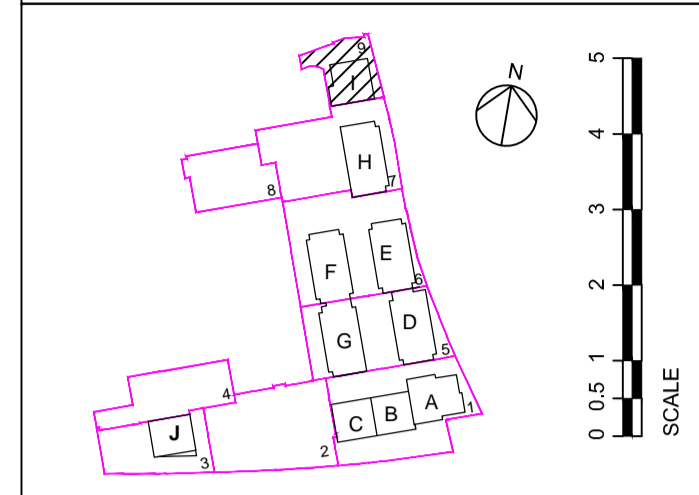

- Turf
- Medallion® turf by Rolawn or similar approved
- Wildflower turf
- Wildflower Landscape Turf by Wildflowerturf or similar approved
- Wildflower turf for shady area
- Premium (Hillier) Wildflower turf by Wildflowerturf or similar approved
- Proposed trees
- Existing tree retained
- Existing tree root protection zone
- Climber

date	rev	revision/author/checker
03.12.15	D	Updated schedule and 'Ferns' and 'Grasses' sections added. MG/HS
17.03.15	C	issued for GA correction.HS
24.10.14	B	CONSTRUCTION ISSUE
02.05.14	A	General amendments to planting plan and schedule
03.04.14	-	First issue for DT Co-ordination & Comment

purpose of issue	
CONSTRUCTION	
project	
MAIDEN LANE	
drawing	
EXTERNAL WORKS: PLANTING PLAN 9 BLOCK I	

drawing no	rev
AA1692C/3.1/238	D
drawn	checked
PW	AJ
scale @ A1	date
1/100	APR 2014