

notes

- The contractor is responsible for checking dimensions, tolerances and references. Any discrepancy to be verified with the Architect before proceeding with the works.
- Where an item is covered by drawings to different scales the larger scale drawing is to be worked to.
- Do not scale drawing. Figured dimensions to be worked to in all cases.

CDM Regulations 2007

ALL current drawings and specifications for the project must be read in conjunction with the Designer's Hazard and Environmental Assessment Record.

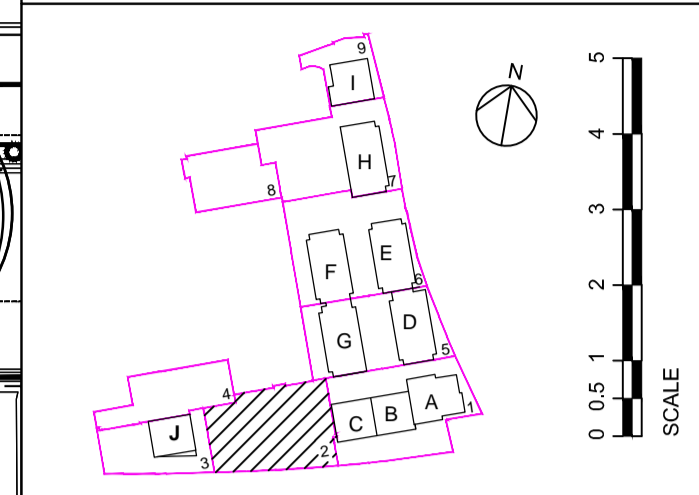

**Turf**  
 Medallion® turf by Rolawn or similar approved

**Wildflower turf**  
 Wildflower Landscape Turf by Wildflower turf or similar approved

- Proposed trees
- Existing tree retained
- Existing tree root protection zone
- Climber

21.07.16	E	Planting added behind existing building as compensation for removal of existing trees. Issued for planning amendment HS
06.07.16	D	Retaining wall omitted to south west of Block B HS
17.03.15	C	Issued for QA correction HS
24.10.14	B	CONSTRUCTION Issue
02.05.14	A	General amendments to planting plan and schedule
03.04.14	-	First Issue for DT Co-ordination & Comment

date	rev	revision/author/checker
------	-----	-------------------------

purpose of issue  
**PLANNING**

project  
**MAIDEN LANE**

drawing  
**EXTERNAL WORKS:  
 PLANTING PLAN 2  
 ALLENSBURY HOUSE**

drawing no	rev
<b>AA1692C/3.1/231</b>	<b>E</b>
drawn PW	checked AJ
scale @ A1 1/100	date APR 2014

Quantity	Species	Girth	Height	Specification
6	Betula pubescens	-	175-200cm high	Feathered trees, bushy, five breaks, Rootballed or container grown
2	Crataegus monogyna	14-16cm	400-450cm high	Extra heavy standard, clear stem, 5 breaks, 3x transplanted, rootballed
1	Ilex aquifolium	-	175-200cm high	Feathered trees, bushy, five breaks, Rootballed or container grown
6	Malus sylvestris	14-16cm	400-450cm high	Extra heavy standard, clear stem, 5 breaks, 3x transplanted, rootballed
6	Prunus spinosa	-	175-200cm high	Feathered trees, bushy, five breaks, Rootballed or container grown
2	Sorbus aria	14-16cm	400-450cm high	Extra heavy standard, clear stem, 5 breaks, 3x transplanted, rootballed

Wildflower and grass seed mixture for hedgerows  
 Emorsgate EHI hedgerow mixture or similar approved

PRP Architects ©  
 10 Lindsey Street  
 Smithfield  
 London  
 EC1A 9RP  
 T +44 (0)20 7653 1200  
 F +44 (0)20 7653 1201  
 lon.prp@prparchitects.co.uk