

28 A1	33m2	2mm thick marmoleum on underfloor heating system which includes a self leveling compound (by Nu-heat). Do not run underfloor heating pieps under fixed furniture
28 B2	3m2	Client supplied tile with ditramat decoupling layer to floor with under floor electric heating mat to shower room area only overlaid over wet room tanking system to floor and walls
33 D 28 C	1.5m2	Exterior Grade ceramic tiles with non-slip finish and new grating to existing linear drain (both client supply)
28 A2	7.5m2	Floor paint - light greycolor
19 B	2m2	area of additional liquid applied waterproofing to slab and 150 up the walls to prevent rising damp
28 A2	2.6m2	area of high strength sand cement screed to create a level base for appliances

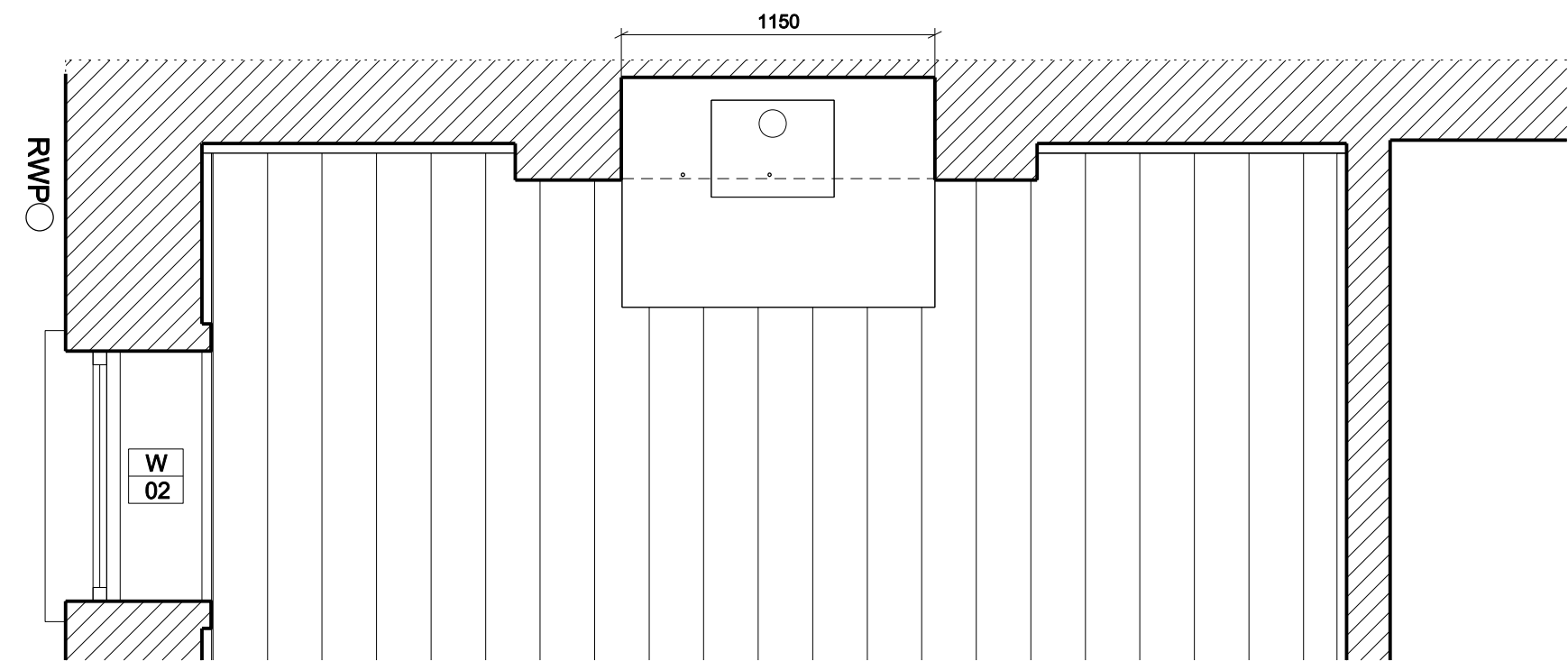

- 2mm vinyl
- leveling compound
- screed assumed
(sub floor to be photographed when covering is removed)

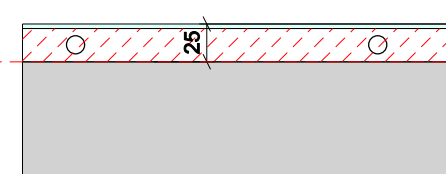

- Make good existing floor by removing any adhesive or defect that could cause the underfloor heating board not to sit perfectly flat
- install Nu heat low pro Max underfloor heating boards and pipes
- finish using the self leveling compound supplied with the UHF kit.
- Marmoleum sheet floor with tightly butted junctions between sheet edges to give an invisible join, as per the manufacturers recommendations

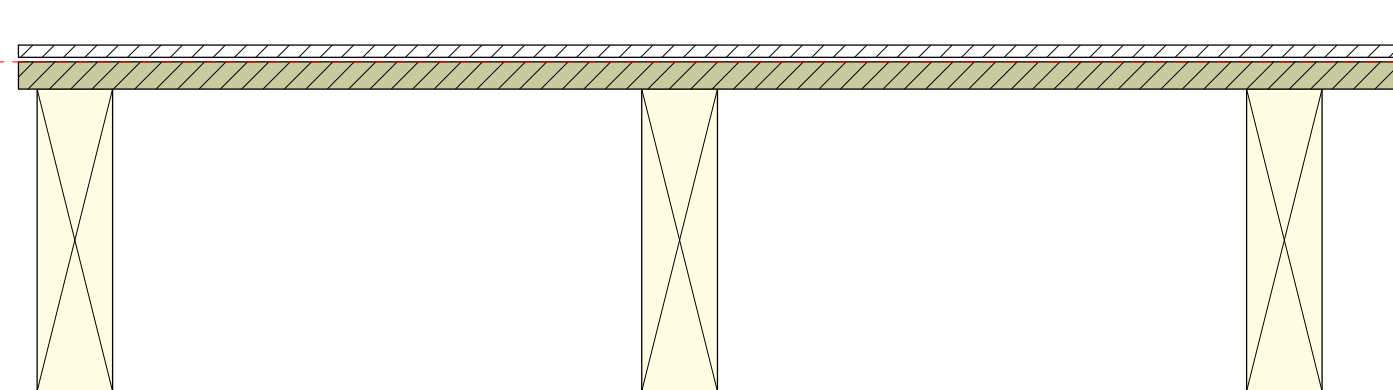

- tiles on adhesive bed
- Assumed 18mm plywood
- Assumed 200x50 joists

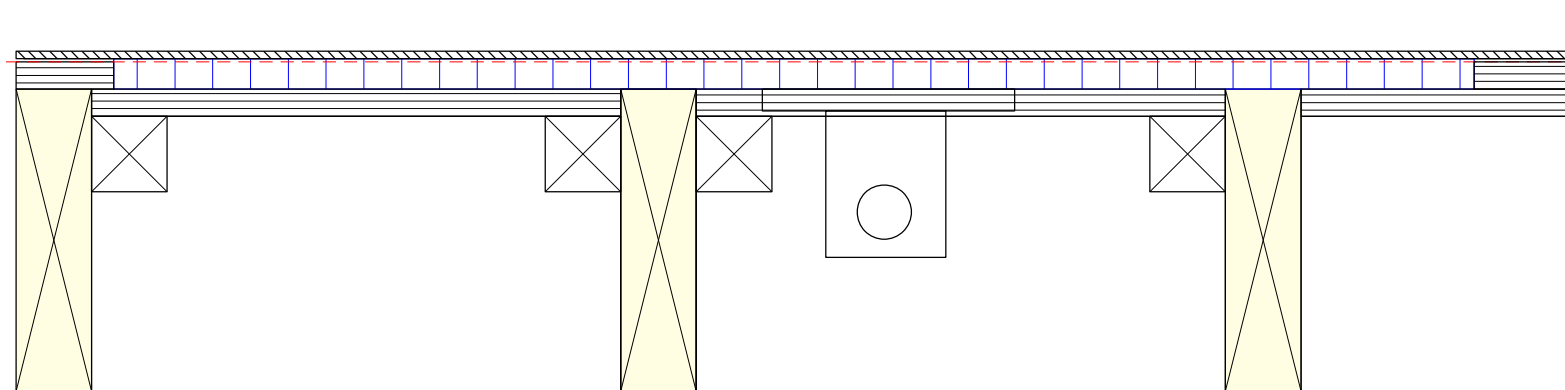

- tiles on adhesive bed with ditramat debonding layer and electric heating mat
- Wetroom tanking system
- 18mm WBO ply between joists

Project No.	15118
Purpose	TENDER
Client	Katharine Reid & Michael Crabtree
Scale	1:50 at A3 1:25 at A1
Date	April 2016
Project	17 Grove Terrace, London
Drawing Title:	Floor Finishes
Drawing No.	L-130
Rev.	-
Drawn	JG
Checked	JG

No implied license exists. This drawing should not be used to calculate areas for the purposes of valuation. All dimensions to be checked on site by the contractor and such dimensions to be their responsibility. Do not scale drawings. All work must comply with relevant British Standards and Building Regulations requirements. Drawing errors and omissions to be reported to the architect.

info@originstudio.co.uk
www.originstudio.co.uk