

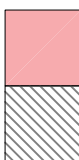

PROPOSED
Section B-B
SCALE 1/50@A3
PA-02

-  AS EXISTING / TBC
-  NEW 100mm PERIMETER BULKHEAD, CEILING HT. AS EXISTING
-  AREA OF EXISTING BULKHEAD TO BE RETAINED
-  ORIGINAL BEAMS TO BE RETAINED AS EXISTING AND EXPOSED

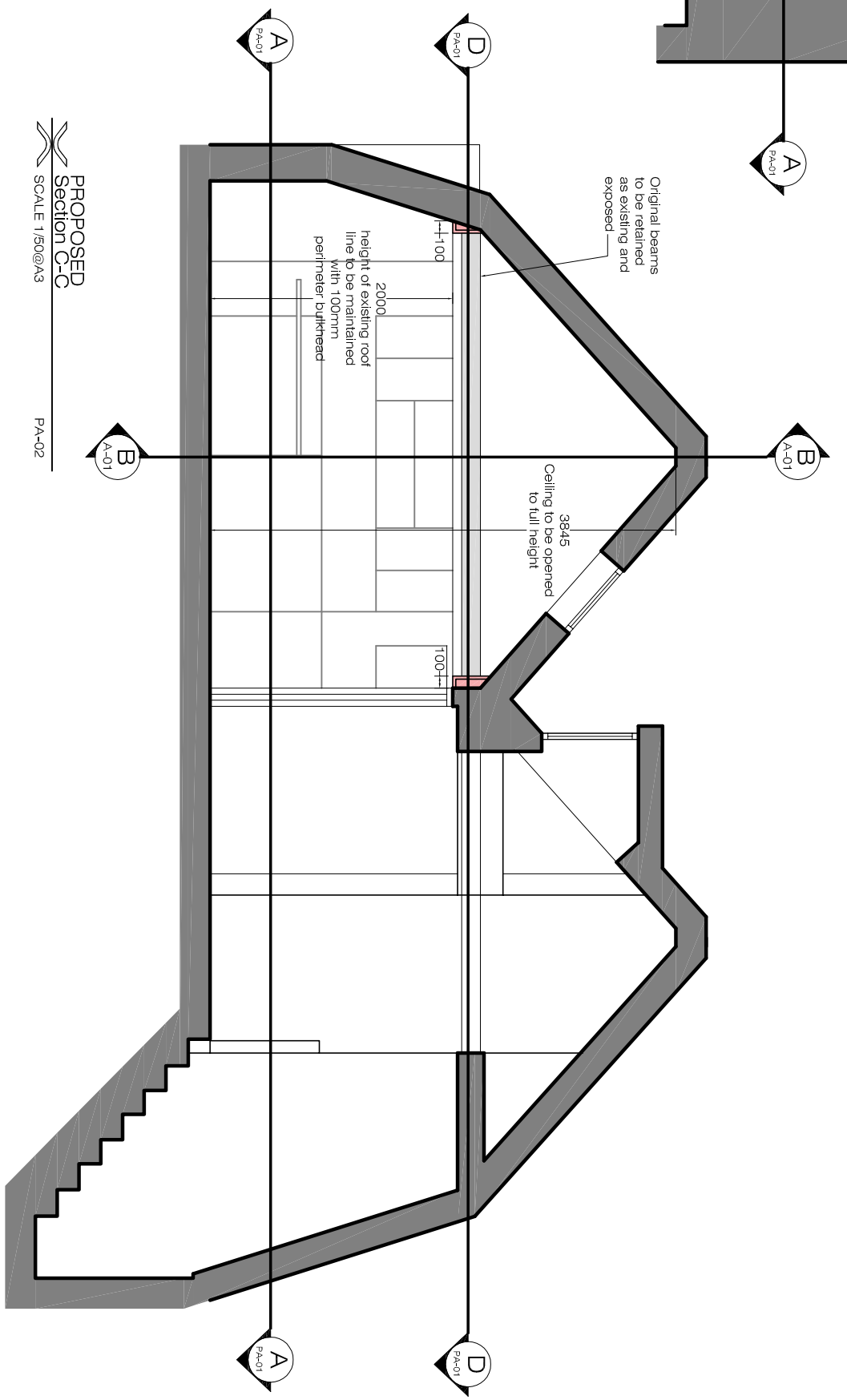

PROPOSED
Section C-C
SCALE 1/50@A3
PA-02

PLEASE NOTE:

1. ALL DIMENSIONS TO BE CHECKED ON SITE BEFORE FABRICATION.
2. CONTRACTOR TO REFER TO ENGINEERS DRAWINGS BEFORE PROCEEDING WITH WORKS.
3. ALL DRAWINGS AND DESIGNS ARE COVERED BY DESIGN RIGHT (INTELLECTUAL PROPERTY) AND MAY NOT BE DISTRIBUTED OR REPRODUCED WITHOUT WRITTEN PERMISSION OF THE ARCHITECT.
4. ALL DESIGN CONCEPTS ARE THE SOLE PROPERTY OF THE ARCHITECT AND NO ADAPTATIONS, REPRODUCTIONS OR COPIES MAY BE MADE WITHOUT WRITTEN PERMISSION OF THE ARCHITECT.
5. THESE DRAWINGS ARE SUBJECT TO ANY VARIATION REQUIRED OR RECOMMENDATION BY ANY STATUTORY AUTHORITY, OR FOR THE BETTER CARRYING OUT OF THE WORKS.
6. SAMPLES TO BE PROVIDED BY CONTRACTOR FOR THE ARCHITECT APPROVAL.
7. ALL FINISHES TO ARCHITECT SATISFACTION.
8. ALL DRAWINGS TO BE APPROVED BY THE ARCHITECT BEFORE CONSTRUCTION.

ADDITIONAL NOTES:

REVISIONS

No	Date	Description Issue For	Issue By
00	26/05/16	INFORMATION	AM

Client
PRIVATE CLIENT

Project
Flat 3, 30 Hampstead High Street
London, NW3

Title
**PROPOSED
Section B-B and Section C-C**

Scale 1/50@A3	Dwg. No. PA-02	Rev. 00
Date 26/05/16	Project Number 16_061	
Drawn AM	Checked SS	



Ground Floor Office
33 Belsize Lane
London NW3 5AS
Office: +44 (0) 207 431 9014
s.sandler@xularchitecture.co.uk
www.xularchitecture.co.uk